



OFFICE SPACE FOR LEASE

3430 Coates Industrial Blvd., Suite 100
Durham, NC

Aerial Video Link: <https://youtu.be/05RSgLURFNo>



FOR LEASE: \$15.00 PSF + Electric & Janitorial

SIZE: 5,872 SF office space

ZONING: EDE-1 (Economic Development Eno Lower Intensity)

DESCRIPTION: Come checkout this beautiful office space with an excellent layout. The space consists of seven large offices, three small offices, waiting room, break room, open office area for cubicles.

LOCATION: Conveniently located in Orange County off of Business 70 or Hillsborough Road in Durham NC, just minutes accessing I-85, 147, & 15-501.

PARKING: 15 spaces + overflow lot in the back of the building

For more information please contact:

Graham Storey graham@westandwoodall.com | Cell 919-698-8799

Visit us at PickettSprouse.com

**PICKETT
SPOUSE**

COMMERCIAL
REAL ESTATE



A WEST & WOODALL COMPANY

OFFICE SPACE FOR LEASE

3430 Coates Industrial Blvd., Suite 100

Durham, NC

FLOOR PLAN

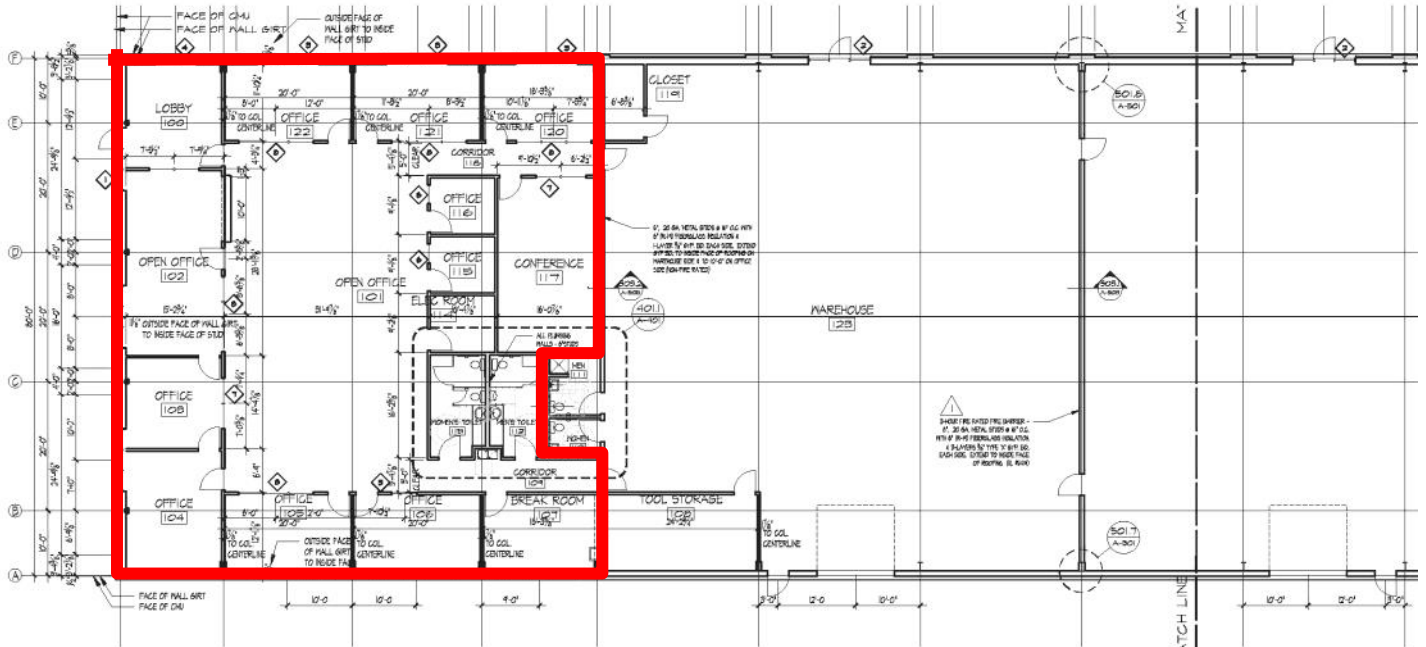

15

**Designated
Parking**

INFORMATION HEREIN IS SUBJECT TO VERIFICATION BY ALL PARTIES AND MAY CHANGE WITHOUT NOTICE.

1901 HILLANDALE ROAD, SUITE 100 • DURHAM, NC 27705 • 919.493.0395 • WWW.PICKETTSPOUSE.COM

**PICKETT
SPROUSE**

COMMERCIAL
REAL ESTATE



A WEST & WOODALL COMPANY

OFFICE SPACE FOR LEASE

3430 Coates Industrial Blvd., Suite 100
Durham, NC



INFORMATION HEREIN IS SUBJECT TO VERIFICATION BY ALL PARTIES AND MAY CHANGE WITHOUT NOTICE.

1901 HILLANDALE ROAD, SUITE 100 • DURHAM, NC 27705 • 919.493.0395 • WWW.PICKETTSPROUSE.COM

**PICKETT
SPOUSE**

COMMERCIAL
REAL ESTATE



A WEST & WOODALL COMPANY

OFFICE SPACE FOR LEASE

3430 Coates Industrial Blvd., Suite 100
Durham, NC



INFORMATION HEREIN IS SUBJECT TO VERIFICATION BY ALL PARTIES AND MAY CHANGE WITHOUT NOTICE.

1901 HILLANDALE ROAD, SUITE 100 • DURHAM, NC 27705 • 919.493.0395 • WWW.PICKETTSPROUSE.COM