

Orange County

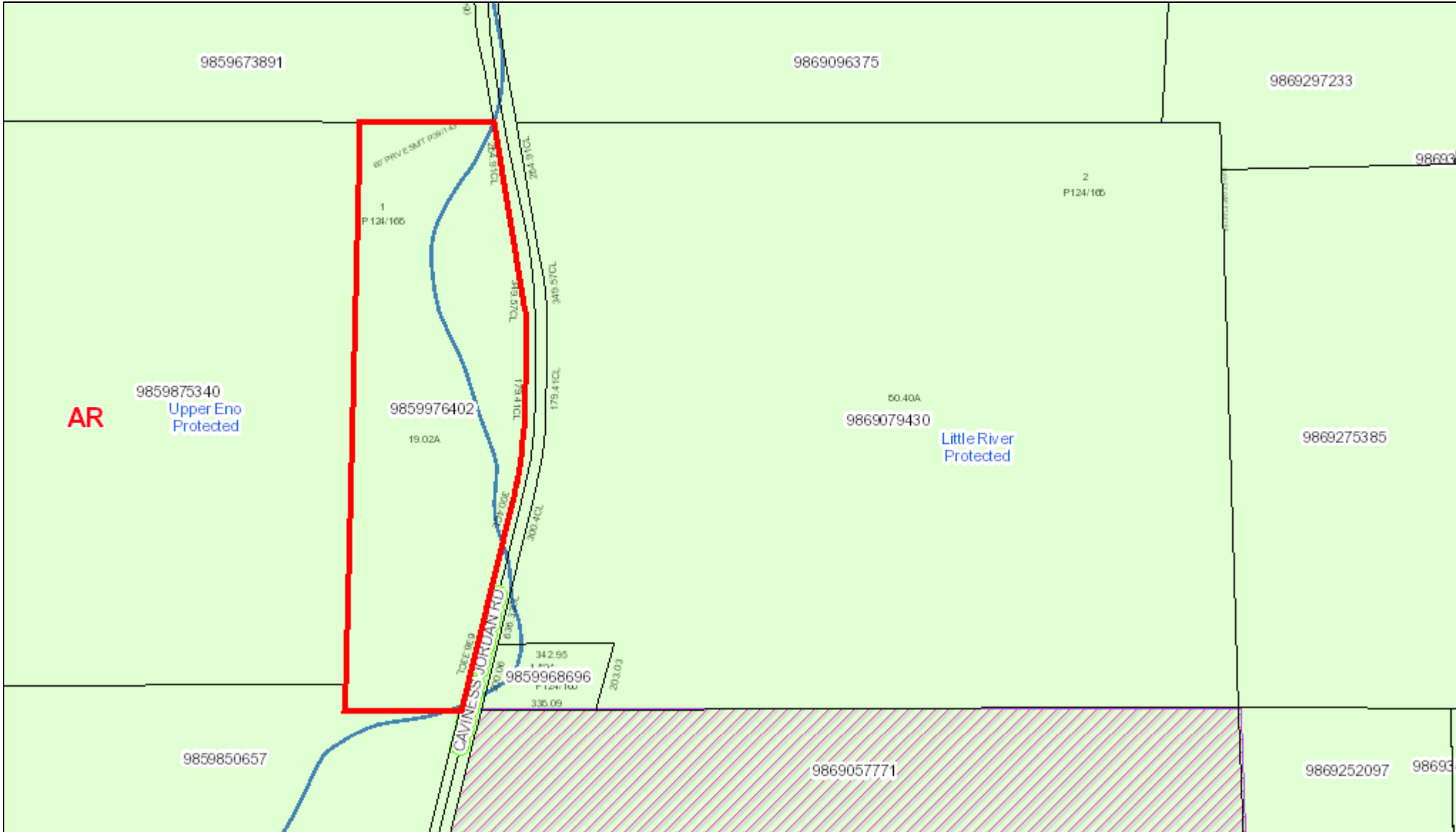

June 7, 2022

This map contains parcels prepared for the inventory of real property within Orange County, and is compiled from recorded deed, plats, and other public records and data. Users of this map are hereby notified that the aforementioned public primary information sources should be consulted for verification of the information contained on this map.

The county and its mapping companies assume no legal responsibility for the information on this map.

PIN: 9859976402

OWNER 1: POPE CLAUD T JR ETAL
 OWNER 2: WILLIAMS SUSAN P
 ADDRESS 1: 5807 EFLAND CEDAR GROVE RD
 ADDRESS 2:
 CITY: CEDAR GROVE
 STATE, ZIP: NC 272319717
 LEGAL DESC: 1 CLAUDE T POPE JR SUSAN P WILLIAMS &

SIZE: 19.02 A
 DEED REF:
 RATECODE: 16
 TOWNSHIP: CEDAR GROVE
 BLDG SQFT:
 YEAR BUILT:
 JOHN F POPE P124/168

BUILDING COUNT:
 LAND VALUE:
 BLDG_VALUE:
 USE_VALUE: \$0
 TOTAL VALUE:
 DATE SOLD: 04/07/2022
 TAX STAMPS:

