

BK CM 2006 PG. 397 A3

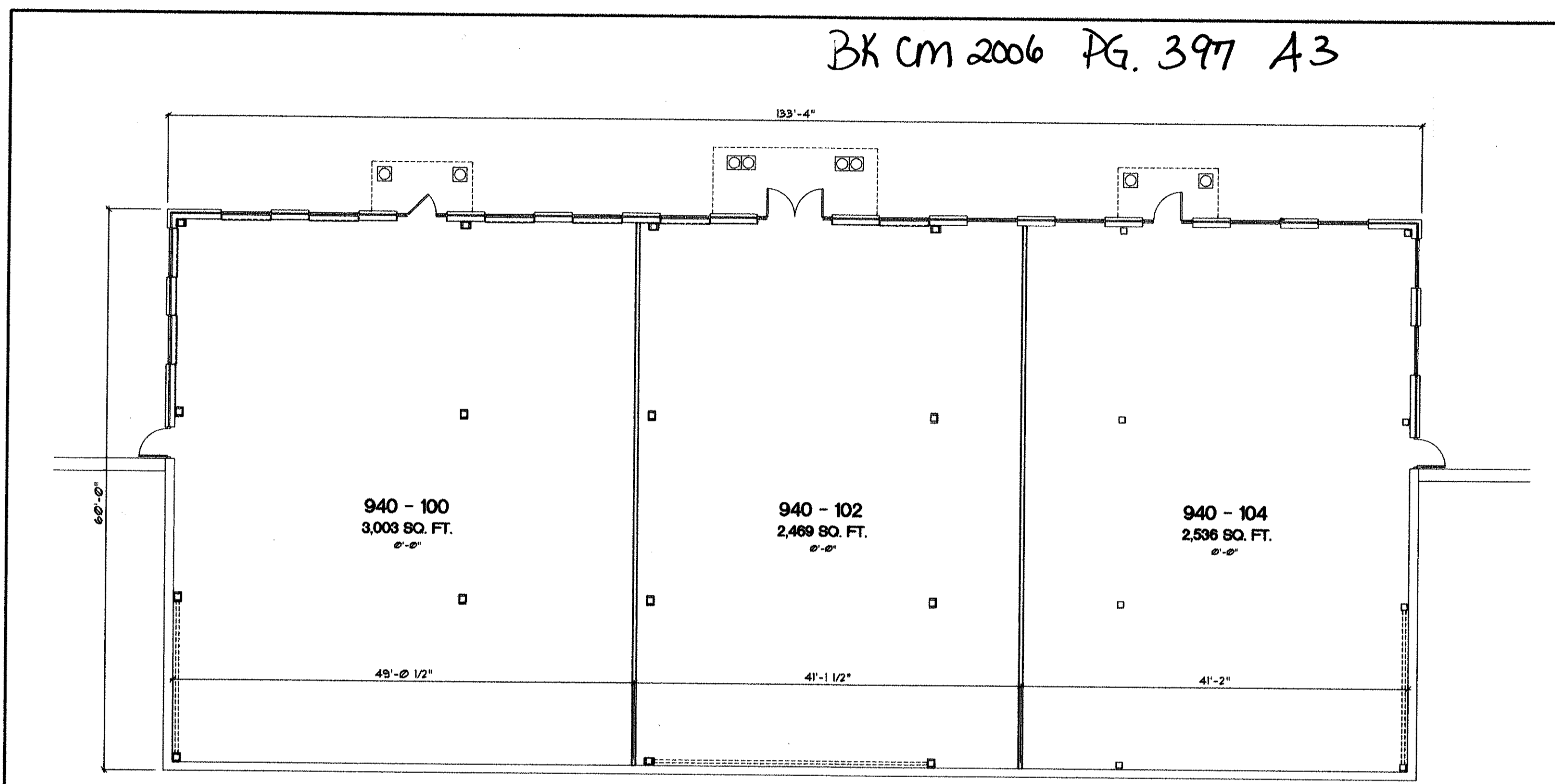

NOTES:
 1. EXTERIOR DIMENSIONS ARE TO THE FACE OF PRIMARY BRICK PLANE, EXCLUSIVE OF PROJECTED OR RECESSED FEATURES
 2. INTERIOR DIMENSIONS ARE TO THE CENTERLINE OF PARTITIONS.

I, A NOTARY PUBLIC OF WAKE COUNTY, NORTH CAROLINA, CERTIFY THAT THOMAS M. SHADON, A REGISTERED ARCHITECT, PERSONALLY APPEARED BEFORE ME THIS DAY AND ACKNOWLEDGED THE EXECUTION OF THE ADJACENT CERTIFICATION, WITNESS MY HAND AND OFFICIAL STAMP / SEAL THIS 1ST DAY OF DECEMBER, 2006.
Thomas A. Earls



I, THE UNDERSIGNED ARCHITECT, BEING LICENSED IN NORTH CAROLINA UNDER THE PROVISIONS OF CHAPTER 85A OF THE GENERAL STATUTES, HEREBY CERTIFY THAT THIS DRAWING ACCURATELY DEPICTS THE LAYOUT, CEILING AND FLOOR ELEVATIONS, UNIT NUMBERS AND DIMENSIONS OF THE UNITS, AS-BUILT, AND CONTAIN ALL INFORMATION REQUIRED BY NORTH CAROLINA GENERAL STATUTES 41C-2-109, PARAGRAPH (b) (6).
 DATE: 12-01-06
 SIGNATURE: *Thomas M. Shadon*

WAKE COUNTY, NC 351
 LAURA M RIDDICK
 REGISTER OF DEEDS
 PRESENTED & RECORDED ON
 12/06/2006 AT 14:02:10

01 LOWER LEVEL FLOOR PLAN
 SCALE: 3/32"=1'-0"



REVISION	BY

SHADON ASSOCIATES
 Architects Space Planners Interiors
 1145 EXECUTIVE CIRCLE, SUITE F, CARY, NC 27511
 919-286-0227



BUILDING ONE
 PARKWAY PROFESSIONAL PARK
 CONDOMINIUMS
 500 SE CARY PARKWAY
 CARY, NORTH CAROLINA

DVS
TMS
11/27/06
AS NOTED
1

Filed for Registration at 14:02:10 of clock PM
 12/16, 2006 and Registered in
 Office of the Register of Deeds of Wake County, North
 Carolina, in Cendo File 397, Page A3-A6
 12/6, 2006
 LAURAM. RIDDICK
 REGISTER OF DEEDS
Frank C. [Signature]
 ASST / DEPUTY