



Alamance County Government
TAX ADMINISTRATION RECORD SEARCH

Property Owner TIAN FENG GROUP LLC	Owner's Mailing Address 1615 CREIGHTON HALL WAY DURHAM , NC 27703	Property Location Address 421 ELLINGTON RD
--	--	--

Administrative Data Parcel ID No. 150960 OLD Tax ID 7-7-24E GPIN 8891016155 Owner ID 670844 Tax District 40 - ELI WHITNEY/87 SOUTH Land Use Code 10 Land Use Desc SINGLE FAMILY Neighborhood R4013	Administrative Data Legal Desc HBL 421 ELLINGTON RD Plat Bk/Pg /	Valuation Information Tax Value \$ 57,946 Tax Value - Land and all permanent improvements, if any, effective January 1, 2017, date of County's most recent General Reappraisal Assessed Value \$ 57,946 If Assessed Value does not equal Market Value, then the parcel may be in a tax deferral program, be split by the county line, or be overridden to match an alternative valuation approach.
---	---	---

Improvement Detail (1st Major Improvement on Subject Parcel)	
Year Built	1973
Built Use/Style	RANCH
Current Use	E / POOR QUALITY (E)
Grade	E / POOR QUALITY (E)
* Percent Complete	100
Heated Area (S/F)	1,288
Fireplace (Y/N)	N
Basement (Y/N)	N
** Bedroom(s)	2
** Bathroom(s)	1 Full Bath(s) 0 Half Bath(s)
*** Multiple Improvements	1
* Note - As of January 1 ** Note - Bathroom(s), Bedroom(s), shown for description only *** Note - If multiple improvements equal "MLT" then parcel includes additional major improvements	

Sales History 3 Previous Sales Found for Parcel number 150960				
Record Num	Date	Name	Book/Page	Sale Price
1	2023	TIAN FENG GROUP LLC	4323 / 0927	\$183,000.00
2	2018	ADAMS RENTALS LLC	3725 / 0942	\$22,000.00
3	1978	GRUMBLES JACKIE DEAN & NANCY F	430 / 58	\$0.00

Building Sketch

(Building 1) - Sketch for Parcel ID: **150960**

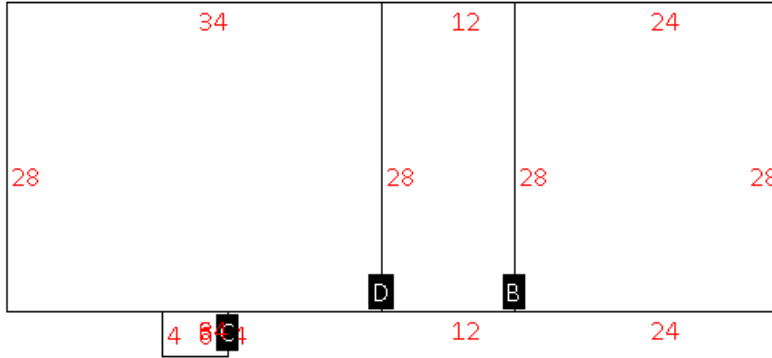

Label	Description	Base SF	Total SF
A	SITE BUILT	336.00	336.00
B	ENCLOSED PORCH, MASONRY	672.00	.00
C	STOOP	24.00	.00
D	SITE BUILT	952.00	952.00

Land Supplemental

Deeded Acres **1.5**
 Tax District Note **40 - ELI WHITNEY/87 SOUTH**
 Present-Use Info **SINGLE FAMILY**

Improvement Valuation (1st Major Improvement on Subject Parcel)

* Improvement Tax Value \$

** Improvement Assessed Value \$

27,558

* Note - Tax Value effective Date equal January 1, 2017, date of County's most recent General Reappraisal
 ** Note - If Assessed Value not equal Tax Value then variance resulting from formal appeal procedure

Land Value Detail (Effective Date January 1, 2017, date of County's most recent General Reappraisal)

Land Full Value (LFV) \$ **30,388** Land Present-Use Value (PUV) \$ ** **30,388** Land Total Assessed Value \$ **30,388**

** Note: If PUV equal LMV then parcel **has not** qualified for present use program