



**Alamance County Government**  
TAX ADMINISTRATION RECORD SEARCH

<b>Property Owner</b> KIVETT PLACE LLC	<b>Owner's Mailing Address</b> 1021 COOKS MILL RD MEBANE , NC 27302	<b>Property Location Address</b> 727 KIVETT ST
---	---	---

<b>Administrative Data</b> Parcel ID No. <b>126180</b> OLD Tax ID <b>84-362-91</b> GPIN <b>8865851763</b>  Owner ID <b>637248</b>  Tax District <b>12 - CITY OF BURLINGTON</b>  Land Use Code <b>431</b> Land Use Desc <b>OFFICE/APARTMENTS OVER</b>  Neighborhood <b>BC082</b>	<b>Administrative Data</b> Legal Desc <b>BL KIVETT ST LTS 90 91 PT LT 89</b>  Plat Bk/Pg <b>/</b>	<b>Valuation Information</b>  Tax Value \$ <b>154,787</b>  Tax Value - Land and all permanent improvements, if any, effective January 1, 2017, date of County's most recent General Reappraisal  <b>Assessed Value \$ 154,787</b>  If Assessed Value does not equal Market Value, then the parcel may be in a tax deferral program, be split by the county line, or be overridden to match an alternative valuation approach.
---	--	---

<b>Improvement Detail</b> (1st Major Improvement on Subject Parcel)	
Year Built	<b>1948</b>
Built Use/Style	<b>MIXED RES/COMM</b>
Current Use	<b>C / AVERAGE QUALITY (C)</b>
Grade	<b>C / AVERAGE QUALITY (C)</b>
* Percent Complete	<b>100</b>
Heated Area (S/F)	<b>4,800</b>
Fireplace (Y/N)	<b>N</b>
Basement (Y/N)	<b>N</b>
** Bedroom(s)	<b>0</b>
** Bathroom(s)	<b>0 Full Bath(s) 0 Half Bath(s)</b>
*** Multiple Improvements	<b>1</b>
* Note - As of January 1 ** Note - Bathroom(s), Bedroom(s), shown for description only *** Note - If multiple improvements equal "MLT" then parcel includes additional major improvements	

<b>Sales History</b> 3 Previous Sales Found for Parcel number 126180					
Record Num	Date	Name	Book/Page	Sale Price	
1	2014	KIVETT PLACE LLC	3217 / 0153	\$0.00	
2	2007	LYNCH ANDREW C & SHERYL S	2510 / 604	\$0.00	
3	2002	LYNCH ANDREW C & ETAL	1558 / 421	\$142,000.00	

**Building Sketch**

(Building 1) - Sketch for Parcel ID: **126180**

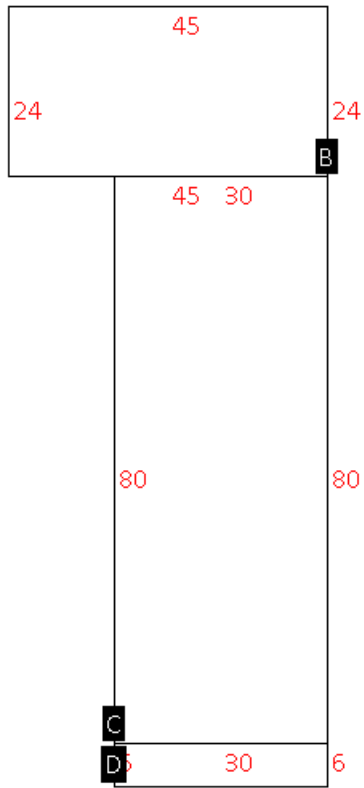

Label	Description	Base SF	Total SF
A	CANOPY ROOF/SLAB	180.00	.00
B	GARAGE-ATTACHED-FIN	1080.00	.00
C	RETAIL SINGLE OCCUP	2400.00	2400.00
D	RETAIL SINGLE OCCUP	2400.00	2400.00

**Land Supplemental**

Deeded Acres **0.27500000596**  
 Tax District Note **12 - CITY OF BURLINGTON**  
 Present-Use Info **OFFICE/APARTMENTS OVER**

**Improvement Valuation** (1st Major Improvement on Subject Parcel)

\* Improvement Tax Value \$

\*\* Improvement Assessed Value \$

**104,258**

\* Note - Tax Value effective Date equal January 1, 2017, date of County's most recent General Reappraisal  
 \*\* Note - If Assessed Value not equal Tax Value then variance resulting from formal appeal procedure

**Land Value Detail** (Effective Date January 1, 2017, date of County's most recent General Reappraisal)

Land Full Value (LFV) \$	Land Present-Use Value (PUV) \$ **	Land Total Assessed Value \$
<b>50,529</b>	<b>50,529</b>	<b>50,529</b>

\*\* Note: If PUV equal LMV then parcel **has not** qualified for present use program