

Orange County North Carolina

231967
708 MATTRESS FACTORY RD

JANUARY 1ST OWNER MAILING ADDRESS
ALLEN FAMILY PROPERTIES
PO BOX 586
NELLYSFORD VA 22958

Total Assessed Value
\$811,700

KEY INFORMATION

Tax Year	2022		
Parcel ID	9824796055	Township	3 - CHEEKS
Land Size	6.40	Land Units	AC
Rate Code	03		
District Codes	G0 County, FB Efland FD		
Property LUC	Industrials, Garages, Warehouses-Improved		
Neighborhood	K002 - 3CHEEKS IND		
Legal Description	E/S SR 1302 CKS TP (6.4 AC)		
Exempt Type	-		

APPRAISAL DETAILS

Total Land	\$228,800
Ag Credit	-
Land	\$228,800
Building	\$582,900
Yard Items	\$0
Market Total	\$811,700
Total Assessed	\$811,700

RESIDENTIAL

BUILDING (1)					
Type	Warehouse	Total Value	\$355,300	Finished Sq Ft	86,320 sf
Style	-	Quality	Grade D	Condition	Average
Year Built	1973	Exterior Walls		Full Bath	0
Roof Cover		Half Bath	0	HVAC	
Bedrooms	-	Garage Type			-

BUILDING (2)

MISC IMPROVEMENTS

IMPROVEMENT TYPE	UNITS/SQ FT	EST YEAR BUILT	APPRAISED VALUE
No items to display			

SALES

SALE DATE	SALE PRICE	DEED BOOK	DEED PAGE	INSTRUMENT TYPE	GRANTOR
No items to display					

YARD ITEMS

DESCRIPTION	TOTAL UNITS	YEAR BUILT	LENGTH	WIDTH	HEIGHT
No items to display					

LAND

UNIT / SOIL TYPE	DESCRIPTION	USE CODE	ACRES / LOTS	VALUE
L_AC	Industrial	SITE	6.4	\$228,800

VALUE HISTORY

YEAR	TOTAL MARKET VALUE
2022	\$811,700
2021	\$811,700
2020	\$778,000
2019	\$778,000
2018	\$778,000
2017	\$778,000
2016	\$1,204,600
2015	\$1,204,600
2014	\$1,852,877
2013	\$1,852,877
2012	\$1,852,877

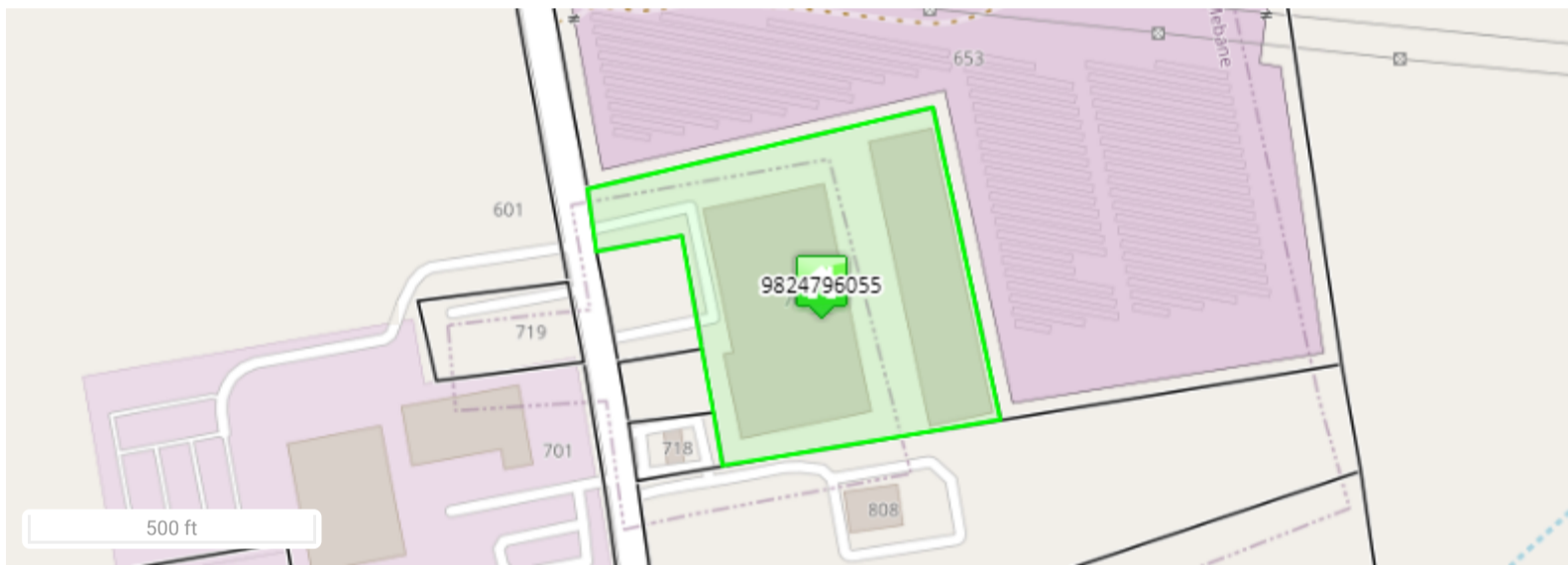

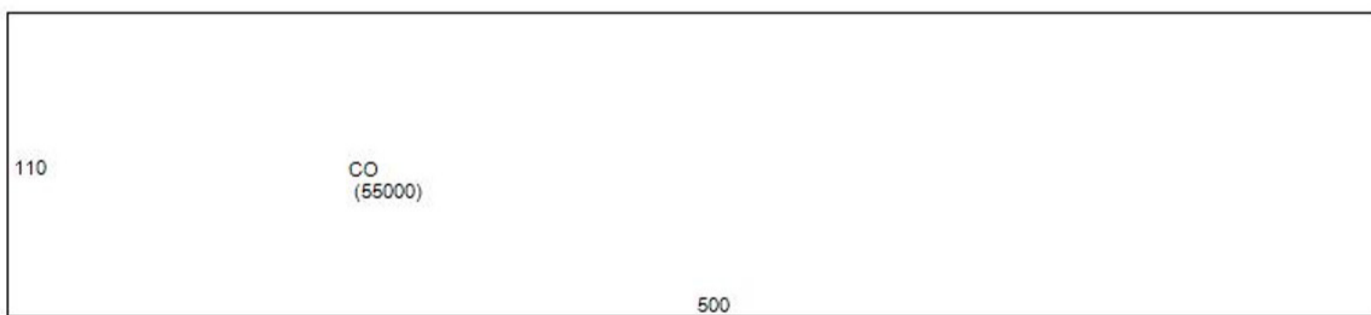
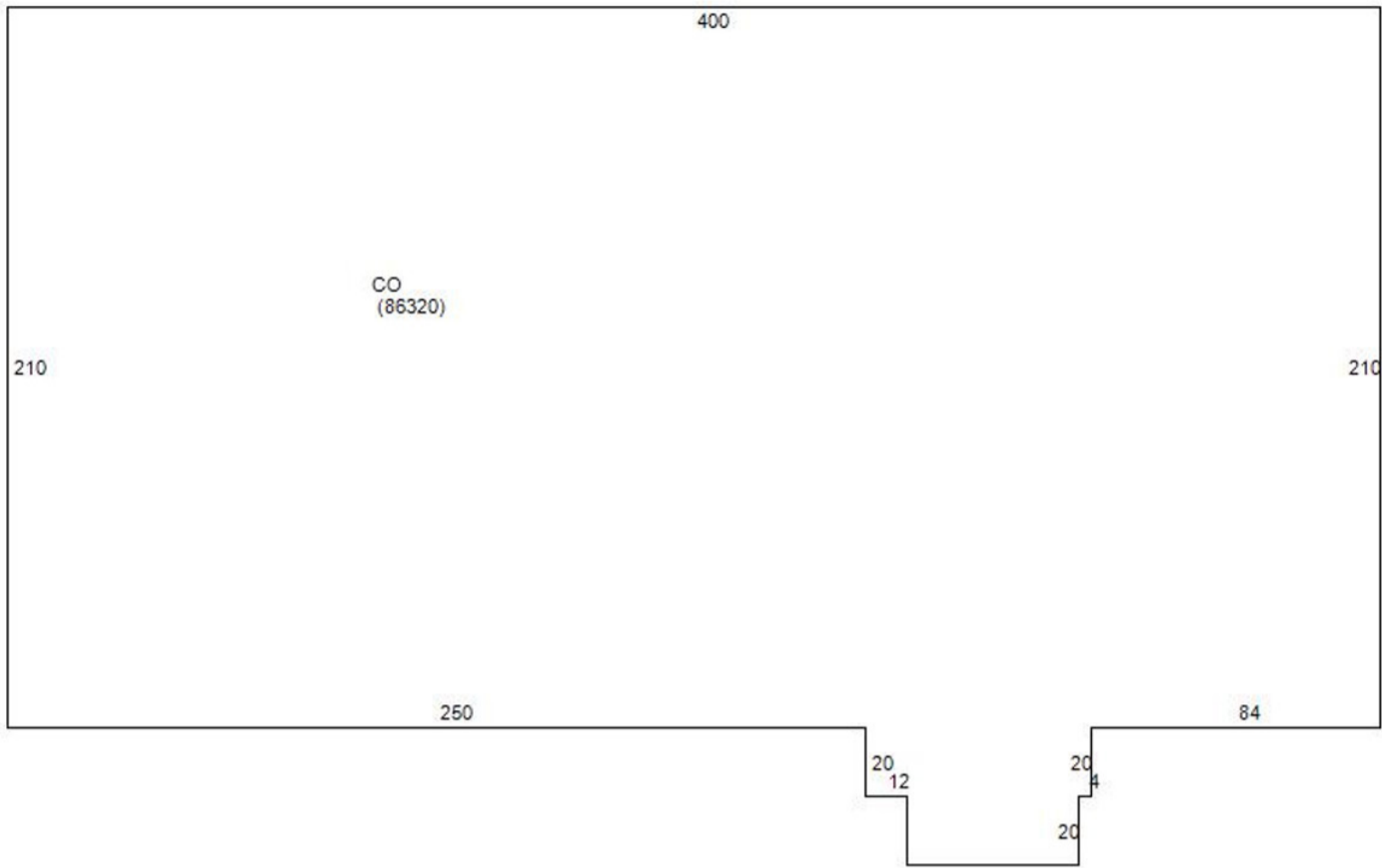

Orange County Assessor's Office makes every effort to produce the most accurate information possible. **No warranties, expressed or implied, are provided for the data herein, its use or interpretation.**