

# Unofficial Property Record Card - Orange County, NC

## General Property Data

Parcel ID **9788929919**  
Property Owner **ALDRSGATE METHODIST CHURCH**  
Mailing Address **632 LAUREL HILL ROAD**  
City **CHAPEL HILL**  
State **NC**  
Zipcode **27516**

Property Location **UNKNOWN**  
Property Use  
Most Recent Sale Date **12/29/2010**  
Legal Reference **158/530**  
Grantor  
Sale Price **0**  
Land Area **3.2 AC**

## Current Property Assessment

Card 1 Value	Building Value <b>616,600</b>	Other Features Value <b>0</b>	Land Value <b>754,500</b>	Total Value <b>1,371,100</b>
Total Parcel Value	Building Value <b>936,100</b>	Xtra Features Value <b>0</b>	Land Value <b>754,500</b>	Total Value <b>1,690,600</b>

## Building Description

Building Style <b>Church</b>	Foundation Type	Heating Type <b>N/A</b>
# of Living Units <b>0</b>	Roof Structure	Heating Fuel <b>N/A</b>
Year Built <b>1980</b>	Roof Cover	Air Conditioning <b>0%</b>
Finished Area (SF) <b>6119</b>	Siding	# of Bsmt Garages <b>0</b>
Full Baths <b>0</b>	1/2 Baths <b>0</b>	3/4 Baths <b>0</b>
# of Other Fixtures <b>0</b>		

## Legal Description

NW INT HWY 15-501 & LAUREL RD

## Narrative Description of Property

This property contains 3.2 AC of land mainly classified as with a(n) Church style building, built about 1980 , having a finished area of 6119 square feet, with exterior and roof cover, with 0 unit(s).

## Property Sketch

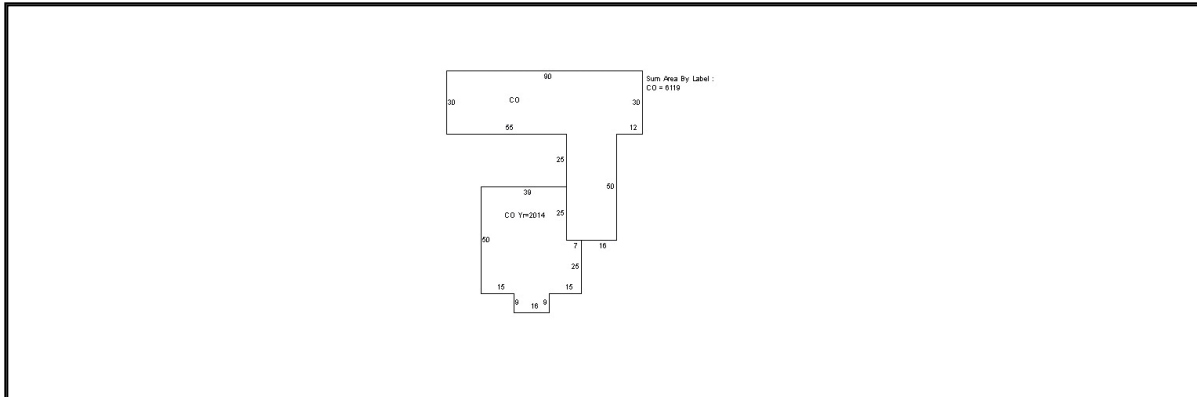

Disclaimer: This information is believed to be correct but is subject to change and is not warranted.