



Alamance County Government

TAX ADMINISTRATION RECORD SEARCH

Property Owner TIAN FENG GROUP LLC	Owner's Mailing Address 1615 CREIGHTON HALL WAY DURHAM , NC 27703	Property Location Address 550 SPENCE ST
--	--	---

Administrative Data Parcel ID No. 125892 OLD Tax ID 64-282-112 GPIN 8865793390 Owner ID 705655 Tax District 12 - CITY OF BURLINGTON Land Use Code 10 Land Use Desc SINGLE FAMILY Neighborhood 12137	Administrative Data Legal Desc SPENCE & POLK ST Plat Bk/Pg /	Valuation Information Tax Value \$ 49,479 Tax Value - Land and all permanent improvements, if any, effective January 1, 2017, date of County's most recent General Reappraisal Assessed Value \$ 49,479 If Assessed Value does not equal Market Value, then the parcel may be in a tax deferralment program, be split by the county line, or be overridden to match an alternative valuation approach.
--	---	---

Improvement Detail (1st Major Improvement on Subject Parcel)	
Year Built Built Use/Style Current Use Grade * Percent Complete Heated Area (S/F) Fireplace (Y/N) Basement (Y/N) ** Bedroom(s) ** Bathroom(s) *** Multiple Improvements	1949 CONTEMPORARY D / FAIR QUALITY (D) D / FAIR QUALITY (D) 100 1,008 N N 3 1 Full Bath(s) 0 Half Bath(s) 1
<small>* Note - As of January 1 ** Note - Bathroom(s), Bedroom(s), shown for description only *** Note - If multiple improvements equal "MLT" then parcel includes additional major improvements</small>	

Sales History 6 Previous Sales Found for Parcel number 125892					
Record Num	Date	Name	Book/Page	Sale Price	
1	2023	TIAN FENG GROUP LLC	4319 / 0214	\$40,000.00	
2	2022	AJ& W HOMES LLC	4212 / 0794	\$16,000.00	
3	2019	CRUMPTON CHERYL SHATTERLY	3212 / 0727	\$0.00	
4	2014	SHATTERLY GEORGE ALLAN III	3212 / 0727	\$0.00	
5	2007	AKINS JULIA AILENE SHATTERLY EXECUTOR &	250 / 306	\$0.00	
6	1991	SHATTERLY GEORGE A JR & STELLA	250 / 306	\$0.00	

Building Sketch

(Building 1) - Sketch for Parcel ID: **125892**

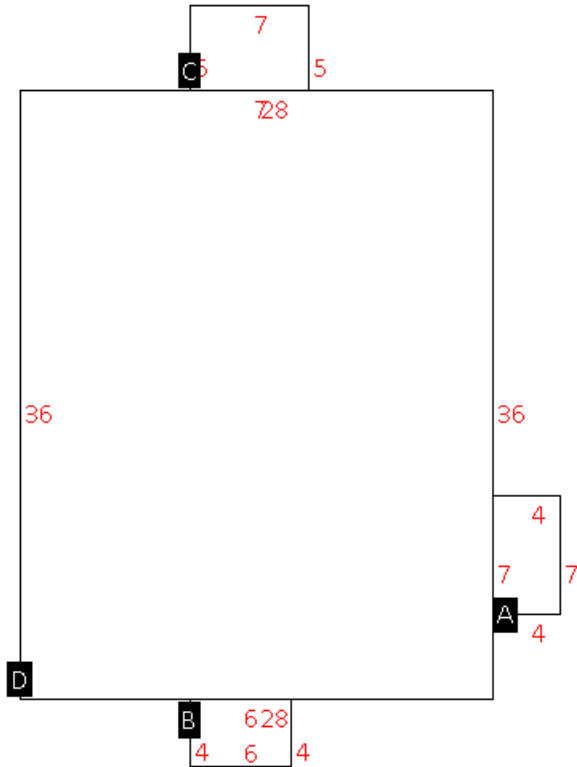

Label	Description	Base SF	Total SF
A	OPEN PORCH	28.00	.00
B	OPEN PORCH	24.00	.00
C	STOOP	35.00	.00
D	SITE BUILT	1008.00	1008.00

Land Supplemental

Deeded Acres **0**
 Tax District Note **12 - CITY OF BURLINGTON**
 Present-Use Info **SINGLE FAMILY**

Improvement Valuation (1st Major Improvement on Subject Parcel)

* Improvement Tax Value \$

** Improvement Assessed Value \$

29,479

* Note - Tax Value effective Date equal January 1, 2017, date of County's most recent General Reappraisal

** Note - If Assessed Value not equal Tax Value then variance resulting from formal appeal procedure

Land Value Detail (Effective Date January 1, 2017, date of County's most recent General Reappraisal)

Land Full Value (LFV) \$

Land Present-Use Value (PUV) \$ **

Land Total Assessed Value \$

20,000

20,000

20,000

** Note: If PUV equal LMV then parcel **has not** qualified for present use program