

DURHAM PROPERTY RECORD SEARCH

166177
5220 WAKE FOREST HWY

CURRENT GCAM DOGWOOD LLC
250 GIBALTAR RD
HORSHAM, PA, 19044

Total Assessed Value
\$837,470

KEY INFORMATION

Tax District	CNTY-DRHM/CITY-DRHM	PIN	0860-01-29-1462
Account	8659909	Neighborhood	R860A
Land Use Code	211	Land Use Desc	AG/ 1-FAMILY
Subdiv Code	0000	Subdiv Desc	N/A - NO SUBDIVISION
Deed Book & Page	008505 / 000680	Plat Book & Page:	008395 / 000997
Last Sale Date:	09/10/2018	Last Sale Price:	\$800,000
Jan 1st Owner:	MTS RAL LLC		
Legal Description:	PROP-TRIPLE E PROPERTIES/ TR#02		

ASSESSMENT DETAILS

Land Fair Market Value	\$596,812
Improvement Fair Market Value	\$240,658
Total Fair Market Value	\$837,470

RESIDENTIAL BUILDING (1)

Assessed Total Improvement Value **\$240,658**

Year Built:	1994	Built Use / Ranch	CONVENTIONAL
Current Use	RESIDENTIAL	Percent Complete:	100%
Heated Area (S/F):	2,167	Full Bathroom(s):	2
Half Bathroom(s):	0	Bedroom(s):	3
Fireplace (Y/N):	Y	Basement (Y/N):	N
Basement Unfinished:	375	Basement Finished:	-
Basement Partially Finished:	-	Attached Garage (Y/N):	N
Assessed Building Value:	\$240,658		

LAND DETAILS

Land Fair Market Value (FMV)	Land Assessed Value	Mapped Acres
\$596,812	\$596,812	14.915

SALES

Sales Date	Sale Price
09/10/2018	800,000

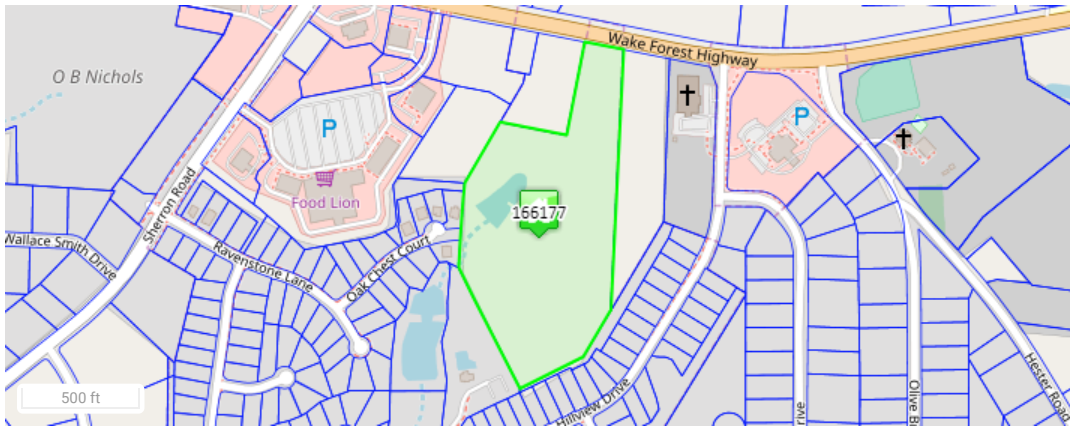

166177 12/21/2017

Disclaimer

Data Disclaimer: All data shown here is from other primary data sources and is public information. Users of this data are hereby notified that the aforementioned public information sources should be consulted for verification of the information contained on this website. **This site presents appraised value which may not represent taxable value.** While efforts have been made to use the most current and accurate data, Durham County, NC and Data Providers assume no legal responsibility for the use of the information contained herein.

Please direct any questions or comments about the data displayed here to tax_assessor@dcon.gov