

**Orange County North Carolina**

292949  
5026 US 70 W

**JANUARY 1ST OWNER MAILING ADDRESS**  
MCCOYS TEMPLE UNITED HOLY CHURCH  
INC  
PO BOX 428  
EFLAND NC 27243

Total Assessed Value  
**\$183,400**

**KEY INFORMATION**

Tax Year	<b>2022</b>		
Parcel ID	<b>9844083922</b>	Township	<b>3 - CHEEKS</b>
Land Size	<b>2.00</b>	Land Units	<b>AC</b>
Rate Code	<b>03</b>		
District Codes	<b>FB Efland FD, G0 County</b>		
Property LUC	<b>Residential- Improved</b>		
Neighborhood	<b>3005 - 3RICHMND</b>		
Legal Description	<b>#4 ENOCH &amp; MCCULLEY HWY 70</b>		
Exempt Type	<b>-</b>		

**APPRAISAL DETAILS**

Total Land	<b>\$37,700</b>
Ag Credit	<b>-</b>
Land	<b>\$37,700</b>
Building	<b>\$142,700</b>
Yard Items	<b>\$3,000</b>
Market Total	<b>\$183,400</b>
Total Assessed	<b>\$183,400</b>

**RESIDENTIAL**

<b>BUILDING (1)</b>					
Type	<b>Ofc-Conv Res</b>	Total Value	<b>\$142,700</b>	Finished Sq Ft	<b>2,025 sf</b>
Style	<b>-</b>	Quality	<b>Grade C</b>	Condition	<b>Average</b>
Year Built	<b>2000</b>	Exterior Walls	<b>Frame</b>	Full Bath	<b>2</b>
Roof Cover	<b>Shingle</b>	Half Bath	<b>0</b>	HVAC	
Bedrooms	<b>4</b>	Garage Type	<b>-</b>		

**MISC IMPROVEMENTS**

<b>IMPROVEMENT TYPE</b>	<b>UNITS/SQ FT</b>	<b>EST YEAR BUILT</b>	<b>APPRAISED VALUE</b>
WORKSHOP	1	-	\$3,000

**SALES**

<b>SALE DATE</b>	<b>SALE PRICE</b>	<b>DEED BOOK</b>	<b>DEED PAGE</b>	<b>INSTRUMENT TYPE</b>	<b>GRANTOR</b>
07/20/2006	\$136,000	4082	312		TATE
07/20/2006	\$136,000	4082	312		TATE OCTAVIS L
06/01/1974	\$0	249	1758		-

**YARD ITEMS**

DESCRIPTION	TOTAL UNITS	YEAR BUILT	LENGTH	WIDTH	HEIGHT
-------------	-------------	------------	--------	-------	--------

No items to display

## LAND

UNIT / SOIL TYPE	DESCRIPTION	USE CODE	ACRES / LOTS	VALUE
A	Homesite A	SITE	1	\$4,000
AC_9	Acres Type 9	SITE	2	\$33,700

## VALUE HISTORY

YEAR	TOTAL MARKET VALUE
2022	\$183,400
2021	\$183,400
2020	\$185,400
2019	\$185,400
2018	\$185,400
2017	\$185,500
2016	\$183,800
2015	\$183,800
2014	\$183,800
2013	\$183,800
2012	\$183,800

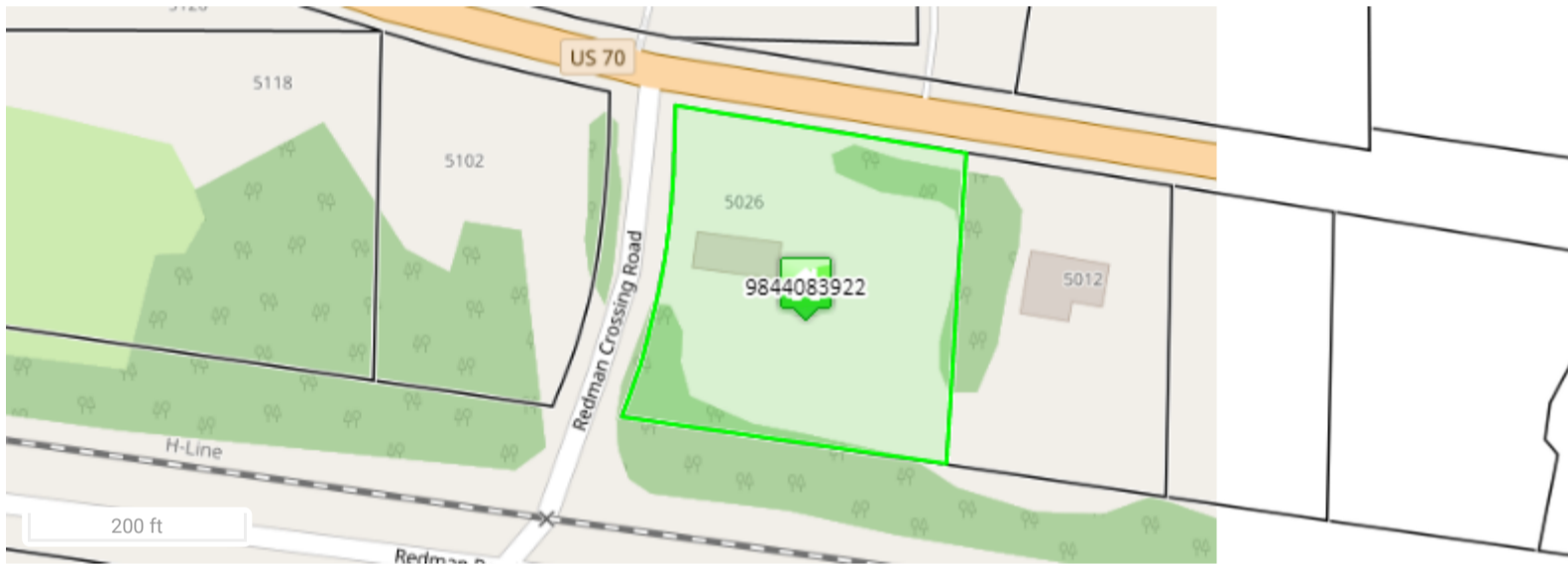

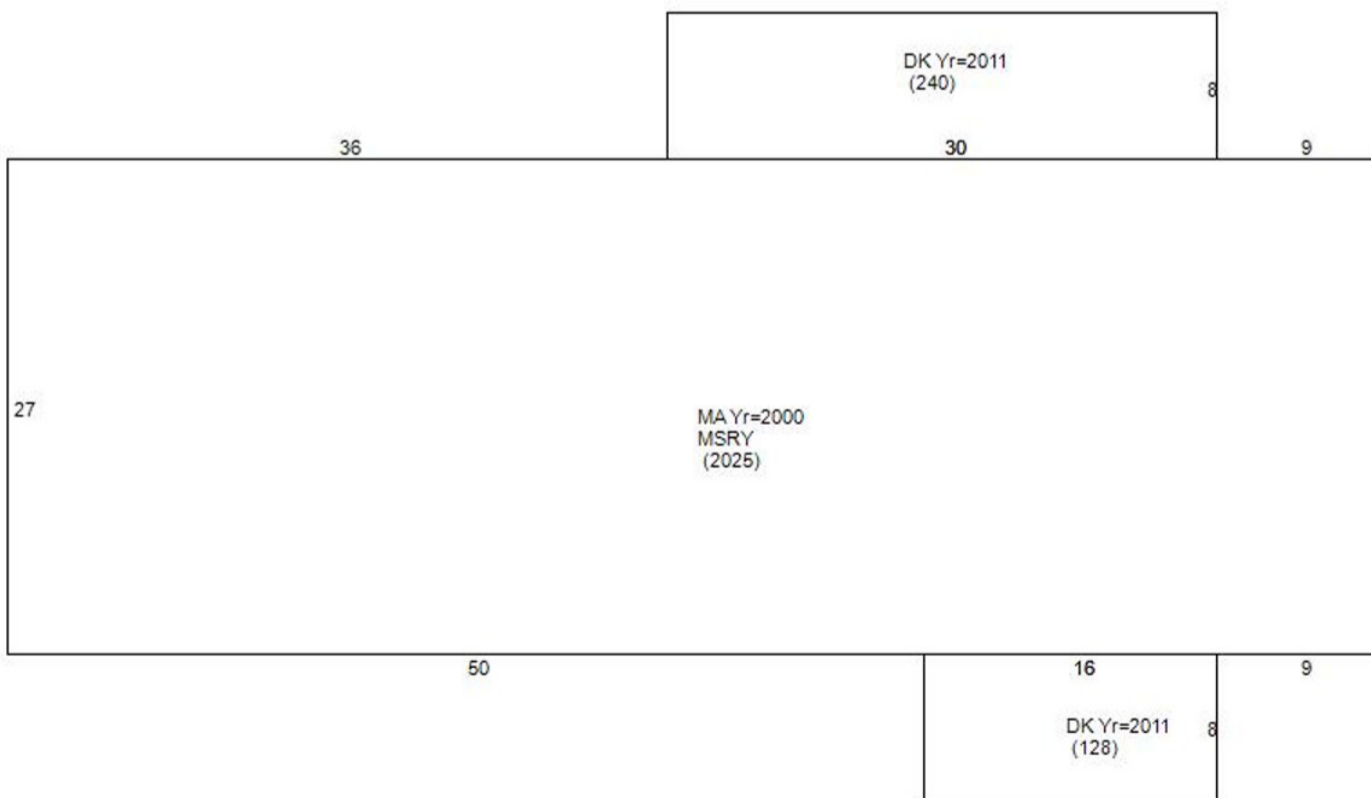
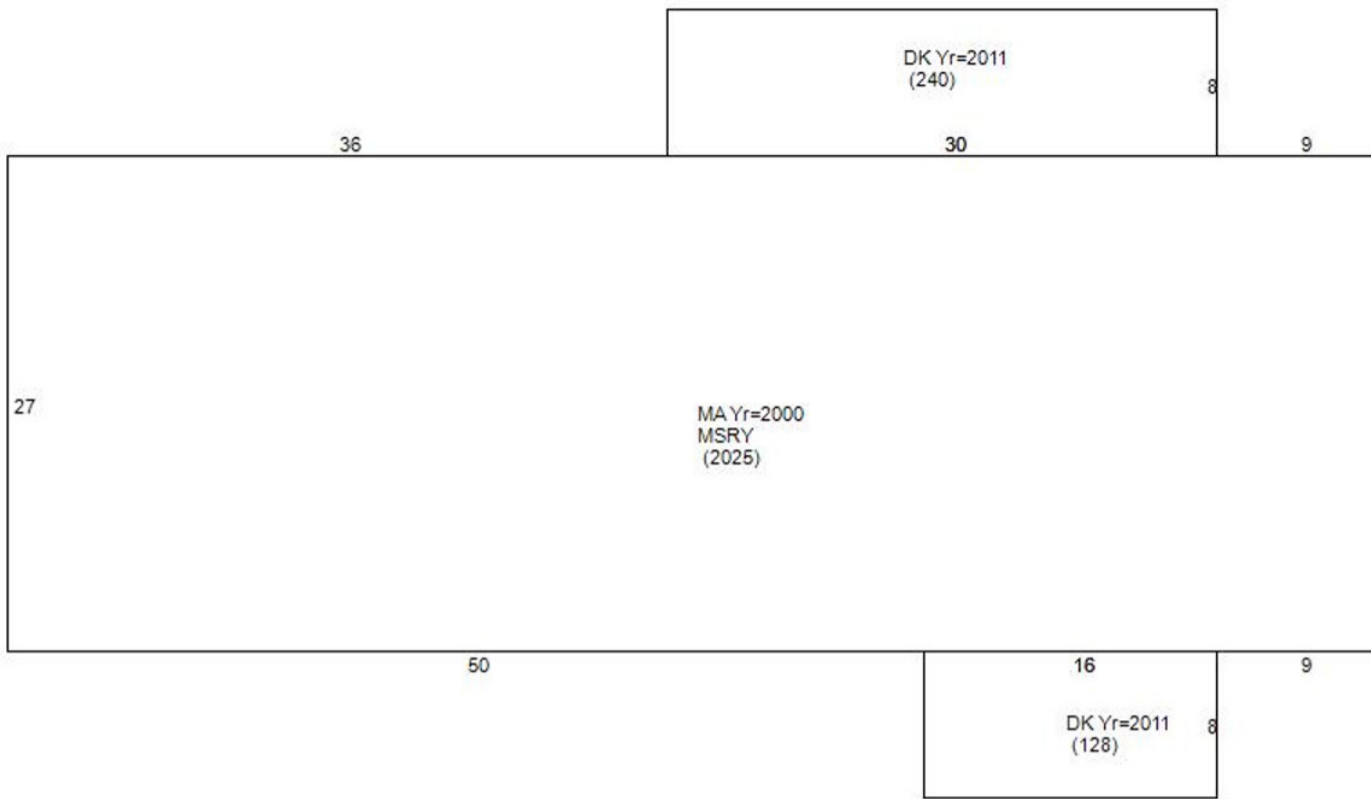

Orange County Assessor's Office makes every effort to produce the most accurate information possible. **No warranties, expressed or implied, are provided for the data herein, its use or interpretation.**