

Orange County North Carolina

315241
500 MEADOWLANDS DR

JANUARY 1ST OWNER MAILING ADDRESS
500 MEADOWLANDS DRIVE LLC
320 EXECUTIVE CT
HILLSBOROUGH NC 27278-

Total Assessed Value
\$1,222,800

KEY INFORMATION

Tax Year	2022		
Parcel ID	9874708468	Township	4 - HILLSBOROUGH
Land Size	2.48	Land Units	AC
Rate Code	23		
District Codes	G0 County, G3 Hillsborough		
Property LUC	Offices, Banks and Medical-Improved		
Neighborhood	H004 - 4MEADOWLAND		
Legal Description	C OENOPHILIA P80/130		
Exempt Type	-		

APPRAISAL DETAILS

Total Land	\$264,900
Ag Credit	-
Land	\$264,900
Building	\$938,800
Yard Items	\$19,100
Market Total	\$1,222,800
Total Assessed	\$1,222,800

RESIDENTIAL

BUILDING (1)					
Type	Office	Total Value	\$365,800	Finished Sq Ft	3,705 sf
Style	-	Quality	Grade C	Condition	Average
Year Built	1998	Exterior Walls		Full Bath	0
Roof Cover		Half Bath	0	HVAC	
Bedrooms	-	Garage Type	-		

BUILDING (2)					
--------------	--	--	--	--	--

MISC IMPROVEMENTS

IMPROVEMENT TYPE	UNITS/SQ FT	EST YEAR BUILT	APPRAISED VALUE
Y500 - PAVING	17622	1998	\$19,100

SALES

SALE DATE	SALE PRICE	DEED BOOK	DEED PAGE	INSTRUMENT TYPE	GRANTOR
11/18/2021	\$2,000,000	6756	447		-
07/30/2009	\$0	4796	80		KILEFF
07/30/2009	\$0	4796	82		OENOPHILIA
05/08/1998	\$129,000	1729	57		MEADOWLANDS
05/05/1998	\$0	549	154		MEADOWLANDS

YARD ITEMS

DESCRIPTION	TOTAL UNITS	YEAR BUILT	LENGTH	WIDTH	HEIGHT
No items to display					

LAND

UNIT / SOIL TYPE	DESCRIPTION	USE CODE	ACRES / LOTS	VALUE
C_AC	Com Acres	SITE	2.48	\$264,900

VALUE HISTORY

YEAR	TOTAL MARKET VALUE
2022	\$1,222,800
2021	\$1,222,800
2020	\$1,510,400
2019	\$1,510,400
2018	\$1,510,400
2017	\$1,510,400
2016	\$1,248,157
2015	\$1,248,157
2014	\$1,248,157
2013	\$1,248,157
2012	\$1,248,157

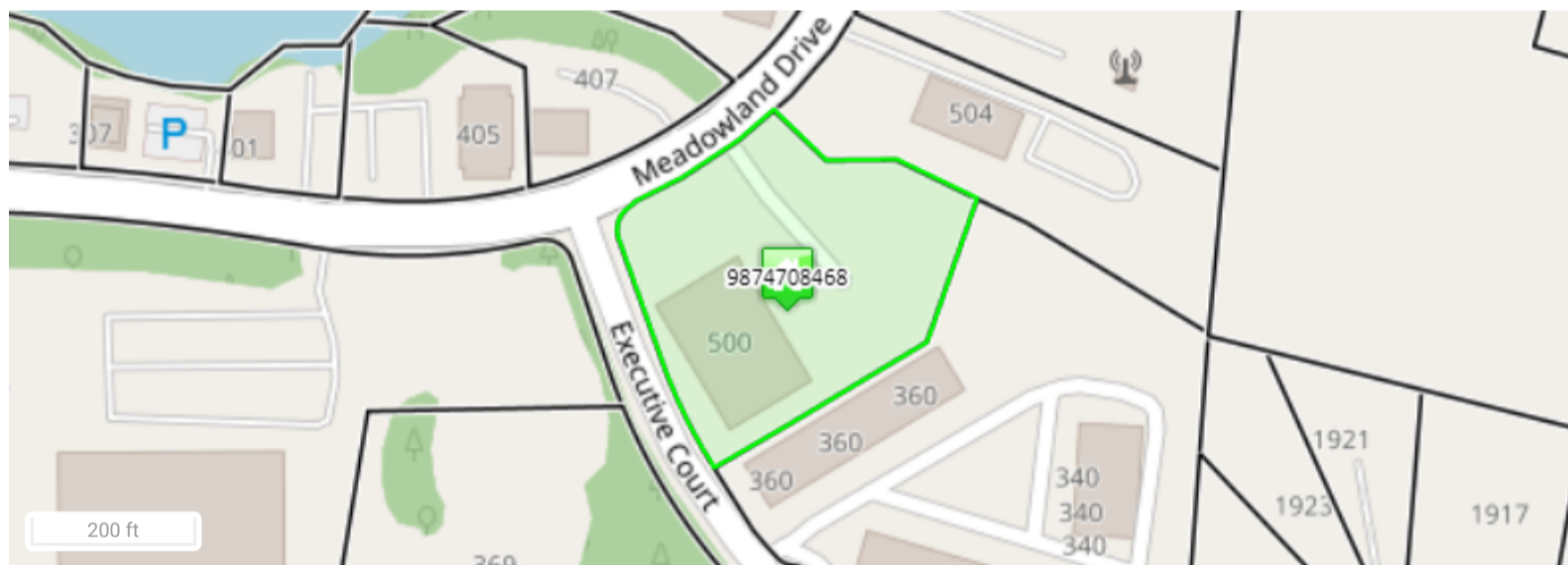

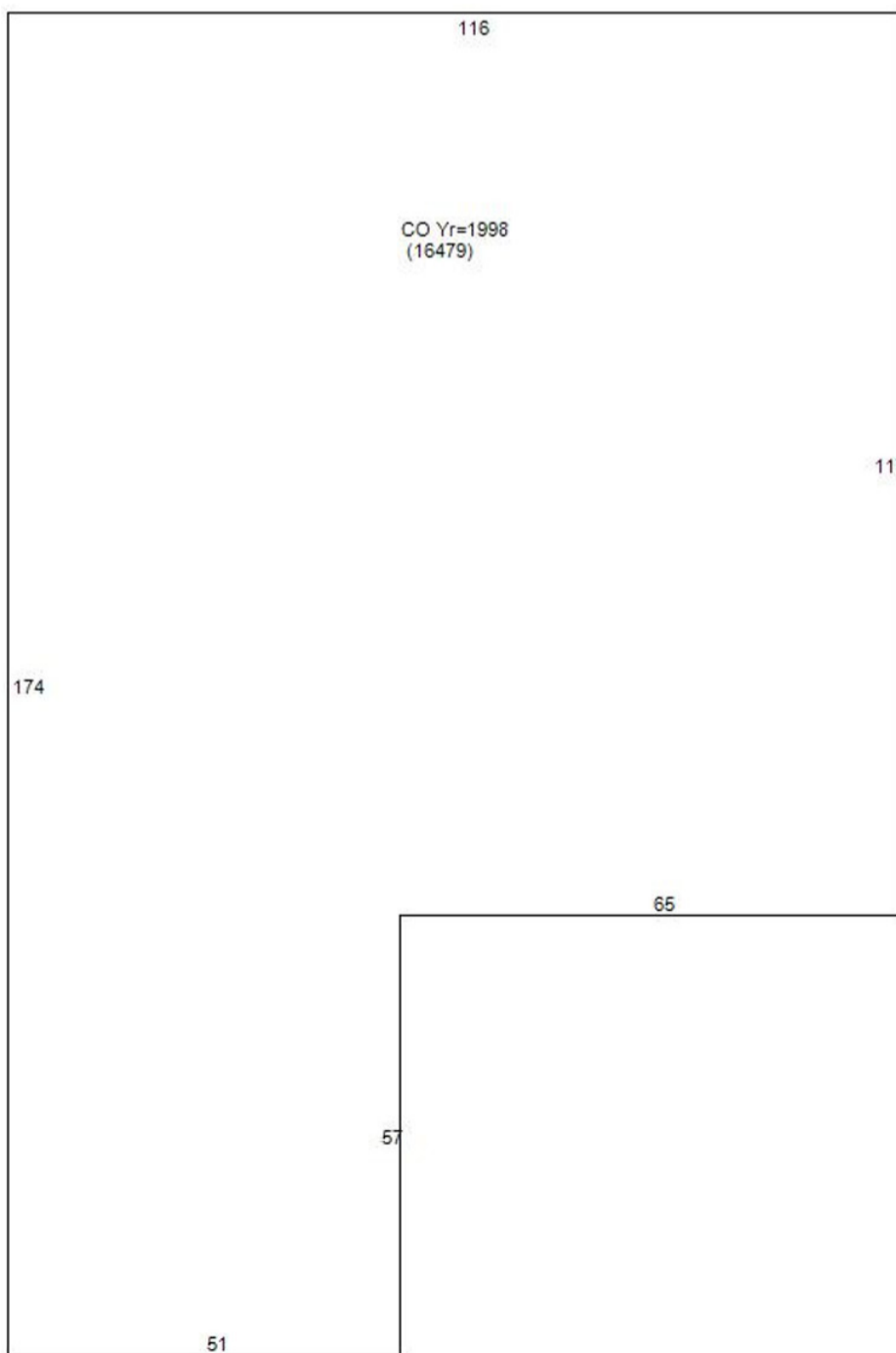
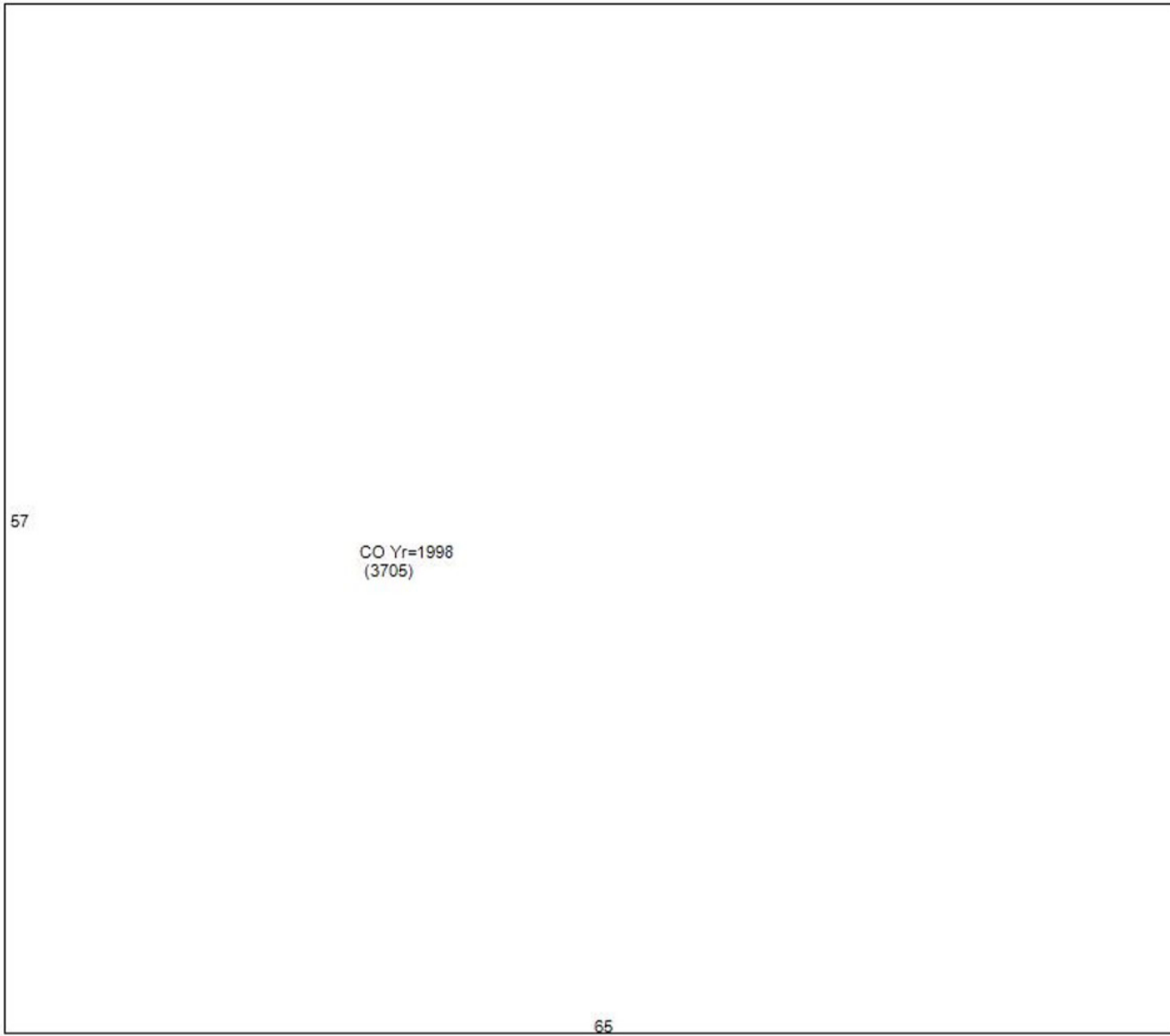

Orange County Assessor's Office makes every effort to produce the most accurate information possible. **No warranties, expressed or implied, are provided for the data herein, its use or interpretation.**