

**DURHAM PROPERTY RECORD SEARCH**

172233  
4321 MEDICAL PARK DR

**CURRENT** GREENLEAF INVESTMENT PARTNERS  
L095 LLC ET AL  
3081 HOLCOMB BRIDGE RD  
STE A2  
NORCROSS, GA, 30071

Total Assessed Value  
**\$12,717,793**

**KEY INFORMATION**

Tax District	CNTY-DRHM/CITY-DRHM	PIN	0833-16-37-4533
Account	8664422	Neighborhood	C833C
Land Use Code	480	Land Use Desc	COM/ MULTI-USE CAPABLE
Subdiv Code	0000	Subdiv Desc	N/A - NO SUBDIVISION
Deed Book & Page	009729 / 000866	Plat Book & Page:	000154 / 000379
Last Sale Date:	06/29/2022	Last Sale Price:	\$11,500,000
Jan 1st Owner:	5401 HOLDING COMPANY LLC		
Legal Description:	PROP-GMH INDPDNC LTD PRTN RSHP-HOCK GARY/LT#		

**ASSESSMENT DETAILS**

Land Fair Market Value	\$1,604,575
Improvement Fair Market Value	\$11,113,218
Total Fair Market Value	\$12,717,793

**RESIDENTIAL BUILDING (1)**

Assessed Total Improvement Value **\$11,113,218**

Year Built:	2001	Built Use / Ranch	IND-ENG/R&D BLDGS
Current Use	IND-ENG/R&D BLDGS	Percent Complete:	100%
Heated Area (S/F):	79,440	Full Bathroom(s):	0
Half Bathroom(s):	0	Bedroom(s):	0
Fireplace (Y/N):	N	Basement (Y/N):	N
Basement Unfinished:	-	Basement Finished:	-
Basement Partially Finished:	-	Attached Garage (Y/N):	N
Assessed Building Value:	\$11,113,218		

**LAND DETAILS**

Land Fair Market Value (FMV)	Land Assessed Value	Mapped Acres
\$1,604,575	\$1,604,575	8.169

**SALES**

Sales Date	Sale Price
06/29/2022	11,500,000
01/28/2019	8,600,000
03/24/2016	8,300,000
03/28/2007	20,636,500
10/04/2004	3,000,000
04/06/2004	15,127,000

**PERMITS**

Issue Date	Number	Description	Amount	Status	Closed Date
01/05/2011	1013440	-	-	-	02/22/2011

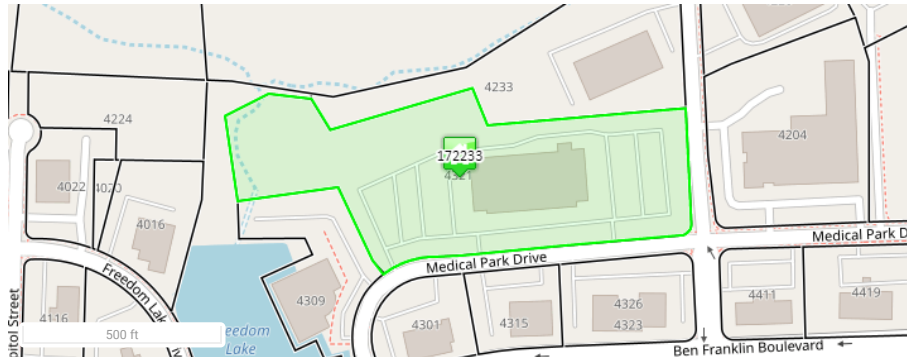



172233 11/11/2017

Disclaimer

Data Disclaimer: All data shown here is from other primary data sources and is public information. Users of this data are hereby notified that the aforementioned public information sources should be consulted for verification of the information contained on this website. **This site presents appraised value which may not represent taxable value.** While efforts have been made to use the most current and accurate data, Durham County, NC and Data Providers assume no legal responsibility for the use of the information contained herein.

Please direct any questions or comments about the data displayed here to [tax\\_assessor@dcnc.gov](mailto:tax_assessor@dcnc.gov)