

Orange County

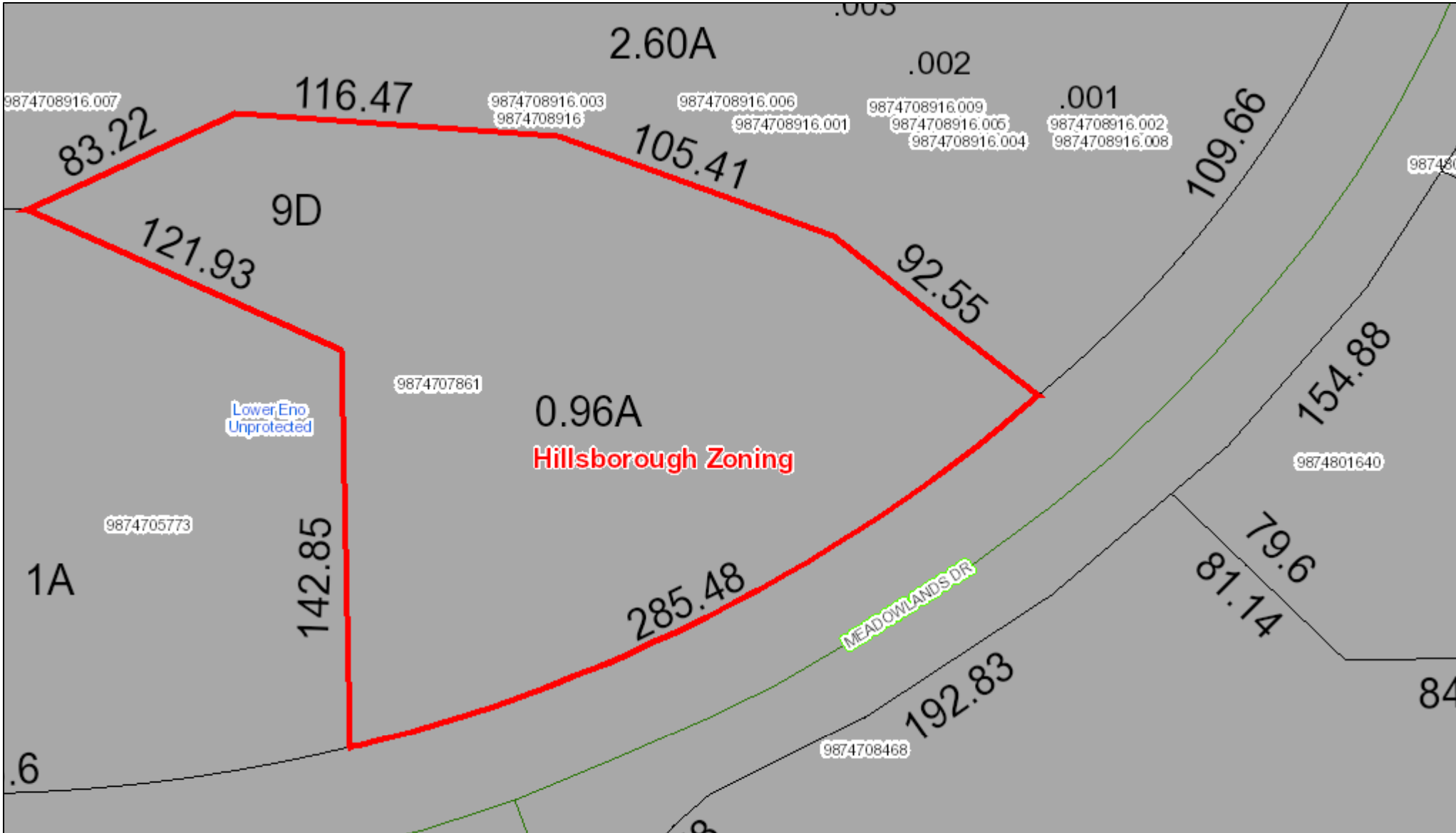

April 29, 2022

This map contains parcels prepared for the inventory of real property within Orange County, and is compiled from recorded deed, plats, and other public records and data. Users of this map are hereby notified that the aforementioned public primary information sources should be consulted for verification of the information contained on this map.

The county and its mapping companies assume no legal responsibility for the information on this map.

PIN: 9874707861	SIZE: 0.96 A	BUILDING COUNT: 1
OWNER 1: BEATTIE HUNTER	DEED REF: 6776/270	LAND VALUE:
OWNER 2:	RATECODE: 23	BLDG_VALUE:
ADDRESS 1: 404 MORGAN CREEK RD	TOWNSHIP: HILLSBOROUGH	USE_VALUE:
ADDRESS 2:	BLDG SQFT: 3136	TOTAL VALUE:
CITY: CHAPEL HILL	YEAR BUILT: 2009	DATE SOLD: 04/04/2022
STATE, ZIP: NC 27517		TAX STAMPS: 1250
LEGAL DESC: 9D MEADOWLANDS ASSOC P85/51 & P102/190		

