

DURHAM PROPERTY RECORD SEARCH157296
4018 STIRRUP CREEK DR**CURRENT** STIRRUP CREEK LLC
2810 MERIDIAN PKWY STE 120
DURHAM, NC, 27713Total Assessed Value
\$7,725,973**KEY INFORMATION**

Tax District	CNTY-DRHM/CITY-DRHM	PIN	0748-02-48-8684
Account	8644329	Neighborhood	C748D
Land Use Code	716	Land Use Desc	IND/ BIOTECH - BIOPHARM
Subdiv Code	0000	Subdiv Desc	N/A - NO SUBDIVISION
Deed Book & Page	008239 / 000309	Plat Book & Page:	000197 / 000197
Last Sale Date:	07/31/2017	Last Sale Price:	\$7,784,000
Jan 1st Owner:	LIFESTAR PHARMA LLC		
Legal Description:	PROP-SCANNELL PROPERTIES #230 LLC		

ASSESSMENT DETAILS

Land Fair Market Value	\$753,888
Improvement Fair Market Value	\$6,972,085
Total Fair Market Value	\$7,725,973

RESIDENTIAL BUILDING (1)Assessed Total Improvement Value **\$6,972,085**

Year Built:	2017	Built Use / Ranch	-
Current Use	-	Percent Complete:	100%
Heated Area (S/F):	96,795	Full Bathroom(s):	0
Half Bathroom(s):	0	Bedroom(s):	0
Fireplace (Y/N):	N	Basement (Y/N):	N
Basement Unfinished:	-	Basement Finished:	-
Basement Partially Finished:	-	Attached Garage (Y/N):	N
Assessed Building Value:	\$6,972,085		

LAND DETAILS

Land Fair Market Value (FMV)	Land Assessed Value	Mapped Acres
\$753,888	\$753,888	16.902

SALES

Sales Date	Sale Price
07/31/2017	7,784,000
07/29/2015	807,000

PERMITS

Issue Date	Number	Description	Amount	Status	Closed Date
11/08/2016	16104037	RETAINING WALLS	\$105,458	-	-
10/07/2016	16103198	96,095 SF Shell Building.	\$2,580,853	-	-

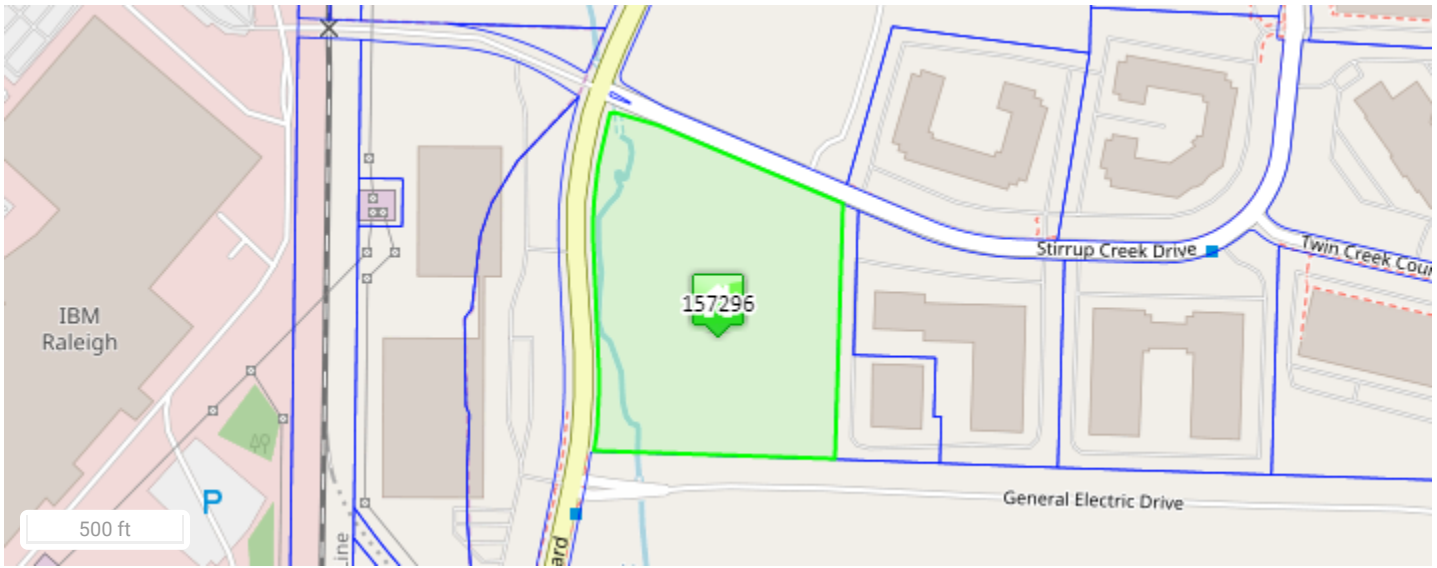

157296 10/18/2017

Disclaimer

Data Disclaimer: All data shown here is from other primary data sources and is public information. Users of this data are hereby notified that the aforementioned public information sources should be consulted for verification of the information contained on this website. **This site presents appraised value which may not represent taxable value.** While efforts have been made to use the most current and accurate data, Durham County, NC and Data Providers assume no legal responsibility for the use of the information contained herein.

Please direct any questions or comments about the data displayed here to tax_assessor@dconc.gov