

| LINE | BEARING | DISTANCE | CURVE | DELTA ANGLE | RADIUS | ARC | TANGENT | CHORD | CHORD BEARING |
|------|--------------|--------------|-------|-------------|----------|---------|----------------|---------|---------------|
| L 1 | N 89°13'44"E | 10.00' | C 1 | 07°08'34" | 2242.36' | 279.55' | 139.95' | 279.37' | S 07°33'34"W |
| L 2 | S 76°21'46"E | 19.05' | C 2 | 07°03'01" | 2222.36' | 273.47' | 136.91' | 273.30' | S 08°14'35"W |
| L 3 | S 89°13'44"W | 15.95' | | | | | | | |
| | | total | | | | | 849.91' | | |

N. C. HIGHWAY 55
150' R/W

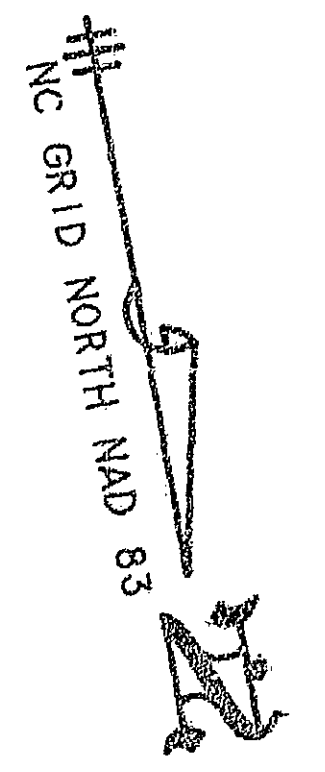

FILED 185 PAGE 185
195 JUN 2 PM 4 10.
REGISTER OF DEEDS
DURHAM COUNTY, N.C.

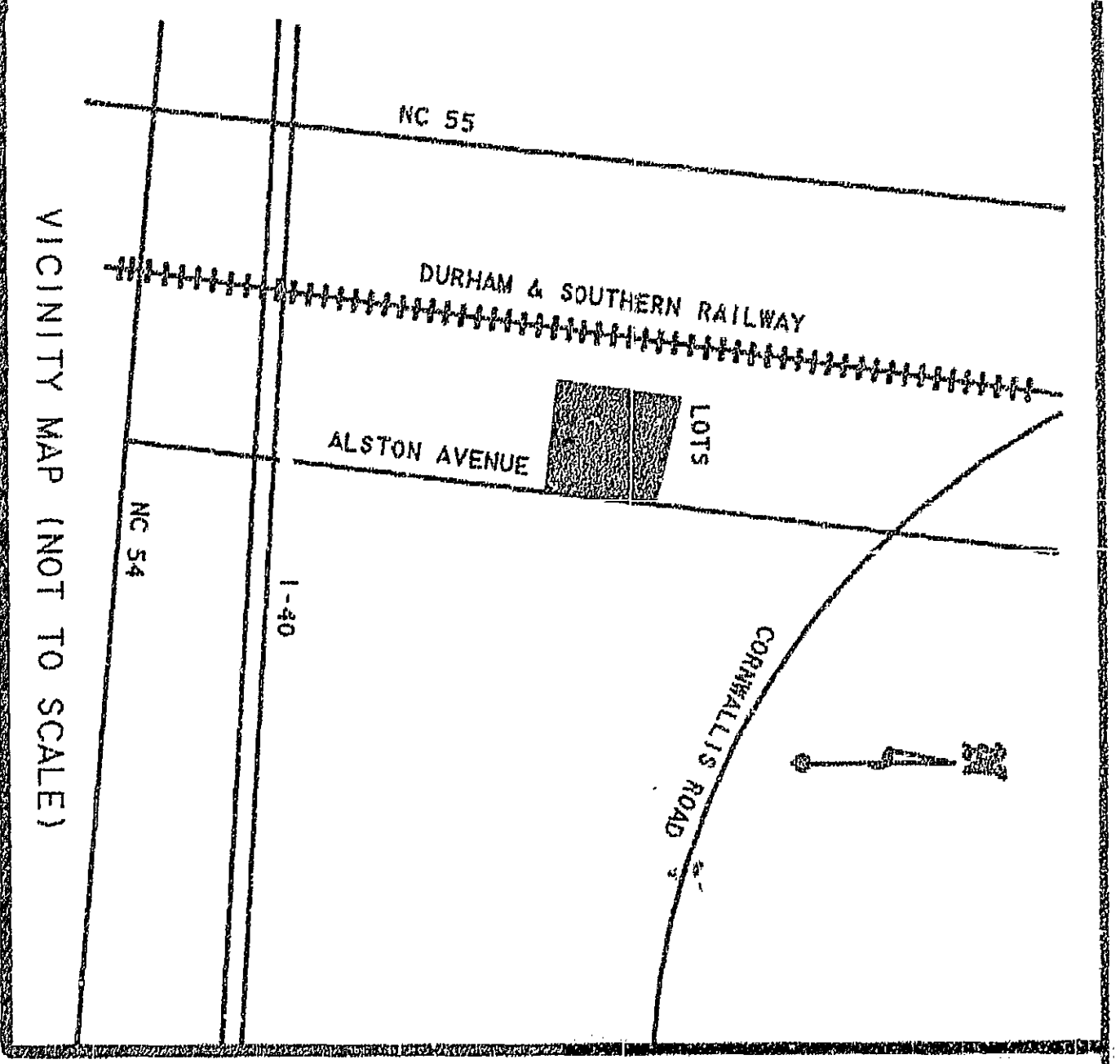

The undersigned Attorney hereby certifies that as of June 1, 1995, Fern G. King is the legal owner of the property shown herein and that she has the right to dedicate a portion of her property to the public use.

NORTH CAROLINA, WAKE COUNTY
I, NIAL GILLESPIE, R.L.S., CERTIFY THAT THIS PLAT WAS DRAWN UNDER MY SUPERVISION FROM AN ACTUAL SURVEY MADE UNDER MY PERSONAL SUPERVISION OR FROM RECORDS IN MY OFFICE. THE SURVEY BEING DRAWN FROM INFORMATION FOUND IN PLAT BOOK 24 PAGE 62 OF DEED BOOK 208 PAGES 466-467. THIS PLAT IS IN ACCORDANCE WITH G.S. 47-20 AS AMENDED, WITNESS MY ORIGINAL SIGNATURE AND SEAL, THIS 22nd DAY OF SEPTEMBER, 1994.
NIAL GILLESPIE, R.L.S. L. 2629

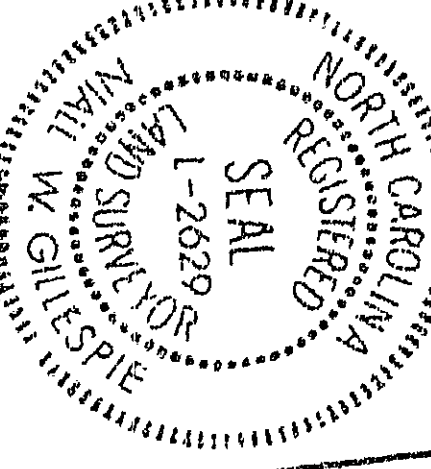

WAKE COUNTY, NORTH CAROLINA
I, MARY ANN ROOD, A NOTARY PUBLIC OF THE COUNTY AND STATE OF NORTH CAROLINA, DO HEREBY CERTIFY THAT I AM A REGISTERED LAND SURVEYOR OF THE FOREGOING INSTRUMENT WITNESS MY HAND AND SEAL THIS 22nd DAY OF SEPTEMBER, 1994.
MARY ANN ROOD
NOTARY PUBLIC
MY COMMISSION EXPIRES 7-8-98

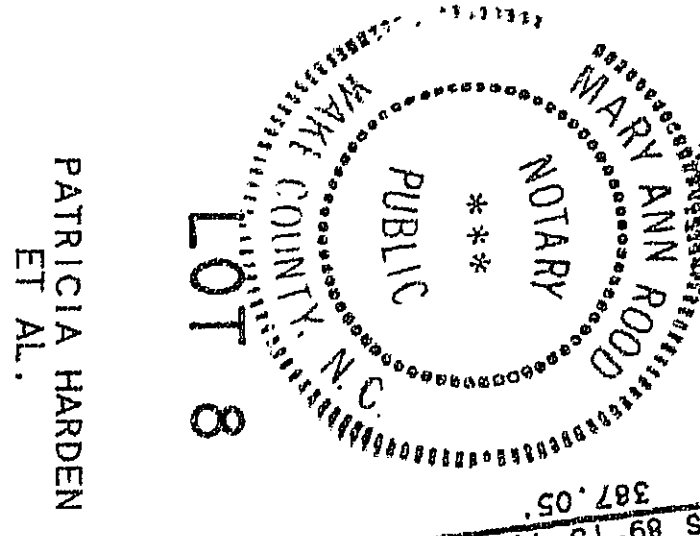

THE UNDERSIGNED OWNER OF THE PROPERTY LYING WITHIN THE ATTACHED PLAT HAS HEREBY DEDICATED TO THE PUBLIC USE THE PORTION OF THE PLAT SHOWN HEREIN AND PLATTING DONE AND THAT ALL PUBLIC AND PRIVATE STREETS, EASEMENTS AND OTHER AREAS SO DESIGNATED UPON SAID PLAT ARE HEREBY DEDICATED TO THE PUBLIC USE.

DURHAM COUNTY, NORTH CAROLINA
I, MACHA W. TILLEY, A NOTARY PUBLIC OF THE COUNTY AND STATE OF NORTH CAROLINA, DO HEREBY CERTIFY THAT I AM A REGISTERED LAND SURVEYOR OF THE FOREGOING INSTRUMENT WITNESS MY HAND AND SEAL THIS 22nd DAY OF SEPTEMBER, 1995.
MACHA W. TILLEY
NOTARY PUBLIC
MY COMMISSION EXPIRES 4/18/2000

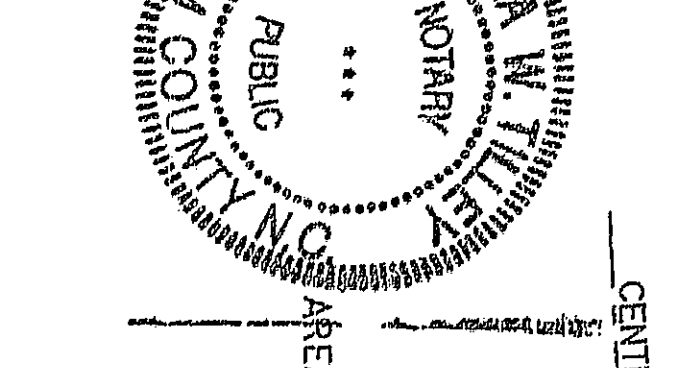

THIS PLAT HAS BEEN CERTIFIED FOR RECORDATION BY THE DURHAM COUNTY PLANNING DEPARTMENT BY: U.S. Roberts, A.P.
DATE: 6/2/95
APPROVAL VOID 60 DAYS FROM SAID DATE.

ORIGINAL R/W FROM PLAT BOOK 24 PAGE 62 (APPROXIMATELY 40' R/W) AREA IN R/W DEDICATED BY THIS RECORDING - 0.291 ACRE AS PUBLIC R/W

TOTAL NUMBER OF LOTS REQUESTED-2
TOTAL AREA: ORIGINAL - 6.913 ACRES
EXCLUDING R/W - 6.622 ACRES
ZONING- 01
TAX MAP 570 BLOCK 3 PARCEL 3

RECORDED BY:
NIAL GILLESPIE R.L.S.
4008 GREEN LEVEL ROAD
APEX, N.C. 27502
919-387-0208
SEPTEMBER 21, 1994

DURHAM COUNTY, NORTH CAROLINA
I, NOT APPLICABLE
STATE APPROVAL - CERTIFY THAT NOT APPLICABLE
PERSONALLY APPEARED BEFORE ME THIS DAY AND ACKNOWLEDGED THE EXECUTION OF THE FOREGOING INSTRUMENT WITNESS MY HAND AND SEAL THIS DAY OF SEPTEMBER, 1995.
NOTARY PUBLIC
MY COMMISSION EXPIRES

State of North Carolina - Durham County
The foregoing is certified of
Mary Ann Rood
Notary Public for the State of North Carolina
This is the 2nd day of September, 1995
Mach W. Tilley
Notary Public for the State of North Carolina

15092

SUBDIVISION SURVEY FOR FERN G. KING
LOT 7A & 7B J.L. GREEN ESTATE
TRIANGLE TOWNSHIP DURHAM, NORTH CAROLINA

SCALE 1" = 60'
0' 30' 60' 120' 180' 240'

