

UNIT # AREA ADDRESS FINISHED FLOOR ELEVATION CEILING ELEVATION

3721-A	1335 S.F.	3721-A UNIVERSITY DR.	366.00	375.00
3721-B	1844 S.F.	3721-B UNIVERSITY DR.	366.00	375.00
3721-C	1134 S.F.	3721-C UNIVERSITY DR.	366.00	375.00
3721-D	4107 S.F.	3721-D UNIVERSITY DR.	366.00	375.00

EXISTING BUILDING
FINISH FLOOR ELEV. = 366.52'

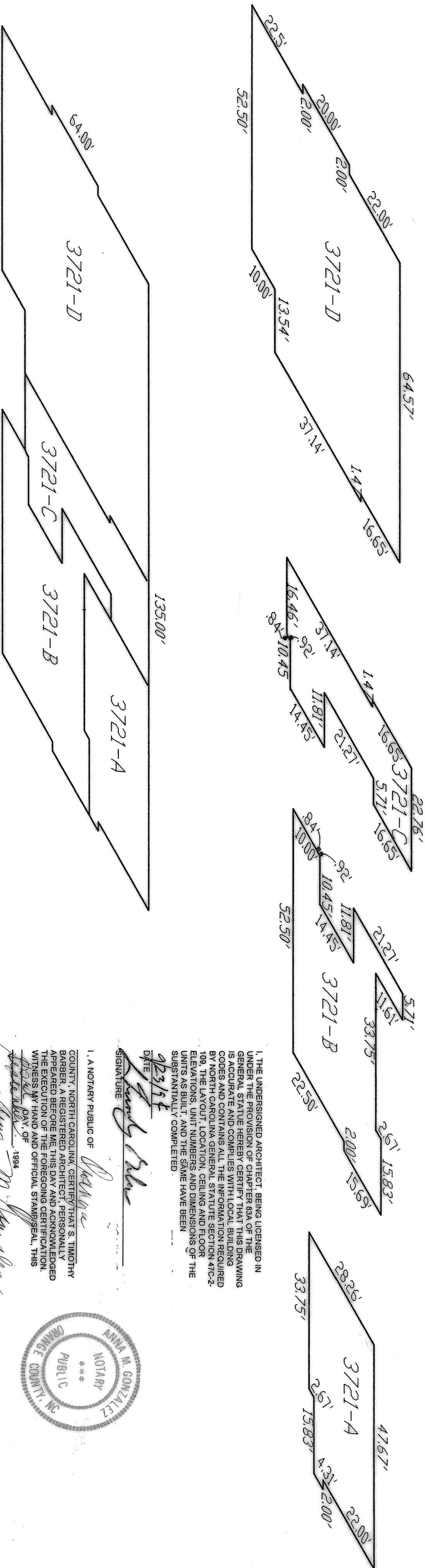
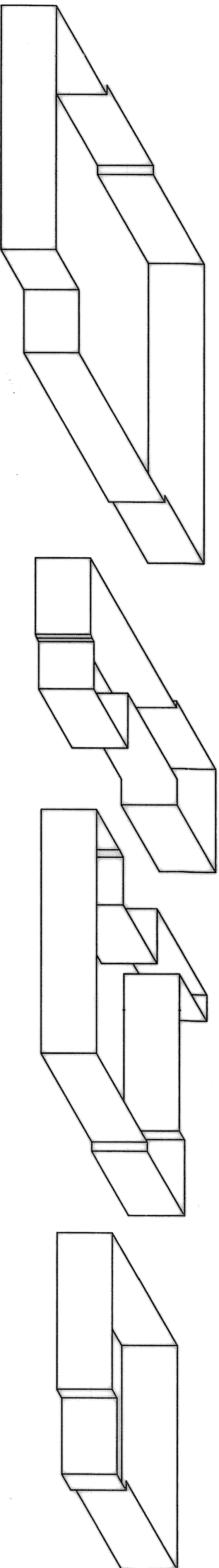

I, THE UNDERSIGNED ARCHITECT, BEING LICENSED IN
UNDER THE PROVISION OF CHAPTER 89A OF THE
GENERAL STATUTE HEREBY CERTIFY THAT THIS DRAWING
IS ACCURATE AND COMPLIES WITH LOCAL BUILDING
CODES AND CONTAINS ALL THE INFORMATION REQUIRED
BY NORTH CAROLINA GENERAL STATUTE SECTION 47C-2-
108, THE LAYOUT, LOCATION, CEILING AND FLOOR
ELEVATIONS, UNIT NUMBERS AND DIMENSIONS OF THE
UNITS AS BUILT, AND THE SAME HAVE BEEN
SUBSTANTIALLY COMPLETED.

DATE: 9/23/94
SIGNATURE: *[Signature]*

I, A NOTARY PUBLIC OF *[Signature]*

COUNTY, NORTH CAROLINA, CERTIFY THAT S. TIMOTHY
BARBER, A REGISTERED ARCHITECT, PERSONALLY
APPEARED BEFORE ME, THIS DAY AND ACKNOWLEDGED
THE EXECUTION OF THE FOREGOING CERTIFICATION.
WITNESS MY HAND AND OFFICIAL STAMP/SEAL, THIS
DAY OF *[Signature]*, 1994.

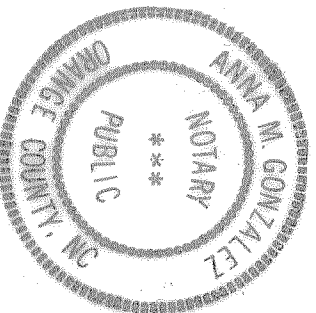

UNIVERSITY COMMONS
BUILDING 3721

CONDO PLAN

REVISIONS:
NO. DATE

THESE DOCUMENTS ARE INSTRUMENTS OF SERVICE AND AS SUCH REMAIN THE PROPERTY OF THE ARCHITECT. REVISIONS OF THIS DRAWING MUST BE APPROVED BY THE ARCHITECT.

Barber Architects
Post Office Box 51712
Durham, North Carolina 27717

BA

DATE
DRAWN BY
CHECKED BY
JOB NO.

SHEET NO.

2 OF