

DURHAM PROPERTY RECORD SEARCH

155357
1403 ODYSSEY DR

CURRENT SXCW PROPERTIES II LLC
PO BOX 56607
ATLANTA, GA, 30343

Total Assessed Value
\$380,228

KEY INFORMATION

Tax District	CNTY-DRHM/CITY-DRHM	PIN	0739-03-22-3970
Account	8685397	Neighborhood	C738D
Land Use Code	340	Land Use Desc	VACANT COMMERCIAL
Subdiv Code	0000	Subdiv Desc	N/A - NO SUBDIVISION
Deed Book & Page	009097 / 000684	Plat Book & Page:	000151 / 000133
Last Sale Date:	10/14/2020	Last Sale Price:	\$1,164,000
Jan 1st Owner:	SXCW PROPERTIES II LLC		
Legal Description:	PROP-DECHIARO LIMITED PARTNERSHIP/LT#10		

ASSESSMENT DETAILS

Land Fair Market Value	\$380,228
Improvement Fair Market Value	\$0
Total Fair Market Value	\$380,228

RESIDENTIAL BUILDING (1)

Assessed Total Improvement Value **\$0**

Year Built:	-	Built Use / Ranch	-
Current Use	-	Percent Complete:	0%
Heated Area (S/F):	-	Full Bathroom(s):	0
Half Bathroom(s):	0	Bedroom(s):	0
Fireplace (Y/N):	N	Basement (Y/N):	N
Basement Unfinished:	-	Basement Finished:	-
Basement Partially Finished:	-	Attached Garage (Y/N):	N
Assessed Building Value:	\$0		

LAND DETAILS

Land Fair Market Value (FMV)	Land Assessed Value	Mapped Acres
\$380,228	\$380,228	3.474

SALES

Sales Date	Sale Price
10/14/2020	1,164,000
03/05/2020	3,000,000

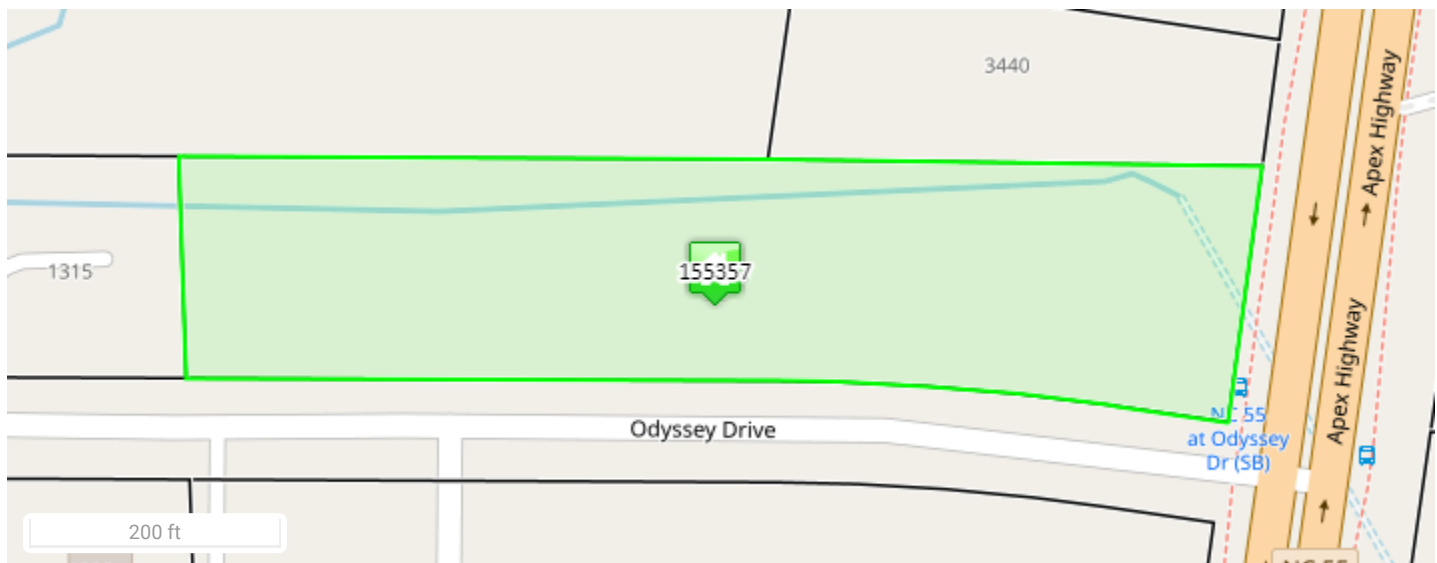

No Photo Available



Disclaimer

Data Disclaimer: All data shown here is from other primary data sources and is public information. Users of this data are hereby notified that the aforementioned public information sources should be consulted for verification of the information contained on this website. **This site presents appraised value which may not represent taxable value.** While efforts have been made to use the most current and accurate data, Durham County, NC and Data Providers assume no legal responsibility for the use of the information contained herein.

Please direct any questions or comments about the data displayed here to tax_assessor@dconc.gov

DURHAM PROPERTY RECORD SEARCH

155352
1120 CRATER LAKE WAY

CURRENT
PULTE HOME COMPANY LLC
1225 CRESCENT GREEN DR STE 250
CARY, NC, 27518

Total Assessed Value
\$451,316

KEY INFORMATION

Tax District	CNTY-DRHM/CITY-DRHM	PIN	0739-03-12-7001
Account	8679091	Neighborhood	C738D
Land Use Code	348	Land Use Desc	VAC COM/ DEVELOPER
Subdiv Code	0000	Subdiv Desc	N/A - NO SUBDIVISION
Deed Book & Page	008887 / 000837	Plat Book & Page:	000153 / 000359
Last Sale Date:	03/05/2020	Last Sale Price:	\$4,620,000
Jan 1st Owner:	PULTE HOME COMPANY LLC		
Legal Description:	PROP-DECHIARO LTD PARTNER SHIP/TR#H		

ASSESSMENT DETAILS

Land Fair Market Value	\$451,316
Improvement Fair Market Value	\$0
Total Fair Market Value	\$451,316

RESIDENTIAL BUILDING (1)

Assessed Total Improvement Value **\$0**

Year Built:	-	Built Use / Ranch	-
Current Use	-	Percent Complete:	0%
Heated Area (S/F):	-	Full Bathroom(s):	0
Half Bathroom(s):	0	Bedroom(s):	0
Fireplace (Y/N):	N	Basement (Y/N):	N
Basement Unfinished:	-	Basement Finished:	-
Basement Partially Finished:	-	Attached Garage (Y/N):	N
Assessed Building Value:	\$0		

LAND DETAILS

Land Fair Market Value (FMV)	Land Assessed Value	Mapped Acres
\$451,316	\$451,316	8.885

SALES

Sales Date	Sale Price
03/05/2020	4,620,000

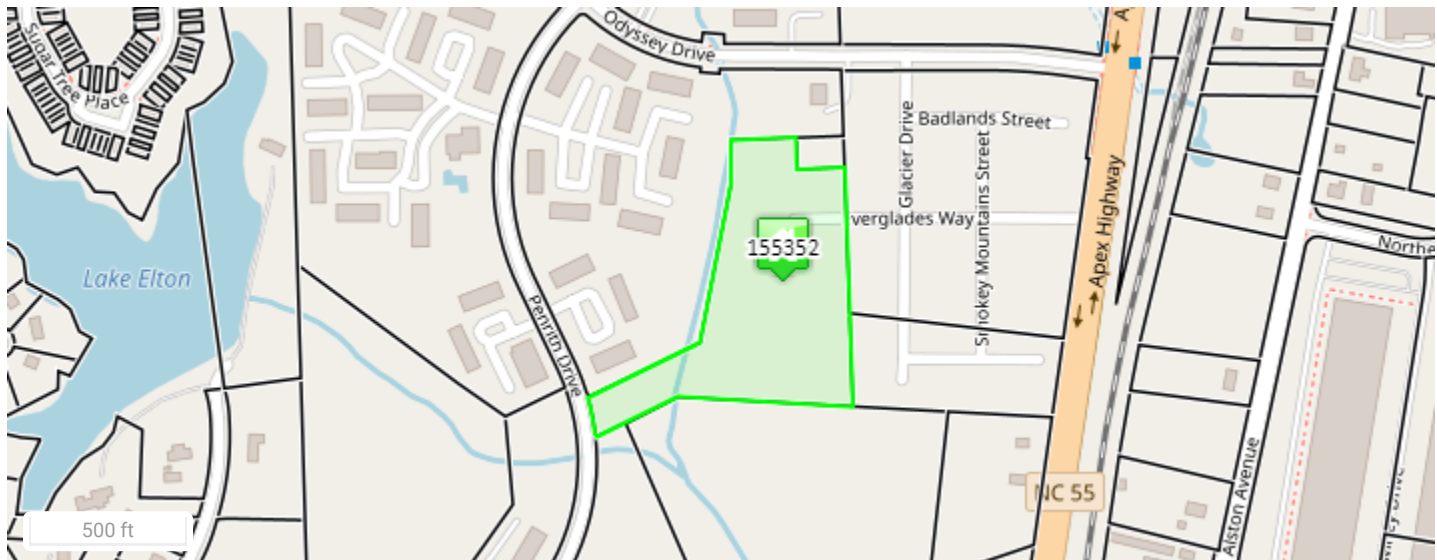

No Photo Available



Disclaimer

Data Disclaimer: All data shown here is from other primary data sources and is public information. Users of this data are hereby notified that the aforementioned public information sources should be consulted for verification of the information contained on this website. **This site presents appraised value which may not represent taxable value.** While efforts have been made to use the most current and accurate data, Durham County, NC and Data Providers assume no legal responsibility for the use of the information contained herein.

Please direct any questions or comments about the data displayed here to tax_assessor@dconc.gov

DURHAM PROPERTY RECORD SEARCH

155767
3430 NC 55 HWY

CURRENT
LAKEWOOD PARK DEVELOPMENT LLC
3013 RIDGE RD
DURHAM, NC, 27705

Total Assessed Value
\$115,125

KEY INFORMATION

Tax District	CNTY-DRHM/CITY-DRHM	PIN	0739-03-23-6351
Account	8679090	Neighborhood	C738D
Land Use Code	340	Land Use Desc	VACANT COMMERCIAL
Subdiv Code	2070	Subdiv Desc	PROP-POLLARD A J
Deed Book & Page	008887 / 000828	Plat Book & Page:	00018A / 000183
Last Sale Date:	03/05/2020	Last Sale Price:	\$3,000,000
Jan 1st Owner:	LAKEWOOD PARK DEVELOPMENT LLC		
Legal Description:	PROP-POLLARD A J/BLK:A/LT #12-13		

ASSESSMENT DETAILS

Land Fair Market Value	\$115,125
Improvement Fair Market Value	\$0
Total Fair Market Value	\$115,125

RESIDENTIAL BUILDING (1)

Assessed Total Improvement Value **\$0**

Year Built:	-	Built Use / Ranch	-
Current Use	-	Percent Complete:	0%
Heated Area (S/F):	-	Full Bathroom(s):	0
Half Bathroom(s):	0	Bedroom(s):	0
Fireplace (Y/N):	N	Basement (Y/N):	N
Basement Unfinished:	-	Basement Finished:	-
Basement Partially Finished:	-	Attached Garage (Y/N):	N
Assessed Building Value:	\$0		

LAND DETAILS

Land Fair Market Value (FMV)	Land Assessed Value	Mapped Acres
\$115,125	\$115,125	0.921

SALES

Sales Date	Sale Price
03/05/2020	3,000,000
05/31/2001	310,000

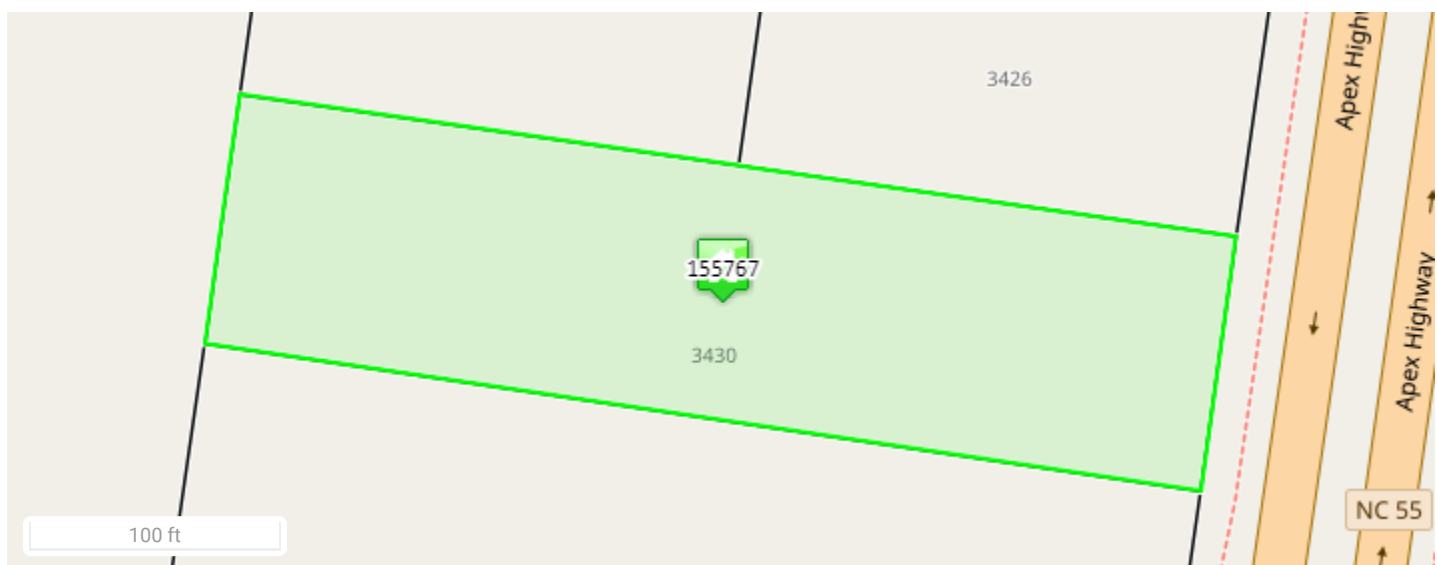

No Photo Available



Disclaimer

Data Disclaimer: All data shown here is from other primary data sources and is public information. Users of this data are hereby notified that the aforementioned public information sources should be consulted for verification of the information contained on this website. **This site presents appraised value which may not represent taxable value.** While efforts have been made to use the most current and accurate data, Durham County, NC and Data Providers assume no legal responsibility for the use of the information contained herein.

Please direct any questions or comments about the data displayed here to tax_assessor@dconc.gov

DURHAM PROPERTY RECORD SEARCH

155766
3432 NC 55 HWY

CURRENT
LAKEWOOD PARK DEVELOPMENT LLC
3013 RIDGE RD
DURHAM, NC, 27705

Total Assessed Value
\$152,000

KEY INFORMATION

Tax District	CNTY-DRHM/CITY-DRHM	PIN	0739-03-23-6138
Account	8679090	Neighborhood	C738D
Land Use Code	340	Land Use Desc	VACANT COMMERCIAL
Subdiv Code	2070	Subdiv Desc	PROP-POLLARD A J
Deed Book & Page	008887 / 000828	Plat Book & Page:	00018A / 000183
Last Sale Date:	03/05/2020	Last Sale Price:	\$3,000,000
Jan 1st Owner:	LAKEWOOD PARK DEVELOPMENT LLC		
Legal Description:	PROP-POLLARD A J/BLK:A/LT #09-11 INCL		

ASSESSMENT DETAILS

Land Fair Market Value	\$152,000
Improvement Fair Market Value	\$0
Total Fair Market Value	\$152,000

RESIDENTIAL BUILDING (1)

Assessed Total Improvement Value **\$0**

Year Built:	-	Built Use / Ranch	-
Current Use	-	Percent Complete:	0%
Heated Area (S/F):	-	Full Bathroom(s):	0
Half Bathroom(s):	0	Bedroom(s):	0
Fireplace (Y/N):	N	Basement (Y/N):	N
Basement Unfinished:	-	Basement Finished:	-
Basement Partially Finished:	-	Attached Garage (Y/N):	N
Assessed Building Value:	\$0		

LAND DETAILS

Land Fair Market Value (FMV)	Land Assessed Value	Mapped Acres
\$152,000	\$152,000	1.36

SALES

Sales Date	Sale Price
03/05/2020	3,000,000
05/31/2001	310,000

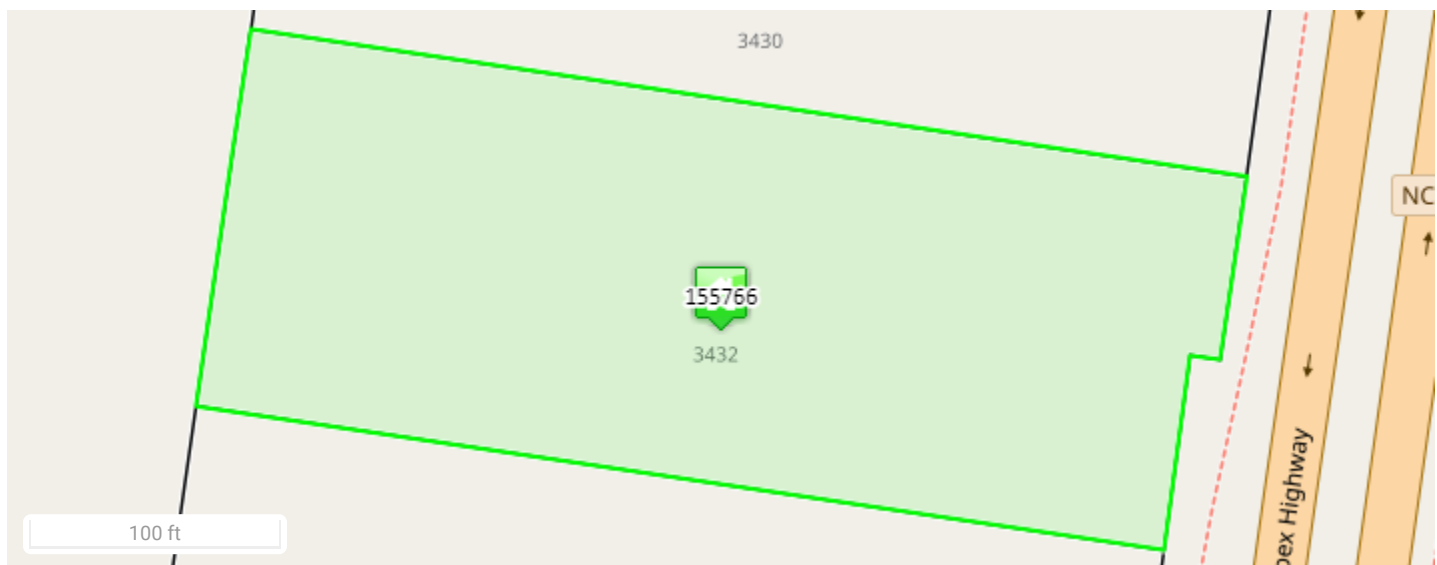

No Photo Available



Disclaimer

Data Disclaimer: All data shown here is from other primary data sources and is public information. Users of this data are hereby notified that the aforementioned public information sources should be consulted for verification of the information contained on this website. **This site presents appraised value which may not represent taxable value.** While efforts have been made to use the most current and accurate data, Durham County, NC and Data Providers assume no legal responsibility for the use of the information contained herein.

Please direct any questions or comments about the data displayed here to tax_assessor@dconc.gov

DURHAM PROPERTY RECORD SEARCH

155763
3440 NC 55 HWY

CURRENT SXCW PROPERTIES II LLC
PO BOX 56607
ATLANTA, GA, 30343

Total Assessed Value
\$134,900

KEY INFORMATION

Tax District	CNTY-DRHM/CITY-DRHM	PIN	0739-03-23-5095
Account	8685397	Neighborhood	C738D
Land Use Code	340	Land Use Desc	VACANT COMMERCIAL
Subdiv Code	2070	Subdiv Desc	PROP-POLLARD A J
Deed Book & Page	009097 / 000684	Plat Book & Page:	00018A / 000183
Last Sale Date:	10/14/2020	Last Sale Price:	\$1,164,000
Jan 1st Owner:	SXCW PROPERTIES II LLC		
Legal Description:	PROP-POLLARD A J/BLK:A/LT #07-08		

ASSESSMENT DETAILS

Land Fair Market Value	\$134,900
Improvement Fair Market Value	\$0
Total Fair Market Value	\$134,900

RESIDENTIAL BUILDING (1)

Assessed Total Improvement Value **\$0**

Year Built:	-	Built Use / Ranch	-
Current Use	-	Percent Complete:	0%
Heated Area (S/F):	-	Full Bathroom(s):	0
Half Bathroom(s):	0	Bedroom(s):	0
Fireplace (Y/N):	N	Basement (Y/N):	N
Basement Unfinished:	-	Basement Finished:	-
Basement Partially Finished:	-	Attached Garage (Y/N):	N
Assessed Building Value:	\$0		

LAND DETAILS

Land Fair Market Value (FMV)	Land Assessed Value	Mapped Acres
\$134,900	\$134,900	1.132

SALES

Sales Date	Sale Price
10/14/2020	1,164,000
03/05/2020	3,000,000
05/31/2001	310,000

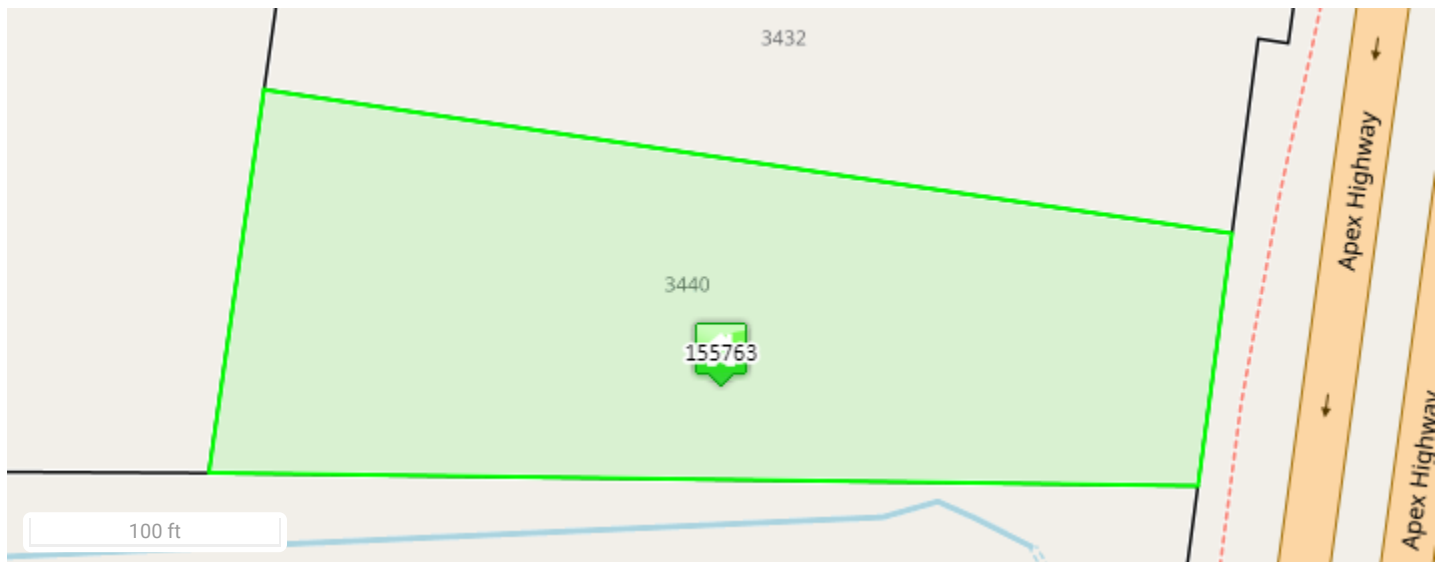

No Photo Available



Disclaimer

Data Disclaimer: All data shown here is from other primary data sources and is public information. Users of this data are hereby notified that the aforementioned public information sources should be consulted for verification of the information contained on this website. **This site presents appraised value which may not represent taxable value.** While efforts have been made to use the most current and accurate data, Durham County, NC and Data Providers assume no legal responsibility for the use of the information contained herein.

Please direct any questions or comments about the data displayed here to tax_assessor@dconc.gov

DURHAM PROPERTY RECORD SEARCH

155356
3500 NC 55 HWY

CURRENT
PULTE HOME COMPANY LLC
1225 CRESCENT GREEN DR STE 250
CARY, NC, 27518

Total Assessed Value
\$1,088,675

KEY INFORMATION

Tax District	CNTY-DRHM/CITY-DRHM	PIN	0739-03-22-3344
Account	8679091	Neighborhood	C738D
Land Use Code	340	Land Use Desc	VACANT COMMERCIAL
Subdiv Code	0000	Subdiv Desc	N/A - NO SUBDIVISION
Deed Book & Page	008887 / 000837	Plat Book & Page:	000151 / 000133
Last Sale Date:	03/05/2020	Last Sale Price:	\$4,620,000
Jan 1st Owner:	PULTE HOME COMPANY LLC		
Legal Description:	PROP-DECHIARO LIMITED PARTNERSHIP/LT#09		

ASSESSMENT DETAILS

Land Fair Market Value	\$1,088,675
Improvement Fair Market Value	\$0
Total Fair Market Value	\$1,088,675

RESIDENTIAL BUILDING (1)

Assessed Total Improvement Value **\$0**

Year Built:	-	Built Use / Ranch	-
Current Use	-	Percent Complete:	0%
Heated Area (S/F):	-	Full Bathroom(s):	0
Half Bathroom(s):	0	Bedroom(s):	0
Fireplace (Y/N):	N	Basement (Y/N):	N
Basement Unfinished:	-	Basement Finished:	-
Basement Partially Finished:	-	Attached Garage (Y/N):	N
Assessed Building Value:	\$0		

LAND DETAILS

Land Fair Market Value (FMV)	Land Assessed Value	Mapped Acres
\$1,088,675	\$1,088,675	13.849

SALES

Sales Date	Sale Price
03/05/2020	4,620,000



No Photo Available



Disclaimer

Data Disclaimer: All data shown here is from other primary data sources and is public information. Users of this data are hereby notified that the aforementioned public information sources should be consulted for verification of the information contained on this website. **This site presents appraised value which may not represent taxable value.** While efforts have been made to use the most current and accurate data, Durham County, NC and Data Providers assume no legal responsibility for the use of the information contained herein.

Please direct any questions or comments about the data displayed here to tax_assessor@dconc.gov

DURHAM PROPERTY RECORD SEARCH

155354
3614 NC 55 HWY

CURRENT
PULTE HOME COMPANY LLC
1225 CRESCENT GREEN DR STE 250
CARY, NC, 27518

Total Assessed Value
\$340,408

KEY INFORMATION

Tax District	CNTY-DRHM/CITY-DRHM	PIN	0739-03-21-3709
Account	8679091	Neighborhood	C738D
Land Use Code	340	Land Use Desc	VACANT COMMERCIAL
Subdiv Code	0000	Subdiv Desc	N/A - NO SUBDIVISION
Deed Book & Page	008887 / 000837	Plat Book & Page:	000076 / 000038
Last Sale Date:	03/05/2020	Last Sale Price:	\$4,620,000
Jan 1st Owner:	PULTE HOME COMPANY LLC		
Legal Description:	PROP-GREEN J L EST/TR#10 PT/PROP-WHEELER-LEONARD		

ASSESSMENT DETAILS

Land Fair Market Value	\$340,408
Improvement Fair Market Value	\$0
Total Fair Market Value	\$340,408

RESIDENTIAL BUILDING (1)

Assessed Total Improvement Value **\$0**

Year Built:	-	Built Use / Ranch	-
Current Use	-	Percent Complete:	0%
Heated Area (S/F):	-	Full Bathroom(s):	0
Half Bathroom(s):	0	Bedroom(s):	0
Fireplace (Y/N):	N	Basement (Y/N):	N
Basement Unfinished:	-	Basement Finished:	-
Basement Partially Finished:	-	Attached Garage (Y/N):	N
Assessed Building Value:	\$0		

LAND DETAILS

Land Fair Market Value (FMV)	Land Assessed Value	Mapped Acres
\$340,408	\$340,408	4.111

SALES

Sales Date	Sale Price
03/05/2020	4,620,000

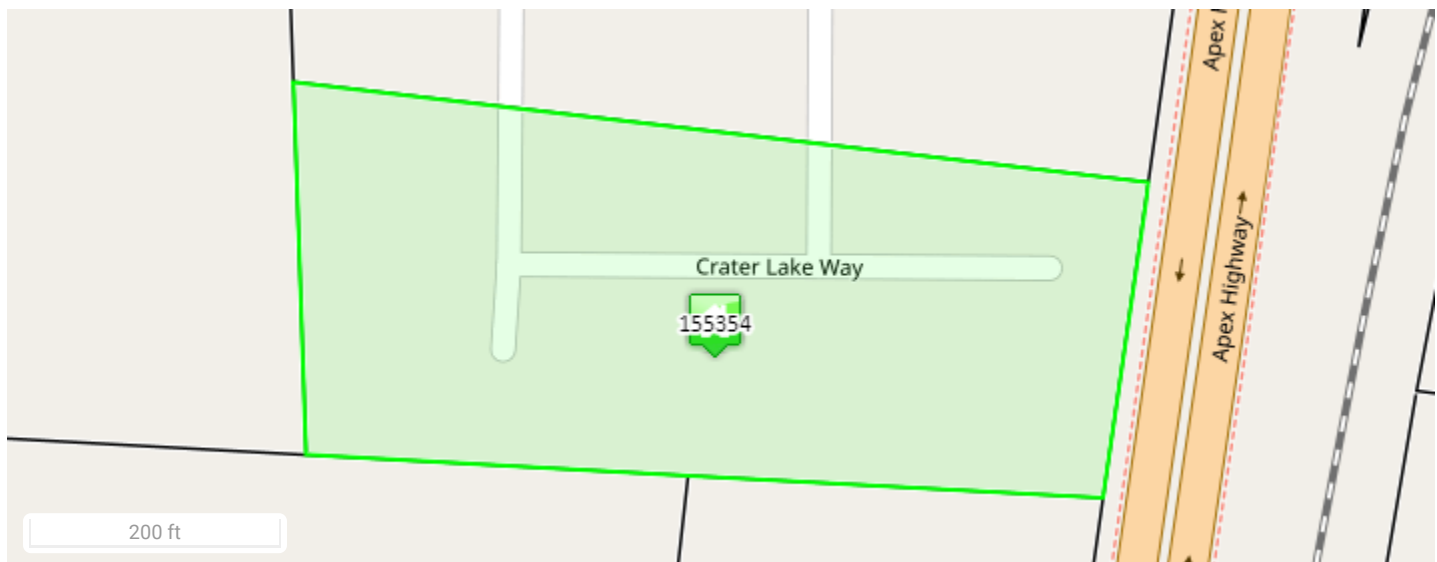

No Photo Available



Disclaimer

Data Disclaimer: All data shown here is from other primary data sources and is public information. Users of this data are hereby notified that the aforementioned public information sources should be consulted for verification of the information contained on this website. **This site presents appraised value which may not represent taxable value.** While efforts have been made to use the most current and accurate data, Durham County, NC and Data Providers assume no legal responsibility for the use of the information contained herein.

Please direct any questions or comments about the data displayed here to tax_assessor@dconc.gov