

## DURHAM PROPERTY RECORD SEARCH

155763  
3440 NC 55 HWY

**CURRENT** SXCW PROPERTIES II LLC  
PO BOX 56607  
ATLANTA, GA, 30343

Total Assessed Value  
**\$134,900**

### KEY INFORMATION

Tax District	CNTY-DRHM/CITY-DRHM	PIN	0739-03-23-5095
Account	8685397	Neighborhood	C738D
Land Use Code	340	Land Use Desc	VACANT COMMERCIAL
Subdiv Code	2070	Subdiv Desc	PROP-POLLARD A J
Deed Book & Page	009097 / 000684	Plat Book & Page:	00018A / 000183
Last Sale Date:	10/14/2020	Last Sale Price:	\$1,164,000
Jan 1st Owner:	SXCW PROPERTIES II LLC		
Legal Description:	PROP-POLLARD A J/BLK:A/LT #07-08		

### ASSESSMENT DETAILS

Land Fair Market Value	\$134,900
Improvement Fair Market Value	\$0
Total Fair Market Value	\$134,900

### RESIDENTIAL BUILDING (1)

Assessed Total Improvement Value **\$0**

Year Built:	-	Built Use / Ranch	-
Current Use	-	Percent Complete:	0%
Heated Area (S/F):	-	Full Bathroom(s):	0
Half Bathroom(s):	0	Bedroom(s):	0
Fireplace (Y/N):	N	Basement (Y/N):	N
Basement Unfinished:	-	Basement Finished:	-
Basement Partially Finished:	-	Attached Garage (Y/N):	N
Assessed Building Value:	\$0		

### LAND DETAILS

Land Fair Market Value (FMV)	Land Assessed Value	Mapped Acres
\$134,900	\$134,900	1.132

### SALES

Sales Date	Sale Price
10/14/2020	1,164,000
03/05/2020	3,000,000
05/31/2001	310,000

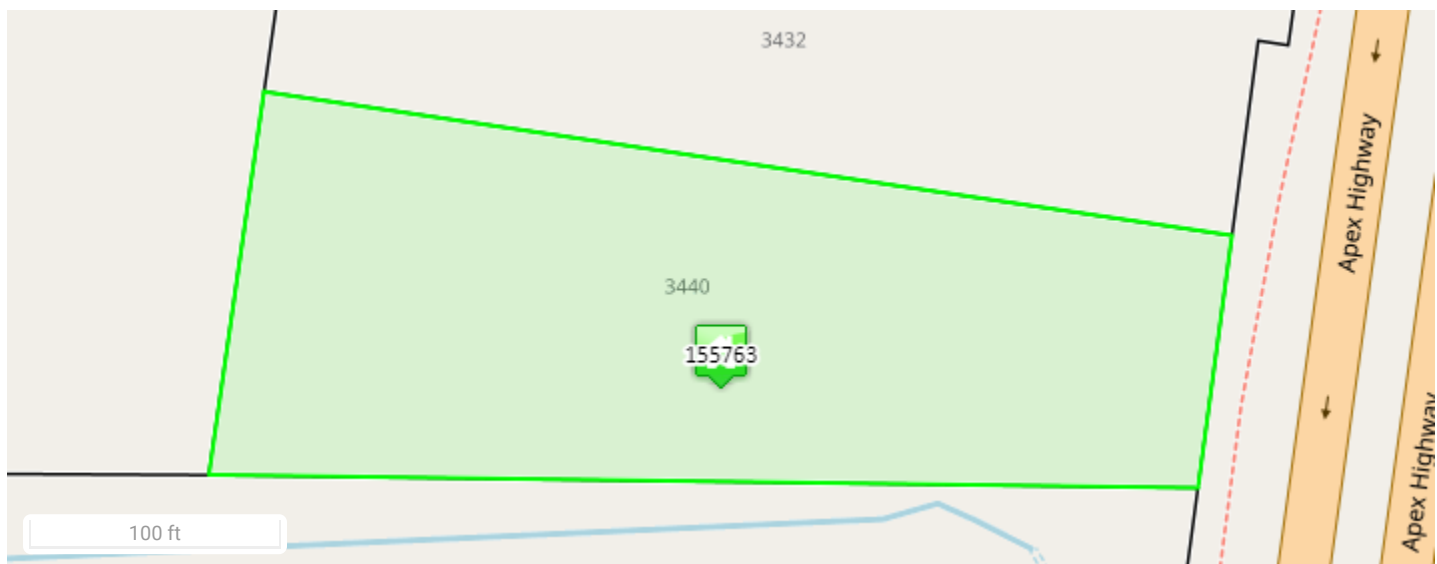

No Photo Available



---

#### Disclaimer

Data Disclaimer: All data shown here is from other primary data sources and is public information. Users of this data are hereby notified that the aforementioned public information sources should be consulted for verification of the information contained on this website. **This site presents appraised value which may not represent taxable value.** While efforts have been made to use the most current and accurate data, Durham County, NC and Data Providers assume no legal responsibility for the use of the information contained herein.

Please direct any questions or comments about the data displayed here to [tax\\_assessor@dconc.gov](mailto:tax_assessor@dconc.gov)