

FOREST AT DUKE, INC.
D.B. 1611/831
P.B. 98/140
T.M. 235-01-013C

3300 UNITED PARTNERSHIP
D.B. 1050/59, TRACT #2
P.B. 98/140
P.B. 134/122
T.M. 235-01-013

DUKE FOREST
DEVELOPMENT CORPORATION
C.D. 3/29
T.M. 235-01-013A,50-57

EIP CONTROL CORNER

N01°09'01"E 196.91

N01°09'01"E 183.66(TOTAL)

5.7

N01°09'01"E 56.85

N87°06'20"E 279.31

NEW PROPERTY LINES

3.7

18,052 ± S.F. (0.414 ACRES)

189.6

S89°30'30"E 182.22

15.8

SIP

SIP

SIP

SIP

SIP

SIP

SIP

SIP

SIP

SIP

SIP

SIP

SIP

SIP

SIP

SIP

SIP

SIP

SIP

SIP

SIP

SIP

SIP

SIP

SIP

SIP

SIP

SIP

SIP

SIP

SIP

SIP

SIP

SIP

SIP

SIP

SIP

SIP

SIP

SIP

SIP

SIP

SIP

SIP

SIP

DUKE UNIVERSITY
D.B. 15/52
T.M. 436-01-002

BOOK 192 PAGE 94
99 DEC 22 AM 10 35
WILLIE L. COVINGTON
REGISTER OF DEEDS
DURHAM COUNTY, N.C.

CHapel Hill Boulevard Service Road
VARIABLE WIDTH PUBLIC R/W

State of North Carolina
County of Durham

I, Judy F. Hostford, Reviewer/ Officer of Durham
County, certify that the map or plat to which this
certification is affixed meets all statutory
requirements for recording.

Date: 12/21/98
Reviewer/ Officer: Judy F. Hostford

FINAL PLAT

approved by the Durham
Development Review Board
on 11-6-98

Clark Development Review Board

approval void if not recorded within
90 days or by:

3300 S

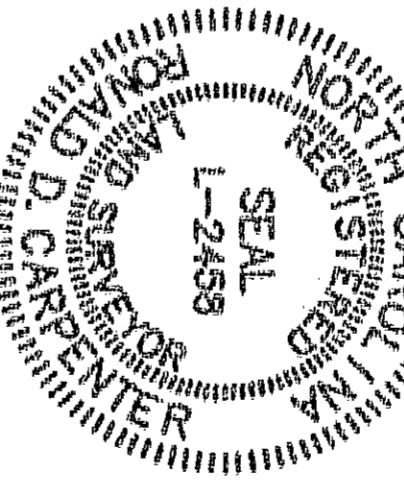
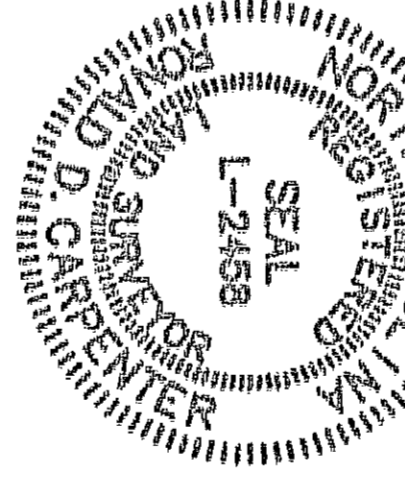
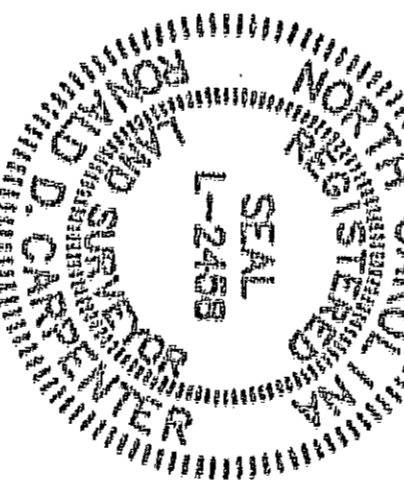
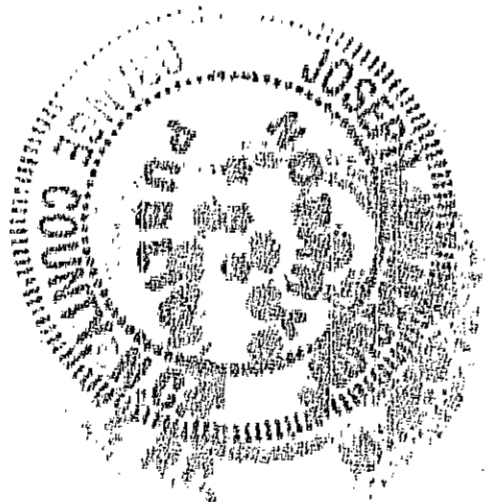
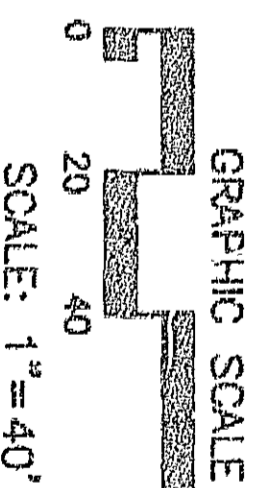

ZONING: G6
SETBACK REQ.:
FRONT 25'
SIDES ADJACENT TO RESIDENTIAL 25'
REAR 10'

NOTE: NO N.C. GRID CORNER RECOVERED WITHIN 2000'.

FINAL PLAT FOR

3300 UNITED PARTNERSHIP

CITY OUT TOWNSHIP, DURHAM COUNTY, NORTH CAROLINA

Orange Surveyors logo and contact information: 3325 Chapel Hill Blvd., Suite 230, Durham, NC 27707-2646, (919) 490-2929, Date: 10/2/98, Scale: 1"=40', Job No: 95219.02, Revisions:

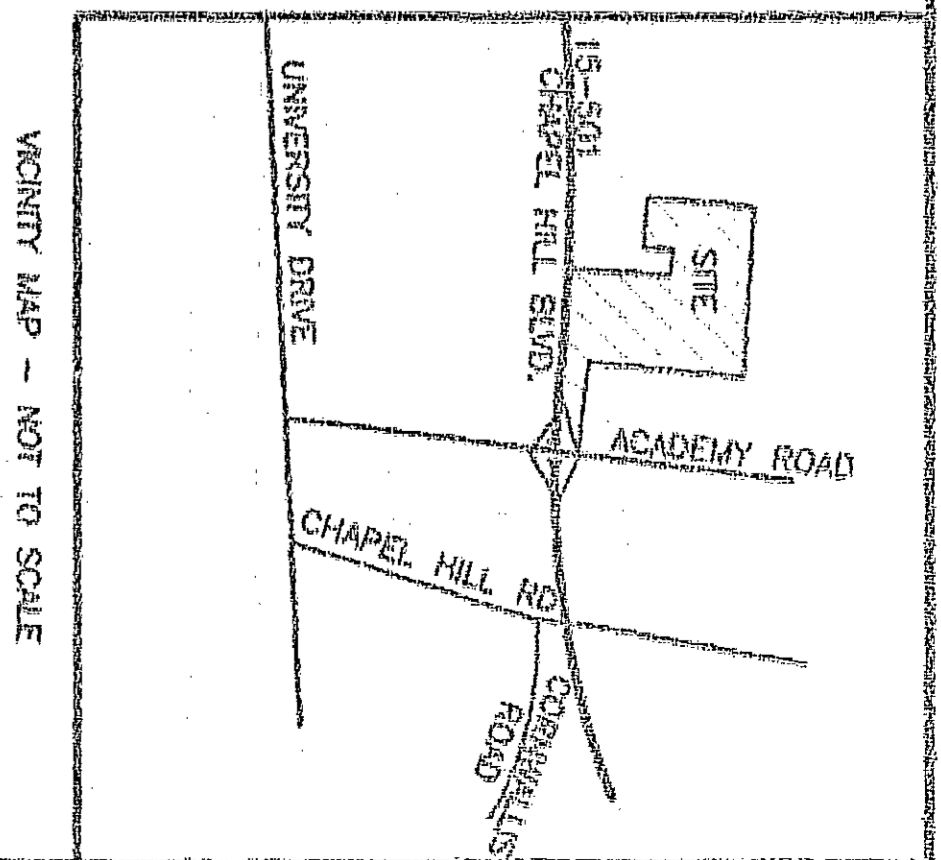

I, RONALD D. CARPENTER, CERTIFY THAT THIS SURVEY CREATES A RECONSTRUCTION OF LAND WITHIN THE BOUNDARIES OF A COUNTY OR MUNICIPALITY THAT HAS AN ORDINANCE THAT REGULATES PARCELS OF LAND. I HAVE BEEN A REGISTERED LAND SURVEYOR SINCE OCTOBER 19 95 AND SEAL THIS 8 DAY OF OCTOBER 19 98

I, RONALD D. CARPENTER, CERTIFY THAT THIS MAP WAS DRAWN UNDER MY SUPERVISION FROM AN ORIGINAL SURVEY MADE BY ME OR UNDER MY SUPERVISION. I HAVE BEEN A REGISTERED LAND SURVEYOR SINCE OCTOBER 19 95 AND SEAL THIS 8 DAY OF OCTOBER 19 98

I, RONALD D. CARPENTER, DO HEREBY CERTIFY THAT THE ATTACHED MAP AND SUBDIVISION HEREBY CERTIFIES THAT HE/SHE ORDERED THE WORK OF SURVEYING AND PLATING DONE AND THAT ALL PUBLIC AND PRIVATE STREETS, EASEMENTS AND OTHER AREAS SHOWN ON THIS MAP AND PLAT ARE CORRECTLY LOCATED AND SHOWN AS SHOWN ON THIS MAP AND PLAT ARE CORRECT IN ALL RESPECTS. WITNESS MY HAND AND SEAL THIS 8 DAY OF OCTOBER 19 98

I, JUDY F. HOSTFORD, REVIEWER/ OFFICER OF DURHAM COUNTY, CERTIFY THAT THE MAP OR PLAT TO WHICH THIS CERTIFICATION IS AFFIXED MEETS ALL STATUTORY REQUIREMENTS FOR RECORDING. I, JUDY F. HOSTFORD, REVIEWER/ OFFICER OF DURHAM COUNTY, CERTIFY THAT THE MAP OR PLAT TO WHICH THIS CERTIFICATION IS AFFIXED MEETS ALL STATUTORY REQUIREMENTS FOR RECORDING.