

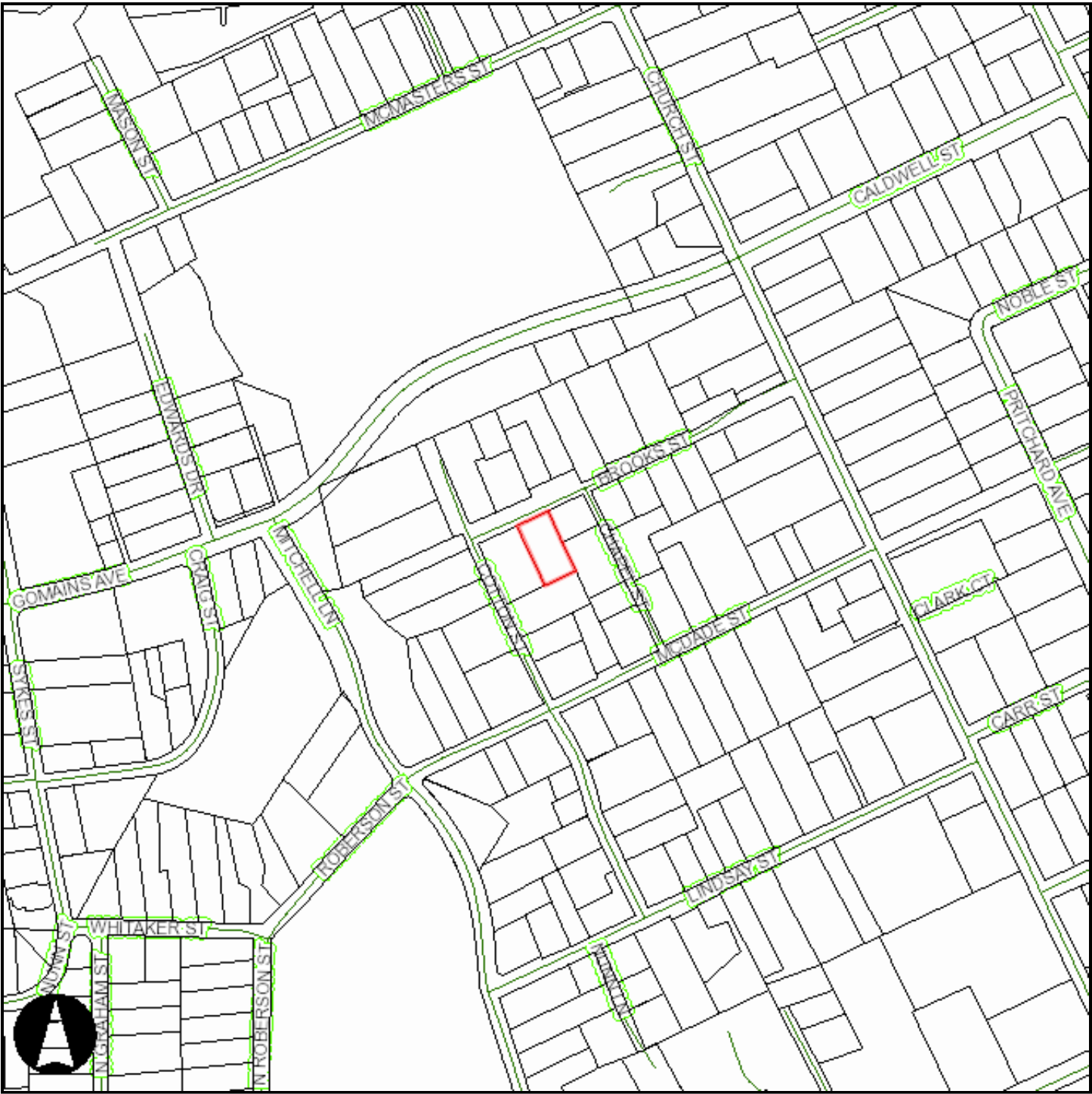

Orange County, NC GIS



1 inch = 300 feet

Search Results (1)

shape	ESRI.ArcGIS.ADF.Web.Geometry.Polygon
PIN	9788184159
PINSTATUS	ACTIVE
OWNER_TYPE	
IOFLAG	
OWNER1_LAST	PERKINS & SONS LLC

OWNER1_FIRST	
OWNER2_LAST	
OWNER2_FIRST	
ADDRESS1	609 LAKESHORE DR
ADDRESS2	
CITY	CHAPEL HILL
STATE	NC
ZIPCODE	27514
TOWNSHIP	7
SIZE	1
UOM	L
CALC_ACRES	0.2
SUBCODE	
LEGAL_DESC	S/S BROOKS ST
RATECODE	22
SCHOOL_SYSTEM	Chapel Hill/Carrboro Schools
LANDVALUE	60500
BLDGVALUE	241400
BLDGCNT	1
VALUATION	301900
TAXSTATUS	A1
FARMUSE	
USEVALUE	0
DEEDREF	5832/1
LEGALREF	
DATESOLD	8/11/2014 12:00:00 AM
TAXSTAMPS	1359
STAMPVALUE	679500
SUBDIVISION_NAME	
TOWNSHIP_NAME	CHAPEL HILL
SQFT	3632
YEARBUILT	1945
SHAPE.fid	6208283
shape.area	8501.99212683273