

# DURHAM PROPERTY RECORD SEARCH

159526  
314 MULDEE ST

**CURRENT**  
CENTRAL AVENUE PROPERTIES LLC  
314 MULDEE ST  
DURHAM, NC, 27703

Total Assessed Value  
**\$651,186**

## KEY INFORMATION

Tax District	CNTY-DRHM/CITY-DRHM	PIN	0841-05-07-9881
Account	8233131	Neighborhood	C841A
Land Use Code	440	Land Use Desc	COM/ WHSE-STORAGE
Subdiv Code	0000	Subdiv Desc	N/A - NO SUBDIVISION
Deed Book & Page	008719 / 000203	Plat Book & Page:	000124 / 000030
Last Sale Date:	08/02/2019	Last Sale Price:	\$1,050,000
Jan 1st Owner:	HOLLOWAY PAMELA L		
Legal Description:	PROP-LAWS HARLAN-STEVE LA WS/LT#01B PT		

## ASSESSMENT DETAILS

Land Fair Market Value	\$114,800
Improvement Fair Market Value	\$536,386
Total Fair Market Value	\$651,186

## RESIDENTIAL BUILDING (1)

Assessed Total Improvement Value **\$536,386**

Year Built:	1987	Built Use / Ranch	STORAGE WAREHOUSES
Current Use	STORAGE WAREHOUSES	Percent Complete:	100%
Heated Area (S/F):	15,069	Full Bathroom(s):	0
Half Bathroom(s):	0	Bedroom(s):	0
Fireplace (Y/N):	N	Basement (Y/N):	N
Basement Unfinished:	-	Basement Finished:	-
Basement Partially Finished:	-	Attached Garage (Y/N):	N
Assessed Building Value:	\$536,386		

## LAND DETAILS

Land Fair Market Value (FMV)	Land Assessed Value	Mapped Acres
\$114,800	\$114,800	1.148

## SALES

Sales Date	Sale Price
08/02/2019	1,050,000

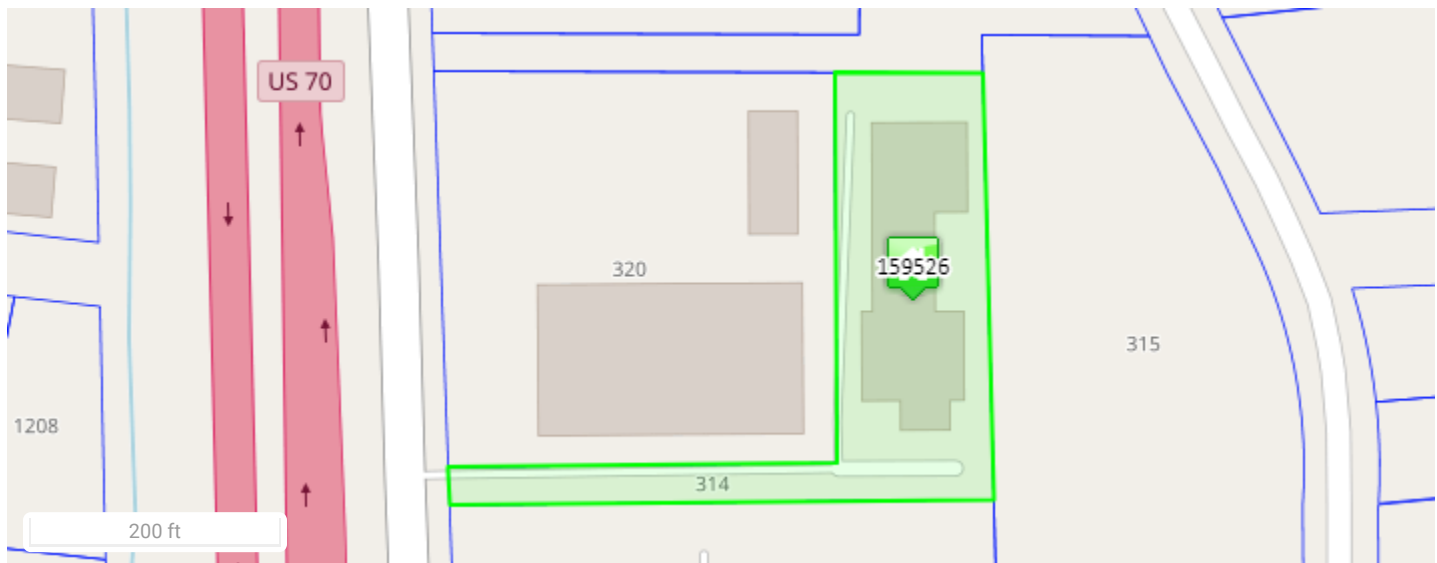

# DURHAM PROPERTY RECORD SEARCH

219633  
MULDEE ST

**CURRENT**  
CENTRAL AVENUE PROPERTIES LLC  
314 MULDEE ST  
DURHAM, NC, 27703

Total Assessed Value  
**\$23,400**

## KEY INFORMATION

Tax District	CNTY-DRHM/CITY-DRHM	PIN	0841-05-08-8016
Account	8630131	Neighborhood	C841A
Land Use Code	440	Land Use Desc	COM/ WHSE-STORAGE
Subdiv Code	0000	Subdiv Desc	N/A - NO SUBDIVISION
Deed Book & Page	008719 / 000203	Plat Book & Page:	000195 / 000334
Last Sale Date:	08/02/2019	Last Sale Price:	\$1,050,000
Jan 1st Owner:	HOLLOWAY PAMELA L, HOLLOWAY TIM		
Legal Description:	PROP-HOLLOWAY PAMELA L & HOLLOWAY TIM/PT DELANO ST		

## ASSESSMENT DETAILS

Land Fair Market Value	\$23,400
Improvement Fair Market Value	\$0
Total Fair Market Value	\$23,400

## RESIDENTIAL BUILDING (1)

Assessed Total Improvement Value **\$0**

Year Built:	-	Built Use / Ranch	-
Current Use	-	Percent Complete:	0%
Heated Area (S/F):	-	Full Bathroom(s):	0
Half Bathroom(s):	0	Bedroom(s):	0
Fireplace (Y/N):	N	Basement (Y/N):	N
Basement Unfinished:	-	Basement Finished:	-
Basement Partially Finished:	-	Attached Garage (Y/N):	N
Assessed Building Value:	\$0		

## LAND DETAILS

Land Fair Market Value (FMV)	Land Assessed Value	Mapped Acres
\$23,400	\$23,400	0.234

## SALES

Sales Date	Sale Price
08/02/2019	1,050,000
03/18/2016	36,000

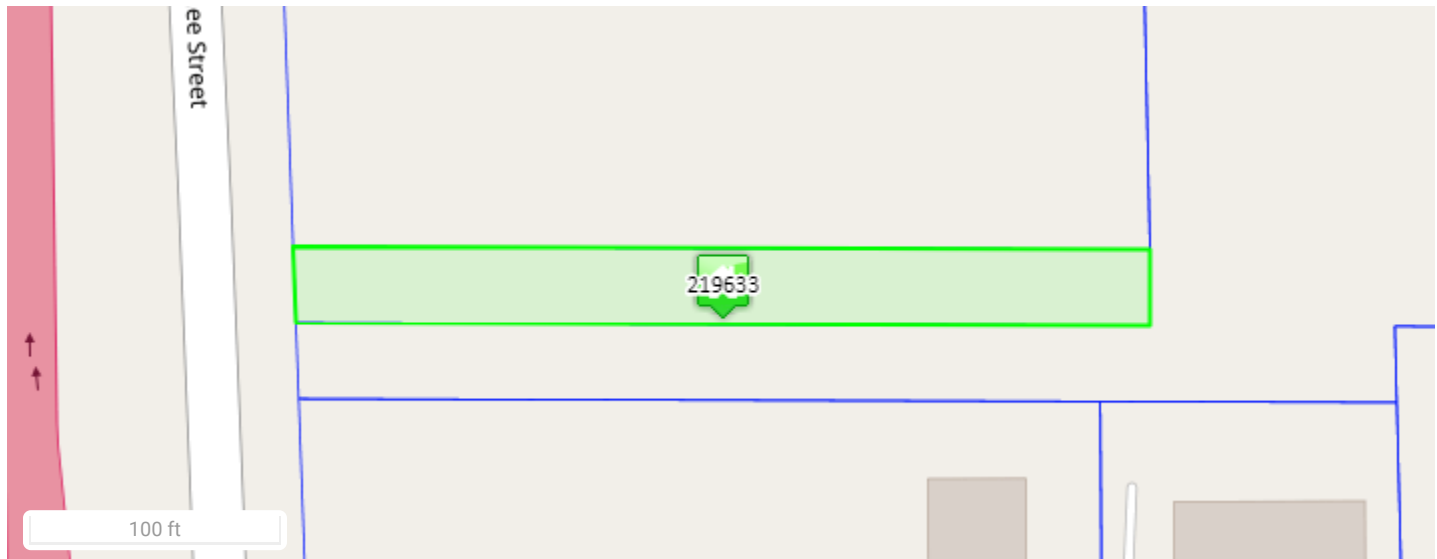

# DURHAM PROPERTY RECORD SEARCH

161136  
411 SOUTHERLAND ST

**CURRENT**  
CENTRAL AVENUE PROPERTIES LLC  
2527 HOOT OWL DR  
HILLSBOROUGH, NC, 27278

Total Assessed Value  
**\$68,375**

## KEY INFORMATION

Tax District	CNTY-DRHM/CITY-DRHM	PIN	0841-05-18-0137
Account	8618648	Neighborhood	C841A
Land Use Code	311	Land Use Desc	VAC RES/ LOT-SML TRACT
Subdiv Code	0000	Subdiv Desc	N/A - NO SUBDIVISION
Deed Book & Page	008719 / 000203	Plat Book & Page:	000195 / 000334
Last Sale Date:	08/02/2019	Last Sale Price:	\$1,050,000
Jan 1st Owner:	HOLLOWAY HOLDINGS LLC		
Legal Description:	PROP-HOLLOWAY PAMELA L & HOLLOWAY TIM		

## ASSESSMENT DETAILS

Land Fair Market Value	\$68,375
Improvement Fair Market Value	\$0
Total Fair Market Value	\$68,375

## RESIDENTIAL BUILDING (1)

Assessed Total Improvement Value **\$0**

Year Built:	-	Built Use / Ranch	-
Current Use	-	Percent Complete:	0%
Heated Area (S/F):	-	Full Bathroom(s):	0
Half Bathroom(s):	0	Bedroom(s):	0
Fireplace (Y/N):	N	Basement (Y/N):	N
Basement Unfinished:	-	Basement Finished:	-
Basement Partially Finished:	-	Attached Garage (Y/N):	N
Assessed Building Value:	\$0		

## LAND DETAILS

Land Fair Market Value (FMV)	Land Assessed Value	Mapped Acres
\$68,375	\$68,375	1.735

## SALES

Sales Date	Sale Price
08/02/2019	1,050,000
04/23/1999	67,000

