

PERSONALLY APPEARED BEFORE ME THIS DAY AND ACKNOWLEDGED THE EXECUTION OF THE FOREGOING CERTIFICATE. WITNESS MY HAND AND OFFICIAL SEAL THIS THE 16th DAY OF June, 2015. 2016

Sharon P. Watkins
 NOTARY PUBLIC

MY COMMISSION EXPIRES:
March 4, 2021

Sharon P. Watkins
 NOTARY PUBLIC

MY COMMISSION EXPIRES:
March 4, 2021



WETLAND BUFFER NOTE

25' WIDE WETLAND BUFFER TO REMAIN IN NATURAL, UNDISTURBED VEGETATION. WETLAND BUFFERS MAY BE USED FOR PASSIVE RECREATIONAL ACTIVITIES, SUCH AS WALKING AND BICYCLING TRAILS, PROVIDED THAT SERVICE FACILITIES FOR SUCH ACTIVITIES, INCLUDING BUT NOT LIMITED TO PARKING, PICNICKING AND SANITARY FACILITIES, ARE LOCATED OUTSIDE OF THE WETLAND BUFFER. ANY USE ALLOWED BY THIS SECTION SHALL BE DESIGNED AND CONSTRUCTED TO MINIMIZE THE AMOUNT OF INTRUSION INTO THE WETLAND BUFFER AND TO MINIMIZE CLEARING, GRADING, EROSION AND WATER QUALITY DEGRADATION (UDO SECTIONS 8.9)

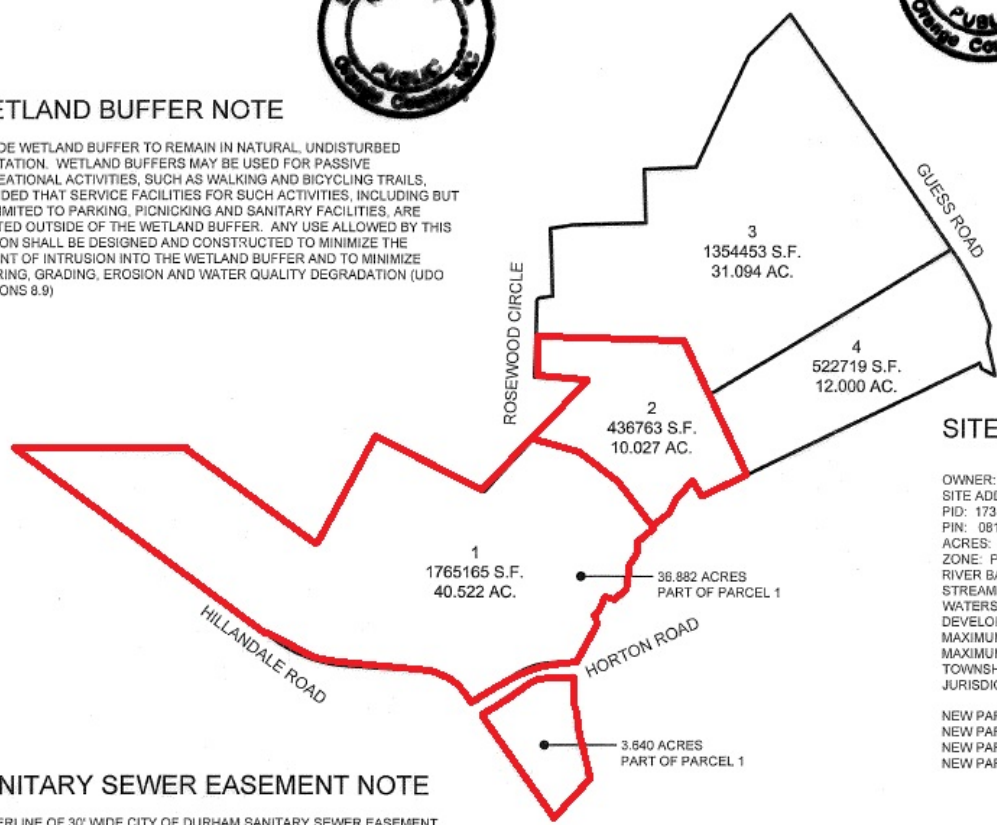

SITE DATA TABLE

OWNER: LAKEFIELD FARM LLC
 SITE ADDRESS: 3871, 3865 GUESS RD
 PID: 173135, 173136
 PIN: 0814-05-90-0968, 0814-05-90-7536
 ACRES: 88.474, 25.169 (PER DEED)
 ZONE: PDR 2.000, RS-M(D)
 RIVER BASIN: NEUSE
 STREAM BASIN: ENO
 WATERSHED: E-B
 DEVELOPMENT TIER: SUBURBAN
 MAXIMUM IMPERVIOUS LIMIT = 24% (LOW DENSITY OPTION)
 MAXIMUM IMPERVIOUS LIMIT = 70 % (HIGH DENSITY OPTION)
 TOWNSHIP: DURHAM
 JURISDICTION: CITY OF DURHAM

NEW PARCEL 1	40.522 ACRES (36.882AC + 3.640AC)
NEW PARCEL 2	10.027 ACRES
NEW PARCEL 3	31.094 ACRES
NEW PARCEL 4	12.000 ACRES

SANITARY SEWER EASEMENT NOTE

CENTERLINE OF 30' WIDE CITY OF DURHAM SANITARY SEWER EASEMENT. SUBJECT TO TERMS STATED IN THE DECLARATION IN REAL ESTATE BOOK 1510, PAGE 958. NO STRUCTURES, FILL, EMBANKMENTS, TREES OR OBSTRUCTIONS PERMITTED WITHIN THE EASEMENT EXCEPT ACCORDING TO THOSE TERMS.

CENTERLINE OF 30' WIDE COUNTY OF DURHAM SANITARY SEWER EASEMENT. SUBJECT TO TERMS STATED IN THE DECLARATION IN REAL ESTATE BOOK 1626, PAGE 145. NO STRUCTURES, FILL, EMBANKMENTS, TREES OR OBSTRUCTIONS PERMITTED WITHIN THE EASEMENT EXCEPT ACCORDING TO THOSE TERMS.

OVERALL SITE MAP
 NEW PROPOSED PARCELS

