

RESEARCH TRIANGLE PARK
PROPERTY OF THE PINELAND COMPANY INC.
WAKE AND DURHAM COUNTIES
CEDAR FORK TOWNSHIPS
NORTH CAROLINA

SCALE 1" = 500'
 DATE 5 JAN 1961
 REGISTERED ENGINEER
 1 OF 2

NOTICE TO ALL PARTIES INTERESTED IN TITLE TO PROPERTY SHOWN:
 I HEREBY CERTIFY THAT I AM A CIVIL ENGINEER, LICENSED TO PRACTICE IN NORTH CAROLINA AND THAT THIS SURVEY PREPARED TO THE BEST OF MY KNOWLEDGE AND BELIEF AND WAS PREPARED FROM AN ACTUAL SURVEY MADE BY ME IN 1951. DISTANCES SHOWN WERE CALCULATED FROM MEASURED ANGLES AND ARE BASED ON THE PLANE COMPUTATION SYSTEM OF NORTH CAROLINA. THERE ARE NO UNCORRECTED CURVATURES SHOWN ON THIS SURVEY UNLESS OTHERWISE INDICATED.

REVISION: September 30, 1965
 Interim Properties Not Acquired by Pinhook Co.
 Properties transferred by Pinhook Co. to others
 Properties transferred by Research Triangle Foundation to Research Triangle Institute
 Revisions to original map were made to show property changes since original recording. This map is correct to my best knowledge and belief and was compiled from actual field surveys.
 Properties lands not owned by Pinhook Co.
 James F. Bandy
 E 2 035 000

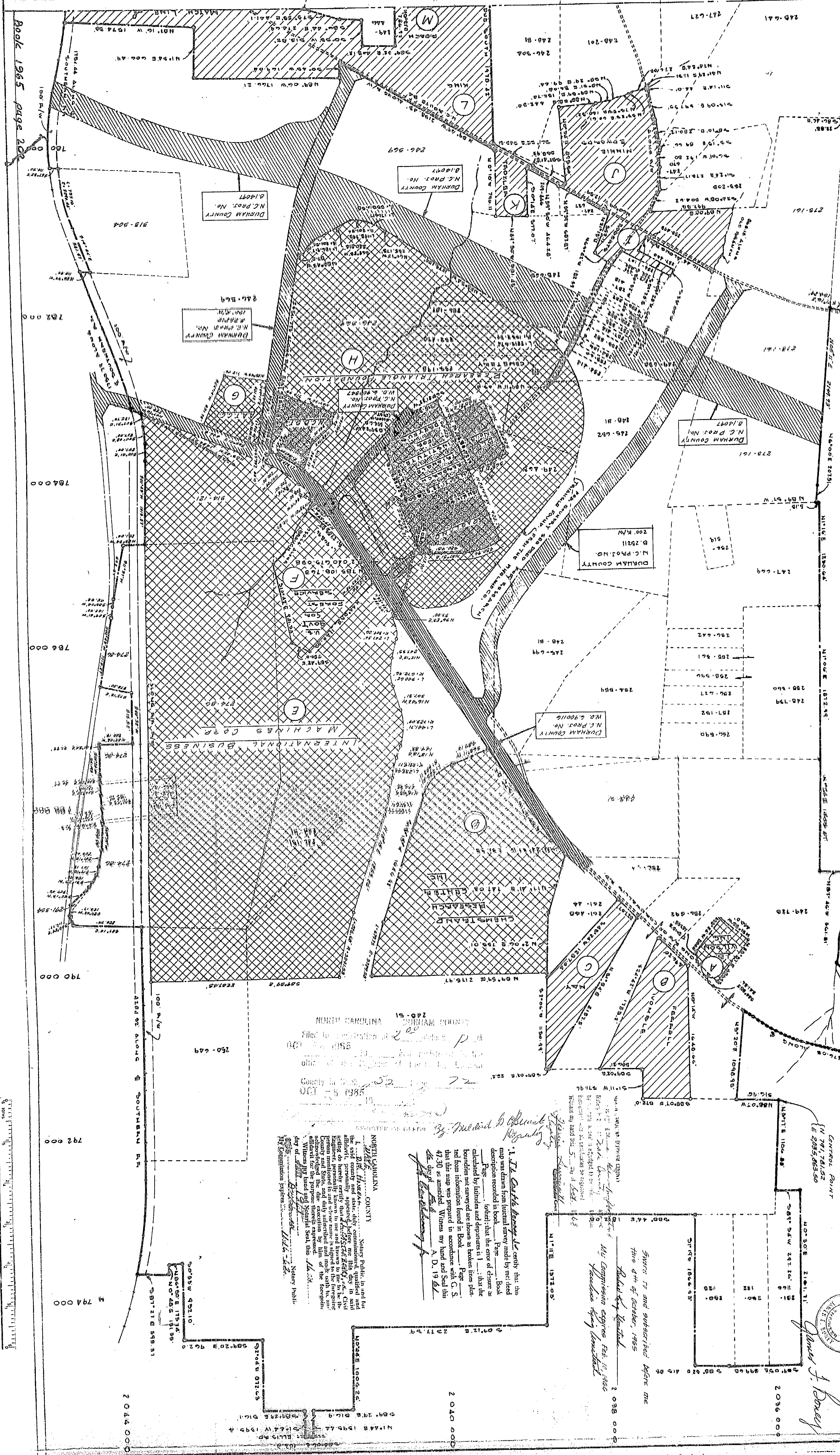

Book 1965 page 20

Scale 1" = 500'

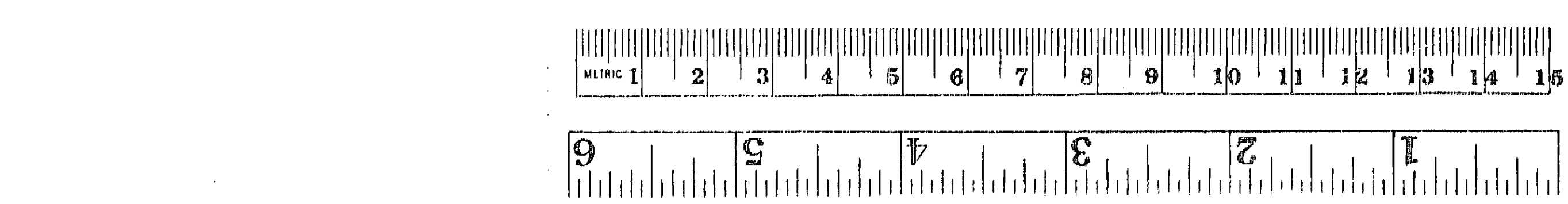

NORTH CAROLINA COUNTY RECORD
 Filed for recording at 2:20 PM
 OCT 19 1965
 County of Wake
 204-500

1. I, *James F. Bandy*, certify that the map was drawn from actual survey made by me and description recorded in book *1965-204-500* of the county records. I further certify that the area of change calculated by latitude and departure is *1.00* and that the boundaries not surveyed are shown as broken lines and that from information found in Book *1965-204-500* of the county records that the map was prepared in accordance with G.S. 42-30 as amended. Witness my hand and seal this *19* day of *October*, 1965.

James F. Bandy
 E 2 035 000

NORTH CAROLINA COUNTY RECORD
 Filed for recording at 2:20 PM
 OCT 19 1965
 County of Wake
 204-500

52-72

BK

52

PG

72