

Orange County North Carolina

259940
301 N COLUMBIA ST

JANUARY 1ST OWNER MAILING ADDRESS
BAUCOM CAROLYN
719 CASWELL RD
CHAPEL HILL NC 27514

Total Assessed Value
\$433,100

KEY INFORMATION

Tax Year	2022		
Parcel ID	9788279921	Township	7 - CHAPEL HILL
Land Size	0.19	Land Units	AC
Rate Code	22		
District Codes	G0 County, CH CHSchoolDst., G2 Chapel Hill		
Property LUC	Residential- Improved		
Neighborhood	CH13 - 7NCOLUMBIAS		
Legal Description	34-35 BL D W N PRITCHARD P2/78 W/S COLUMBIA ST		
Exempt Type	-		

APPRAISAL DETAILS

Total Land	\$333,000
Ag Credit	-
Land	\$333,000
Building	\$100,100
Yard Items	\$0
Market Total	\$433,100
Total Assessed	\$433,100

RESIDENTIAL

BUILDING (1)					
Type	Single Fam	Total Value	\$100,100	Finished Sq Ft	1,083 sf
Style	-	Quality	Grade C-05	Condition	Average
Year Built	1920	Exterior Walls	Frame	Full Bath	1
Roof Cover	Shingle	Half Bath	0	HVAC	Combo H&A
Bedrooms	2	Garage Type	-		

MISC IMPROVEMENTS

IMPROVEMENT TYPE	UNITS/SQ FT	EST YEAR BUILT	APPRAISED VALUE
No items to display			

SALES

SALE DATE	SALE PRICE	DEED BOOK	DEED PAGE	INSTRUMENT TYPE	GRANTOR
08/06/2002	\$139,500	2668	572		BAUCOM PROPERTIES
03/20/1992	\$0	973	590		BAUCOM PROPERTIES
02/11/1985	\$47,500	502	323		HRABAK

YARD ITEMS

DESCRIPTION	TOTAL UNITS	YEAR BUILT	LENGTH	WIDTH	HEIGHT
-------------	-------------	------------	--------	-------	--------

No items to display

LAND

UNIT / SOIL TYPE	DESCRIPTION	USE CODE	ACRES / LOTS	VALUE
------------------	-------------	----------	--------------	-------

SF	Square Ft	SECONDARY	8325	\$333,000
----	-----------	-----------	------	-----------

VALUE HISTORY

YEAR	TOTAL MARKET VALUE
------	--------------------

2022	\$433,100
2021	\$433,100
2020	\$381,100
2019	\$381,100
2018	\$381,100
2017	\$381,100
2016	\$402,514
2015	\$402,514
2014	\$402,514
2013	\$402,514
2012	\$402,514

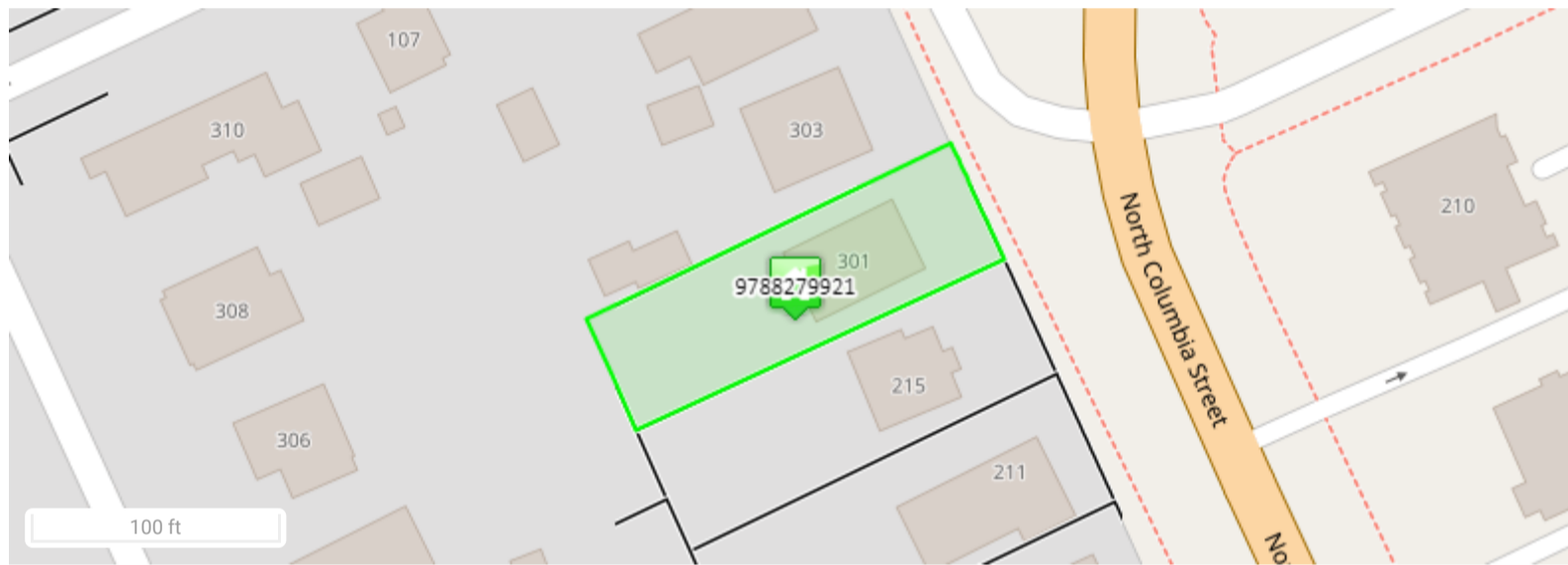

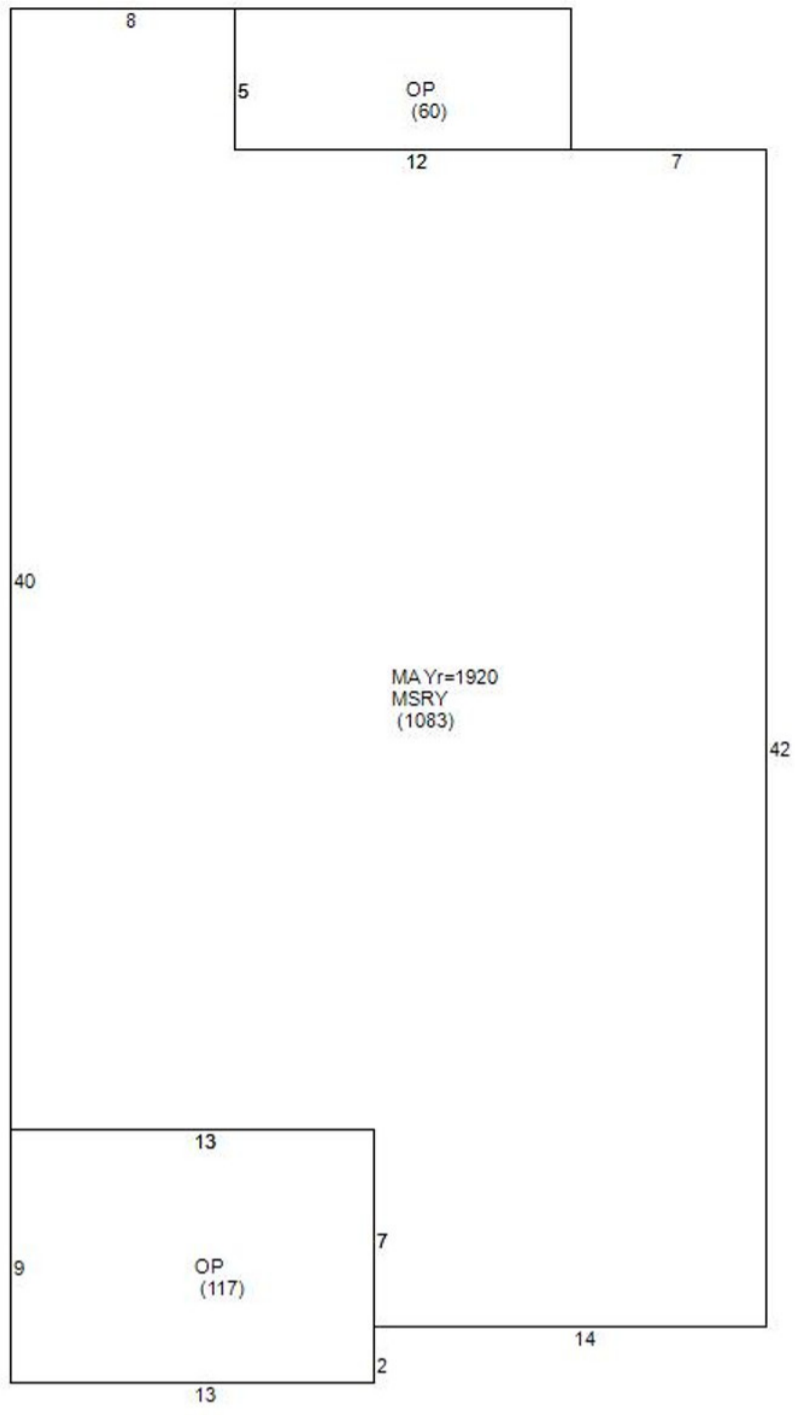

Disclaimer

Orange County Assessor's Office makes every effort to produce the most accurate information possible. **No warranties, expressed or implied, are provided for the data herein, its use or interpretation.**