

Orange County North Carolina

222288  
2524 OLD NC 86

**MAILING ADDRESS**  
DANIEL JACOB B  
320 W CORBIN ST  
HILLSBOROUGH NC 27278

Total Assessed Value  
**\$167,200**

KEY INFORMATION

Tax Year	<b>2022</b>		
Parcel ID	<b>9873053777</b>	Township	<b>4 - HILLSBOROUGH</b>
Land Size	<b>0.63</b>	Land Units	<b>AC</b>
Rate Code	<b>00</b>		
District Codes	<b>FA Orange FD, G0 County</b>		
Property LUC	<b>Residential- Improved</b>		
Neighborhood	<b>4409 - 4OAKDALE</b>		
Legal Description	<b>3 BOBBY R ROBERTS</b>		
Exempt Type	<b>-</b>		

APPRAISAL DETAILS

Total Land	<b>\$102,300</b>
Ag Credit	<b>-</b>
Land	<b>\$102,300</b>
Building	<b>\$64,900</b>
Yard Items	<b>\$0</b>
Market Total	<b>\$167,200</b>
Total Assessed	<b>\$167,200</b>

RESIDENTIAL

BUILDING (1)					
Type	<b>Single Fam</b>	Total Value	<b>\$64,900</b>	Finished Sq Ft	<b>936 sf</b>
Style	<b>-</b>	Quality	<b>Grade C</b>	Condition	<b>Average</b>
Year Built	<b>1956</b>	Exterior Walls	<b>Frame</b>	Full Bath	<b>1</b>
Roof Cover	<b>Shingle</b>	Half Bath	<b>0</b>	HVAC	<b>Flr/WI Furn</b>
Bedrooms	<b>2</b>	Garage Type	<b>-</b>		

MISC IMPROVEMENTS

IMPROVEMENT TYPE	UNITS/SQ FT	EST YEAR BUILT	APPRAISED VALUE
No items to display			

SALES

SALE DATE	SALE PRICE	DEED BOOK	DEED PAGE	INSTRUMENT TYPE	GRANTOR
12/15/2017	\$60,000	6402	251		BROWN
11/22/2015	\$0	-	-		BROWN
04/03/1998	\$30,000	1711	148		BONDURANT
04/03/1998	\$30,000	1711	148		BONDURANT RUSSELL

## YARD ITEMS

DESCRIPTION	TOTAL UNITS	YEAR BUILT	LENGTH	WIDTH	HEIGHT
No items to display					

## LAND

UNIT / SOIL TYPE	DESCRIPTION	USE CODE	ACRES / LOTS	VALUE
C_AC	Com Acres	SITE	0.62	\$102,300

## VALUE HISTORY

YEAR	TOTAL MARKET VALUE
2022	\$167,200
2021	\$167,200
2020	\$150,700
2019	\$150,700
2018	\$150,700
2017	\$150,700
2016	\$143,548
2015	\$143,548
2014	\$143,548
2013	\$143,548
2012	\$143,548



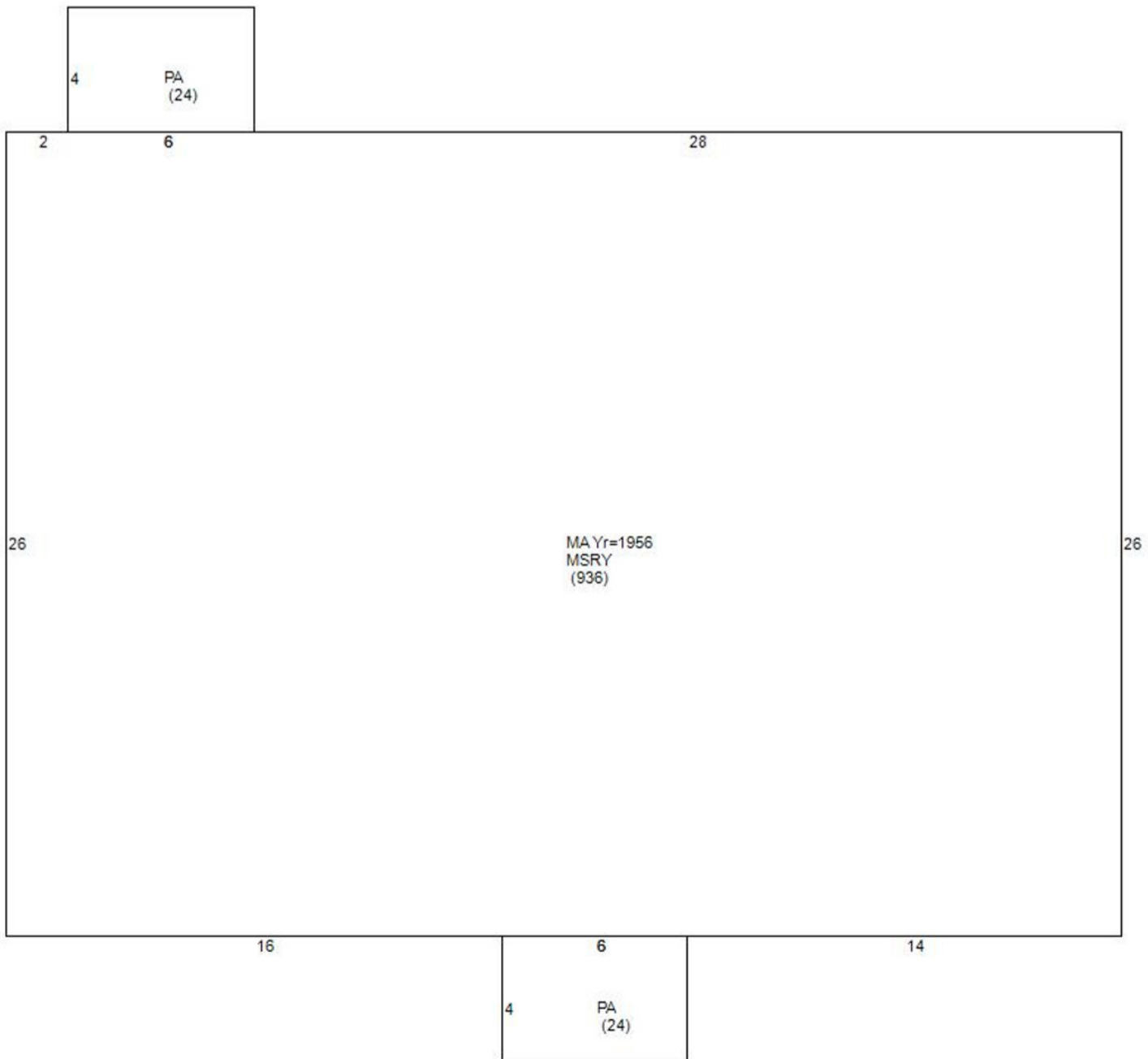
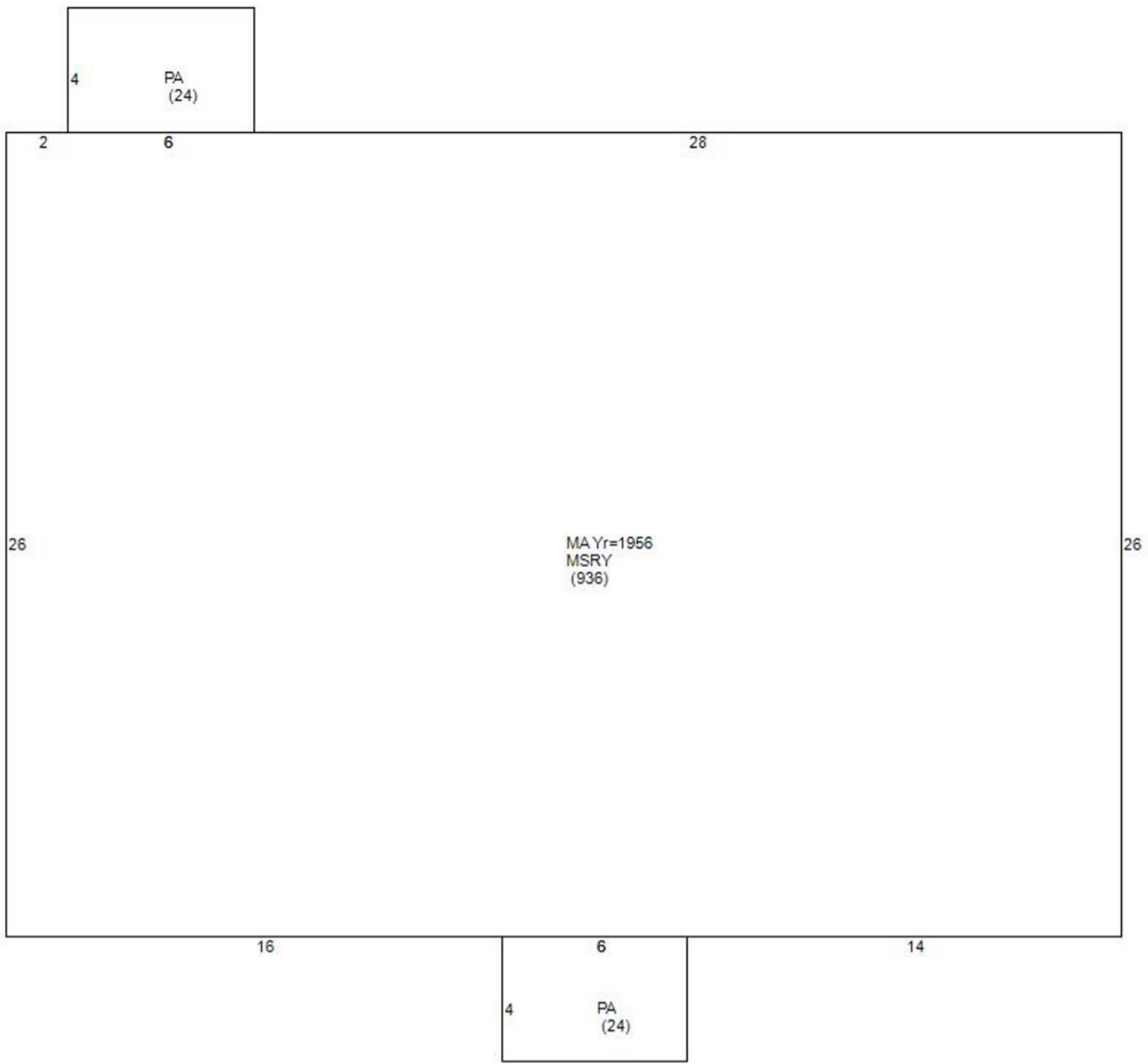

Orange County Assessor's Office makes every effort to produce the most accurate information possible. **No warranties, expressed or implied, are provided for the data herein, its use or interpretation.**