

Durham County, NC
Assessor of Property

Property Record Card

Vacant Lot

no mcs

Owner Name

HABITAT FOR HUMANITY OF DURHAM
INC

JO

K&E Properties, LLC

Owner Address

C/O KAREN DIXON HODGES-MANAGER
763 MALCOLM AVE
LOS ANGELES, CA
90024

Location Address

2309 LONG ST

*10-16 BBS Permit
\$100,452 SFR.*

GENERAL PROPERTY INFORMATION

Parcel Ref No: 114220
PIN: 0831-15-74-2166
Account No: 302600
Tax District: CNTY-DRHM/CITY-DRHM
Land Use Code: 311
Land Use Desc: VAC RES/ LOT-SML
TRACT
Subdiv Code: 0000
Subdiv Desc: N/A - NO SUBDIVISION
Neighborhood: 036RE

Legal Description: PROP-FONVILLE
JAMES M
Deed Book & Page: 7927 / 748
Plat Book & Page: 00003A / 000007
Last Sale Date: May-11-2016
Last Sale Price: \$15,000 ✓
Property Tax Appraisal: \$14,675 *

* The appraised value is the
estimated value as of the last
general reappraisal, effective
January 1, 2016

R4-S(2) zone

Year Built: 0
Built Use / Style:
Current Use:
*Percent Complete: 0%
Heated Area (S/F): 0
** Bathroom(s): 0 Full Bath(s) 0 Half
Bath(s)
** Bedroom(s): 0
Fireplace (Y/N): N
Basement (Y/N): N
Attached Garage (Y/N): N
Multiple Improvements: 0

Land Market Value: \$14,675
Land Present Use Value: \$14,675
Land Total Assessed Value: \$14,675
Building Value: \$-
Map Acres: 0.174

Appraised Improvement
Values

\$-
Appraised Value as of January
1, 2016

* Note - As of January 1

** Note - Bedroom(s), shown for description only

Data Disclaimer: All data shown here is from other primary data sources and is public information. Users of the data are hereby notified that the aforementioned public information sources should be consulted for verification of the information contained on this website. While efforts have been made to use the most current and accurate data, Durham County, NC and data providers assume no legal responsibility for the use of the data contained herein.

Please direct any questions or comments about the data displayed here to tax_assessor@dconc.gov (mailto:tax_assessor@dconc.gov)

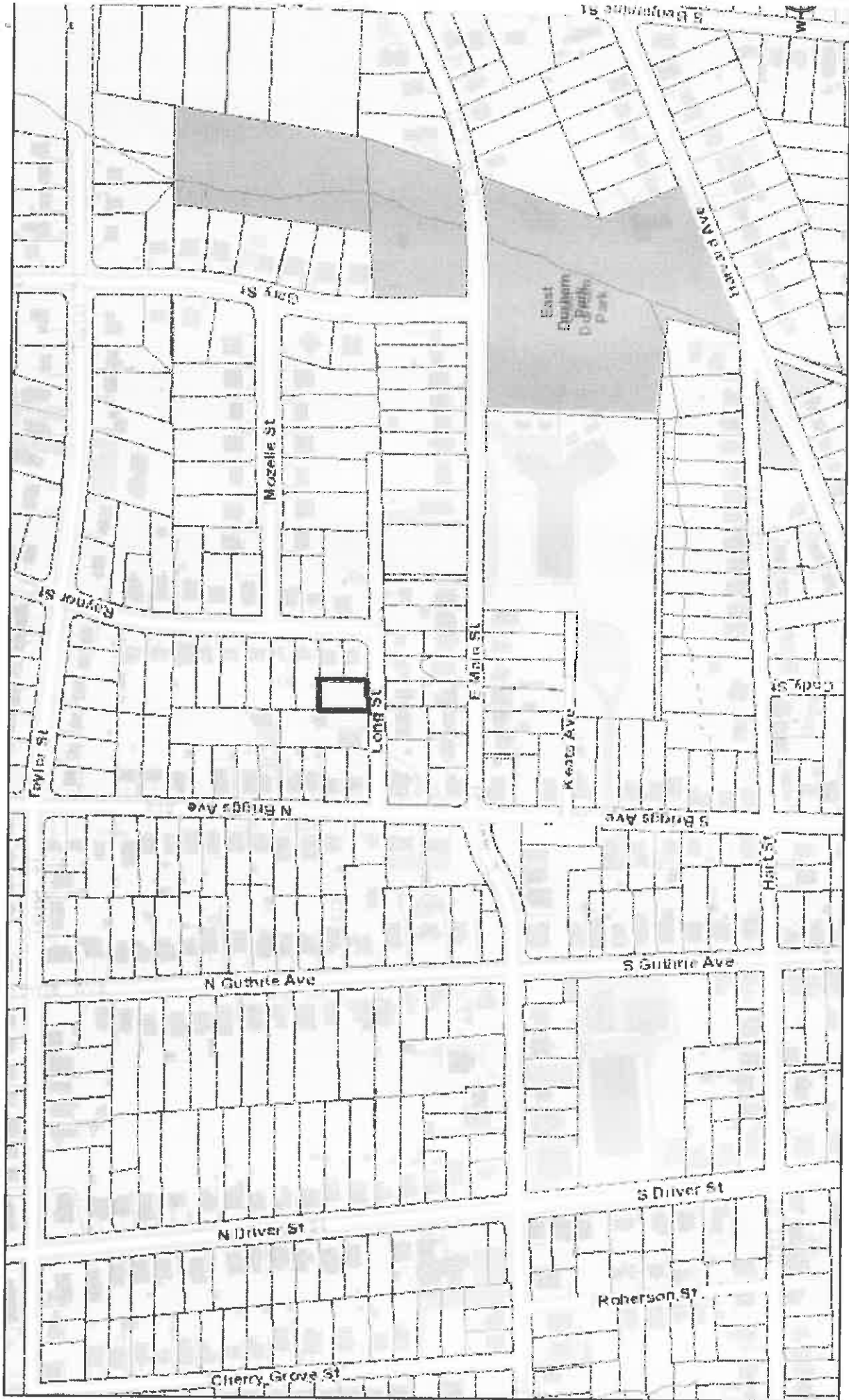

October 24, 2016

1:4,514

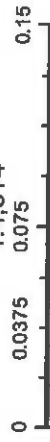

Sources: Esri, HERE, DeLorme, USGS, Intermap, INCREMENT P, Japan, NICTD, Esri China (Hong Kong), Esri Korea, Esri (Thailand), I NGCC, © OpenStreetMap contributors, and the GIS User Community

Information depicted hereon is for reference purposes only and is compiled from the best available sources. The City of Durham/Durham County assumes no responsibility for errors arising from use or misuse