

Orange County

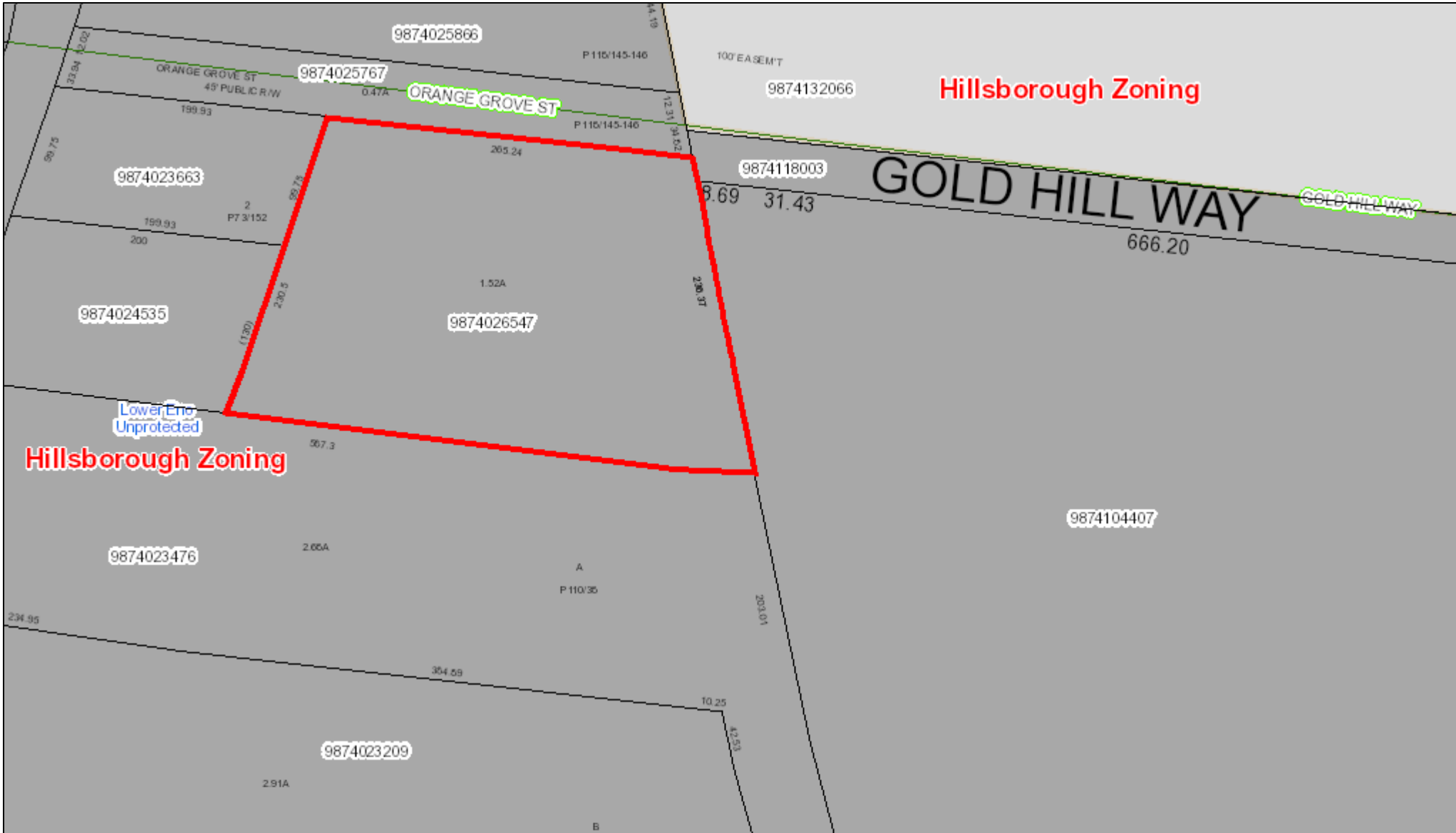

December 6, 2021 This map contains parcels prepared for the inventory of real property within Orange County, and is compiled from recorded deed, plats, and other public records and data. Users of this map are hereby notified that the aforementioned public primary information sources should be consulted for verification of the information contained on this map.

The county and its mapping companies assume no legal responsibility for the information on this map.

PIN: 9874026547
 OWNER 1: GATES WARREN M
 OWNER 2:
 ADDRESS 1: 226 ORANGE GROVE ST
 ADDRESS 2:
 CITY: HILLSBOROUGH
 STATE, ZIP: NC 272782175
 LEGAL DESC: E/O 1009

SIZE: 1.52 A
 DEED REF: 643/468
 RATECODE: 23
 TOWNSHIP: HILLSBOROUGH
 BLDG SQFT: 22246
 YEAR BUILT: 1969

BUILDING COUNT: 3
 LAND VALUE: \$778,200
 BLDG_VALUE: \$484,700
 USE VALUE: \$0
 TOTAL VALUE: \$1,262,900
 DATE SOLD: 03/31/1987
 TAX STAMPS: 0

