

Orange County North Carolina

299221  
200 REDMAN CROSSING

**MAILING ADDRESS** REDMANRHINO LLC  
200 REDMAN CROSSING  
MEBANE NC 27302

Total Assessed Value  
**\$3,911,200**

**KEY INFORMATION**

Tax Year	2022		
Parcel ID	9834987376	Township	3 - CHEEKS
Land Size	9.90	Land Units	AC
Rate Code	03		
District Codes	G0 County, FB Efland FD		
Property LUC	Offices, Banks and Medical-Improved		
Neighborhood	3009 - 3INDUSTE		
Legal Description	N/O I-85		
Exempt Type	-		

**APPRAISAL DETAILS**

Total Land	\$436,600
Ag Credit	-
Land	\$436,600
Building	\$3,241,500
Yard Items	\$233,100
Market Total	\$3,911,200
Total Assessed	<b>\$3,911,200</b>

**RESIDENTIAL**

BUILDING (1)					
Type	Office	Total Value	<b>\$528,200</b>	Finished Sq Ft	<b>5,900 sf</b>
Style	-	Quality	<b>Grade C</b>	Condition	<b>Average</b>
Year Built	<b>1971</b>	Exterior Walls		Full Bath	<b>0</b>
Roof Cover		Half Bath	<b>0</b>	HVAC	
Bedrooms	-	Garage Type	-		

BUILDING (2)					

**MISC IMPROVEMENTS**

IMPROVEMENT TYPE	UNITS/SQ FT	EST YEAR BUILT	APPRAISED VALUE
FENCING WIRE	2300	1980	\$11,500
PAVING ASPH	200000	1995	\$211,700
RR SIDING ST	450	1980	\$9,900

**SALES**

SALE DATE	SALE PRICE	DEED BOOK	DEED PAGE	INSTRUMENT TYPE	GRANTOR
05/21/2007	\$1,810,000	4286	153		BARBER & ROSS
05/21/2007	\$1,810,000	4286	153		BARBER & ROSS COMPANY
09/07/1999	\$0	1985	289		MEBANE CITY
05/26/1998	\$0	1736	115		INDUSTRIAL DEVELOPMENT CORP
05/26/1998	\$0	1736	115		INDUSTRIAL DEVELOPMENT
02/25/1972	\$8,000	233	1616		REDMAN HOMES
08/20/1971	\$2,000	230	1940		-
06/30/1971	\$9,000	230	185		-

## YARD ITEMS

DESCRIPTION	TOTAL UNITS	YEAR BUILT	LENGTH	WIDTH	HEIGHT
No items to display					

## LAND

UNIT / SOIL TYPE	DESCRIPTION	USE CODE	ACRES / LOTS	VALUE
C_AC	Com Acres	SITE	9.9	\$436,600

## VALUE HISTORY

YEAR	TOTAL MARKET VALUE
2022	\$3,911,200
2021	\$3,911,200
2020	\$2,542,000
2019	\$2,542,000
2018	\$2,542,000
2017	\$2,542,000
2016	\$1,959,120
2015	\$1,959,120
2014	\$1,959,120
2013	\$1,959,120
2012	\$1,959,120

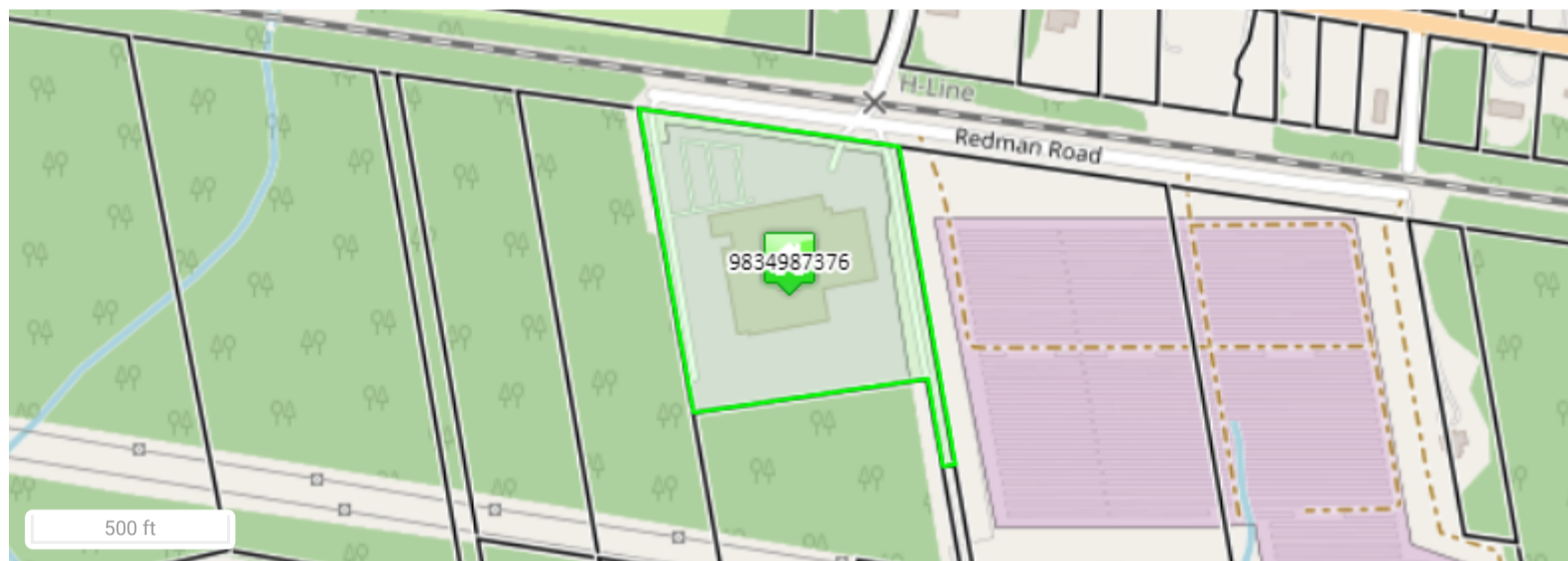

**Orange County North Carolina**

296876

**MAILING ADDRESS** REDMANRHINO LLC  
200 REDMAN CROSSING  
MEBANE NC 27302

Total Assessed Value  
**\$1**

**KEY INFORMATION**

Tax Year	<b>2022</b>		
Parcel ID	<b>9844073762</b>	Township	<b>3 - CHEEKS</b>
Land Size	<b>0.18</b>	Land Units	<b>AC</b>
Rate Code	<b>03</b>		
District Codes	<b>FB Efland FD, G0 County</b>		
Property LUC	<b>Common Area, Streets, Open Space-Unimproved</b>		
Neighborhood	<b>3009 - 3INDUSTE</b>		
Legal Description	<b>P/O ALLEY P93/41</b>		
Exempt Type	<b>-</b>		

**APPRAISAL DETAILS**

Total Land	-
Ag Credit	-
Land	<b>\$1</b>
Building	-
Yard Items	-
Market Total	-
Total Assessed	<b>\$1</b>

**RESIDENTIAL**

No building data to display.

**MISC IMPROVEMENTS**

IMPROVEMENT TYPE	UNITS/SQ FT	EST YEAR BUILT	APPRAISED VALUE
No items to display			

**SALES**

SALE DATE	SALE PRICE	DEED BOOK	DEED PAGE	INSTRUMENT TYPE	GRANTOR
05/15/2014	\$0	5789	588		ALDERMAN
03/28/2007	\$0	172	147		-

**YARD ITEMS**

DESCRIPTION	TOTAL UNITS	YEAR BUILT	LENGTH	WIDTH	HEIGHT
No items to display					

**LAND**

UNIT / SOIL TYPE	DESCRIPTION	USE CODE	ACRES / LOTS	VALUE
AC_9	Acres Type 9	SITE	0.18	-

**VALUE HISTORY**

YEAR	TOTAL MARKET VALUE
2022	\$1
2021	\$1
2020	\$1
2019	\$1
2018	\$1
2017	\$1
2016	\$1
2015	\$1
2014	\$1
2013	\$1
2012	\$1

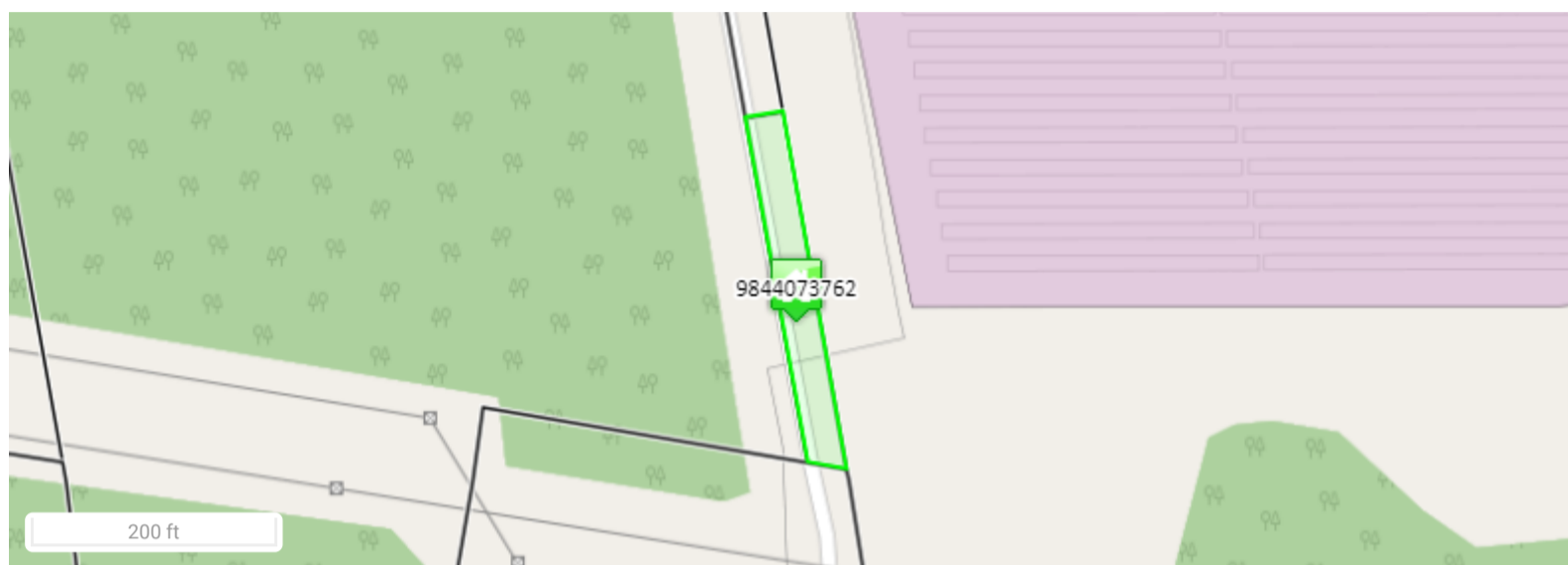

No Photo Available



---

#### Disclaimer

Orange County Assessor's Office makes every effort to produce the most accurate information possible. **No warranties, expressed or implied, are provided for the data herein, its use or interpretation.**

Orange County North Carolina

299222

**MAILING ADDRESS** REDMANRHINO LLC  
200 REDMAN CROSSING  
MEBANE NC 27302

Total Assessed Value  
**\$73,000**

**KEY INFORMATION**

Tax Year	2022		
Parcel ID	9834977555	Township	3 - CHEEKS
Land Size	9.10	Land Units	AC
Rate Code	03		
District Codes	FB Efland FD, G0 County		
Property LUC	Residential-Unimproved		
Neighborhood	3009 - 3INDUSTE		
Legal Description	N/S I/85		
Exempt Type	-		

**APPRAISAL DETAILS**

Total Land	\$73,000
Ag Credit	-
Land	\$73,000
Building	\$0
Yard Items	\$0
Market Total	\$73,000
Total Assessed	<b>\$73,000</b>

**RESIDENTIAL**

No building data to display.

**MISC IMPROVEMENTS**

IMPROVEMENT TYPE	UNITS/SQ FT	EST YEAR BUILT	APPRAISED VALUE
No items to display			

**SALES**

SALE DATE	SALE PRICE	DEED BOOK	DEED PAGE	INSTRUMENT TYPE	GRANTOR
05/21/2007	\$0	4286	153		BARBER & ROSS
09/08/2003	\$27,000	3188	271		REDMAN MOB HMS
09/08/2003	\$27,000	3188	275		BARBER & ROSS COMPANY
09/08/2003	\$27,000	3188	275		BARBER & ROSS COMPANY & REDMAN
03/01/1972	\$0	234	1076		-

**YARD ITEMS**

DESCRIPTION	TOTAL UNITS	YEAR BUILT	LENGTH	WIDTH	HEIGHT
No items to display					

**LAND**

UNIT / SOIL TYPE	DESCRIPTION	USE CODE	ACRES / LOTS	VALUE
AC_9	Acres Type 9	SITE	9.1	\$73,000

## VALUE HISTORY

YEAR	TOTAL MARKET VALUE
2022	\$73,000
2021	\$73,000
2020	\$73,000
2019	\$73,000
2018	\$73,000
2017	\$73,000
2016	\$58,593
2015	\$58,593
2014	\$58,593
2013	\$58,593
2012	\$58,593

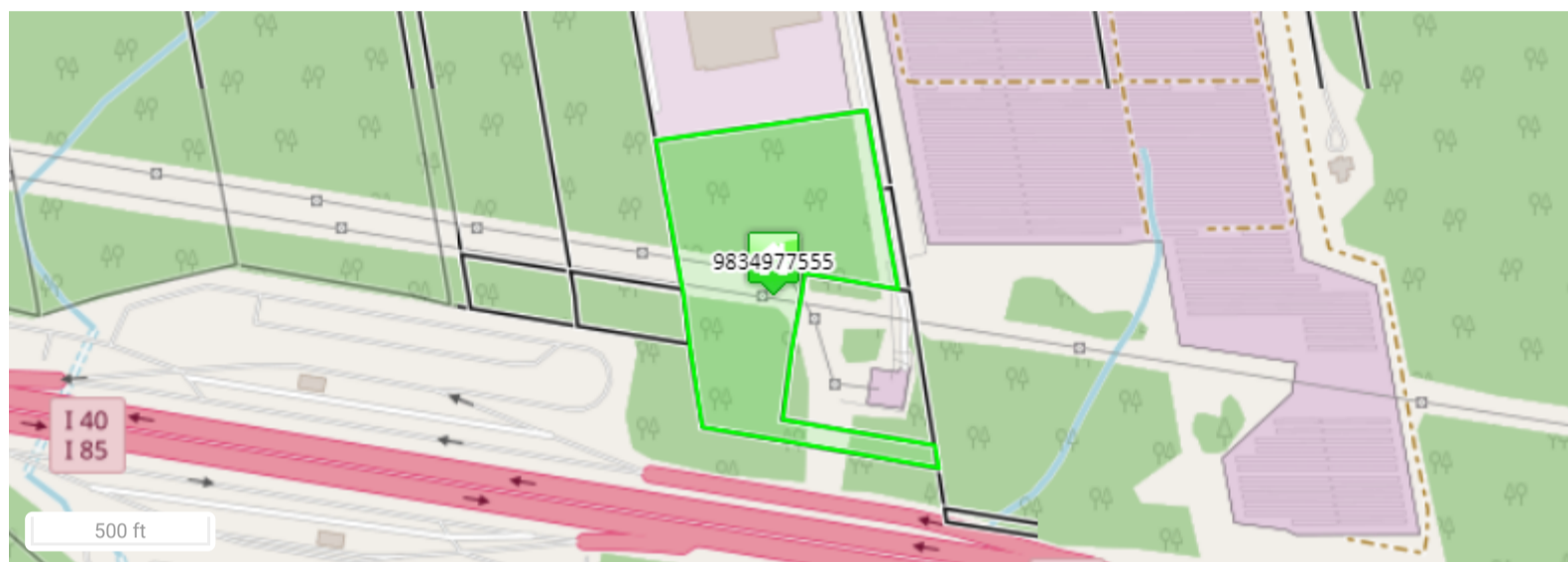

# No Photo Available



### Disclaimer

Orange County Assessor's Office makes every effort to produce the most accurate information possible. **No warranties, expressed or implied, are provided for the data herein, its use or interpretation.**