

Orange County North Carolina

235202

**MAILING ADDRESS**

TURNER WILLIAM KEITH, TURNER PAMELA B  
2400 HIGHLAND FARM RD  
HILLSBOROUGH NC 27278

Total Assessed Value

**\$258,600**

**KEY INFORMATION**

Tax Year	<b>2022</b>		
Parcel ID	<b>9874066903</b>	Township	<b>4 - HILLSBOROUGH</b>
Land Size	<b>0.16</b>	Land Units	<b>AC</b>
Rate Code	<b>23</b>		
District Codes	<b>G0 County, G3 Hillsborough</b>		
Property LUC	<b>Commercial, Retail, Shopping Centers, Restaurants,</b>		
Neighborhood	<b>H010 - N CHURTON</b>		
Legal Description	<b>NE INT CHURTON &amp; TRYON STS</b>		
Exempt Type	<b>-</b>		

**APPRAISAL DETAILS**

Total Land	<b>\$104,600</b>
Ag Credit	<b>-</b>
Land	<b>\$104,600</b>
Building	<b>\$150,800</b>
Yard Items	<b>\$3,200</b>
Market Total	<b>\$258,600</b>
Total Assessed	<b>\$258,600</b>

**RESIDENTIAL**

<b>BUILDING (1)</b>					
Type	<b>Retail Store</b>	Total Value	<b>\$110,900</b>	Finished Sq Ft	<b>1,267 sf</b>
Style	<b>-</b>	Quality	<b>Grade C</b>	Condition	<b>Average</b>
Year Built	<b>1950</b>	Exterior Walls		Full Bath	<b>0</b>
Roof Cover		Half Bath	<b>0</b>	HVAC	
Bedrooms	<b>-</b>	Garage Type	<b>-</b>		

<b>BUILDING (2)</b>					
---------------------	--	--	--	--	--

**MISC IMPROVEMENTS**

IMPROVEMENT TYPE	UNITS/SQ FT	EST YEAR BUILT	APPRAISED VALUE
PAVING	3000	1995	\$3,200
-	1	-	\$2,100

**SALES**

SALE DATE	SALE PRICE	DEED BOOK	DEED PAGE	INSTRUMENT TYPE	GRANTOR
01/21/2022	-	6765	1107		-
09/01/1999	\$175,000	1983	356		STRUM
09/01/1999	\$175,000	1983	356		STRUM MATTHEW

### YARD ITEMS

DESCRIPTION	TOTAL UNITS	YEAR BUILT	LENGTH	WIDTH	HEIGHT
No items to display					

### LAND

UNIT / SOIL TYPE	DESCRIPTION	USE CODE	ACRES / LOTS	VALUE
SF	Square Ft	PRIMARY	6975	\$104,600

### VALUE HISTORY

YEAR	TOTAL MARKET VALUE
2022	\$258,600
2021	\$258,600
2020	\$239,500
2019	\$239,500
2018	\$239,500
2017	\$239,500
2016	\$265,888
2015	\$265,888
2014	\$265,888
2013	\$265,888
2012	\$265,888



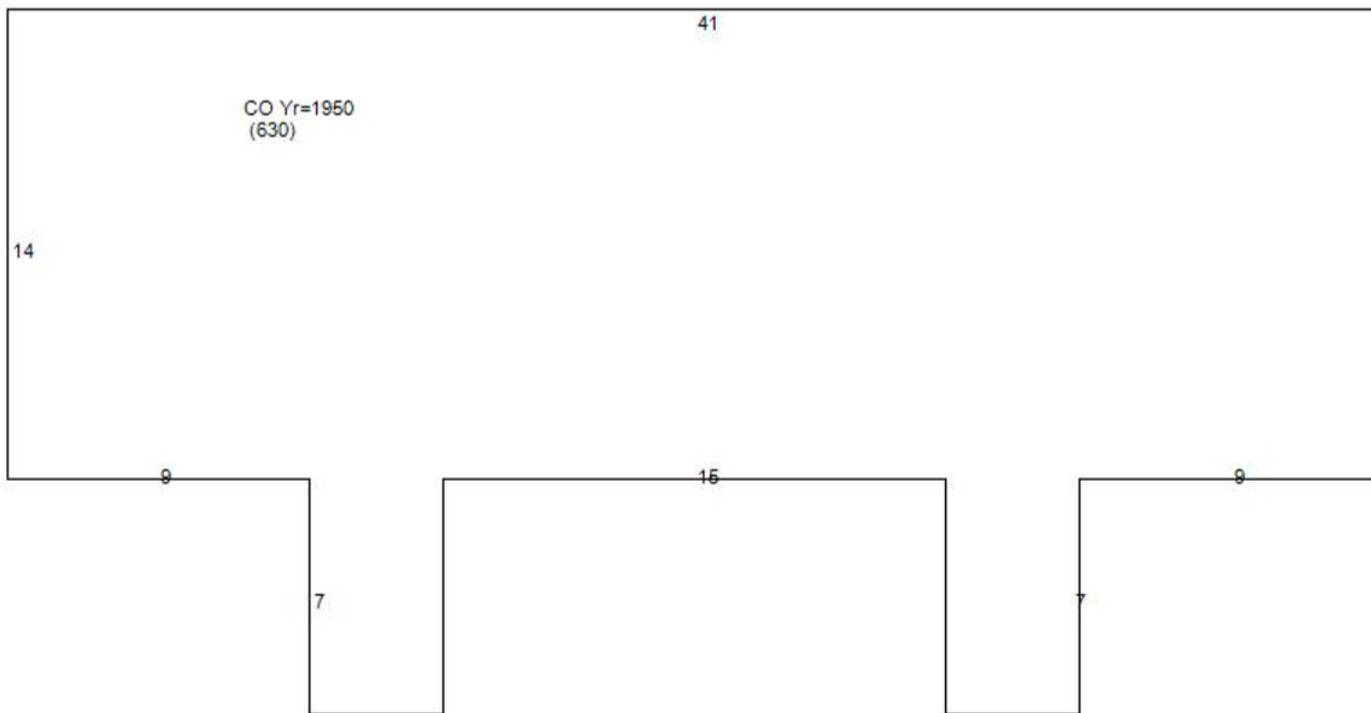
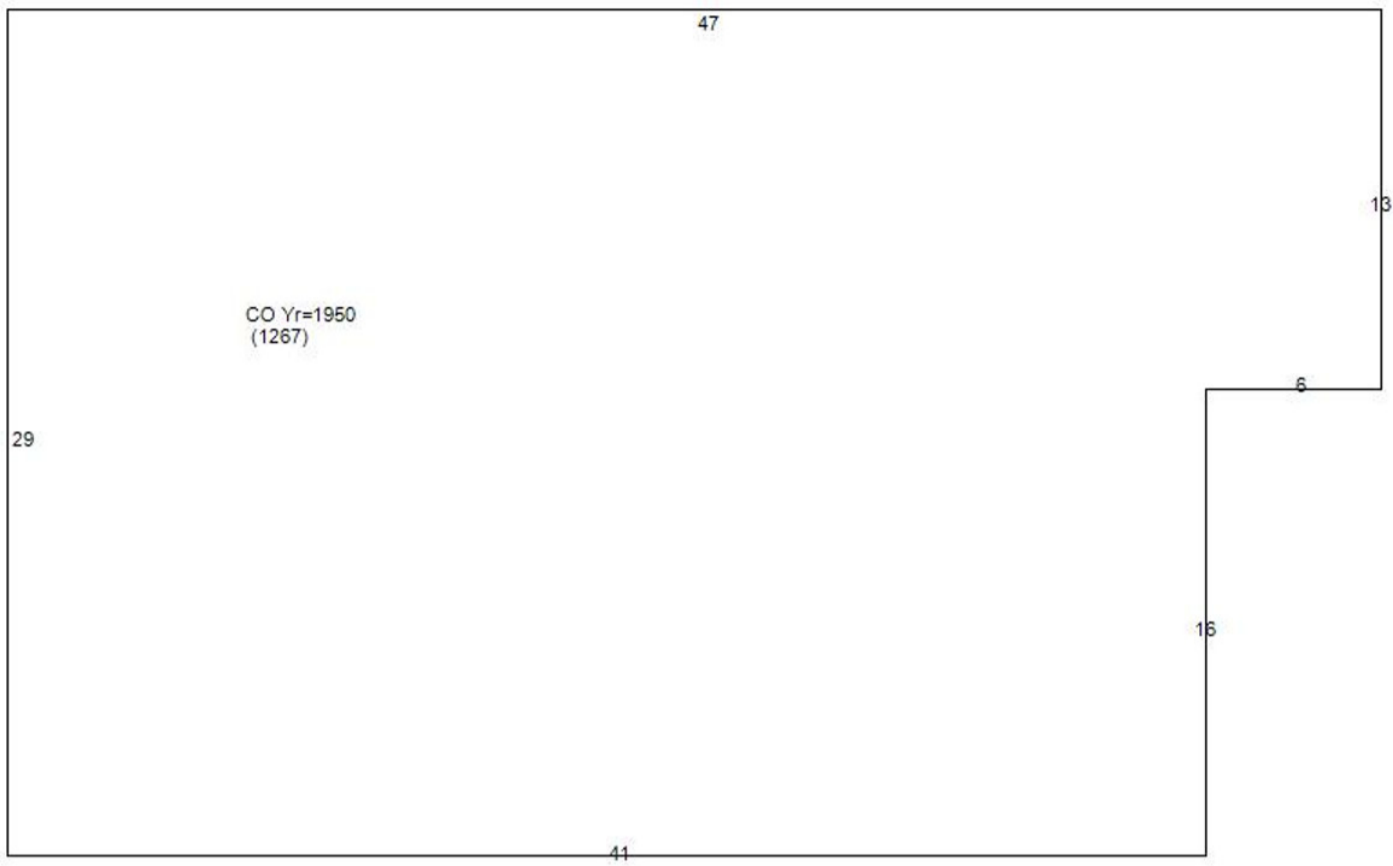

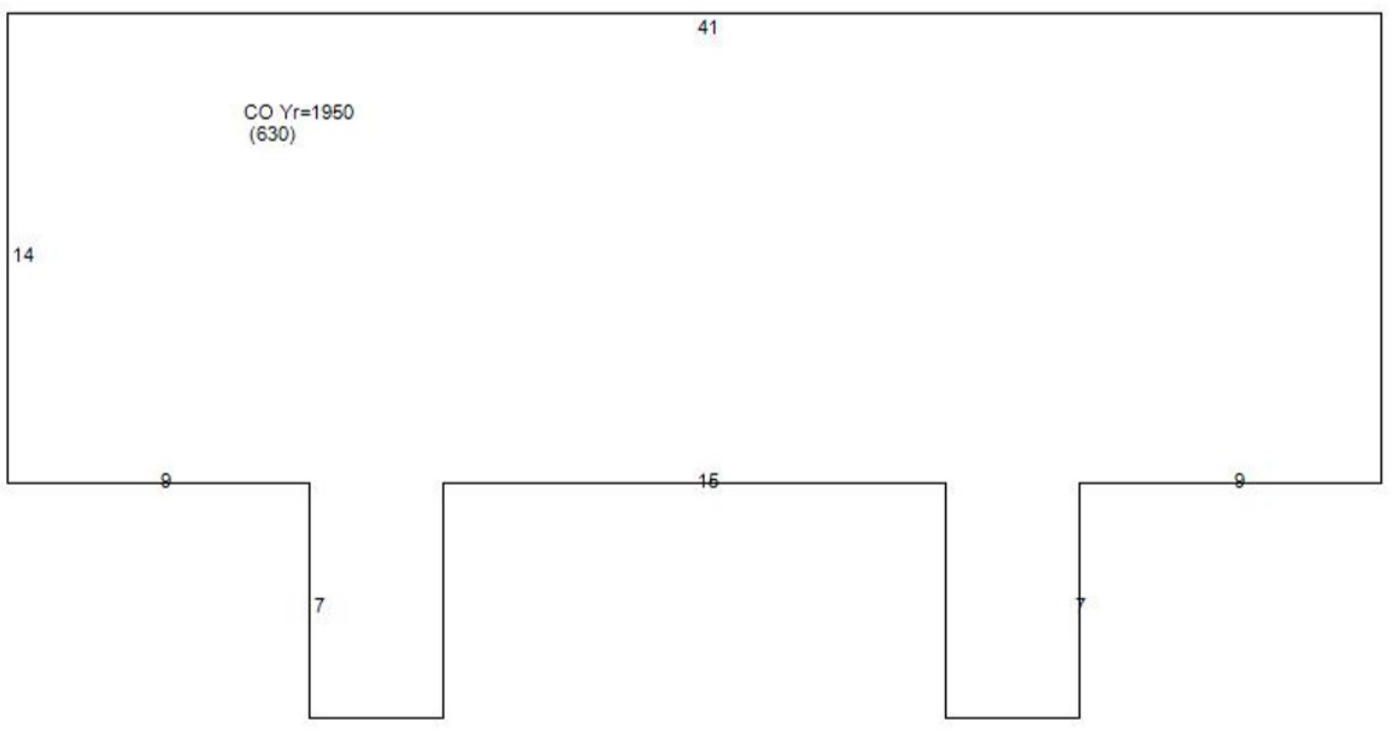
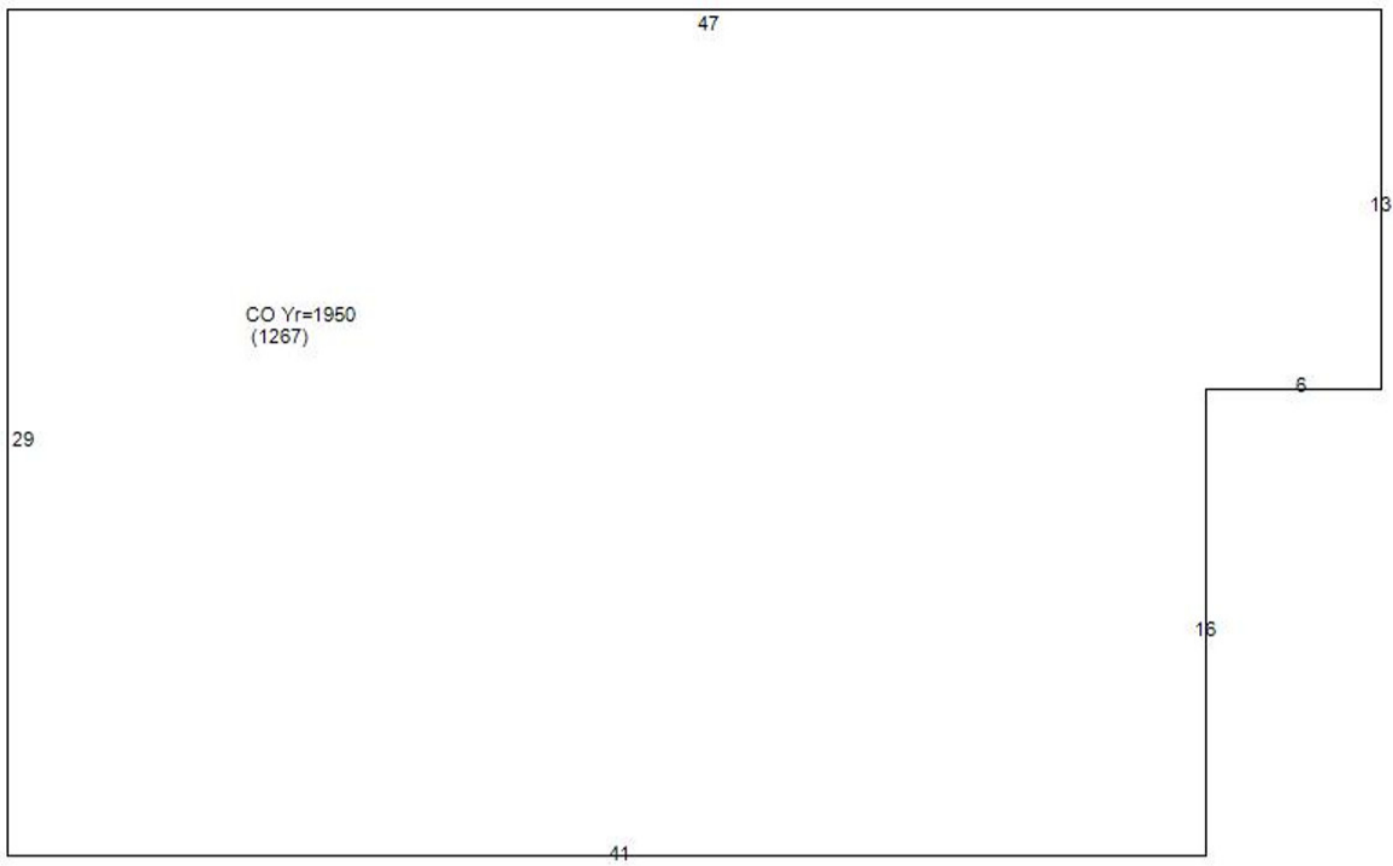

Orange County Assessor's Office makes every effort to produce the most accurate information possible. **No warranties, expressed or implied, are provided for the data herein, its use or interpretation.**