

306345

1775 DOBBINS DR

JANUARY 1ST OWNER MAILING ADDRESS

SUNTRUST BANK
PO BOX 26665
RICHMOND VA 23261

Total Assessed Value

\$864,000

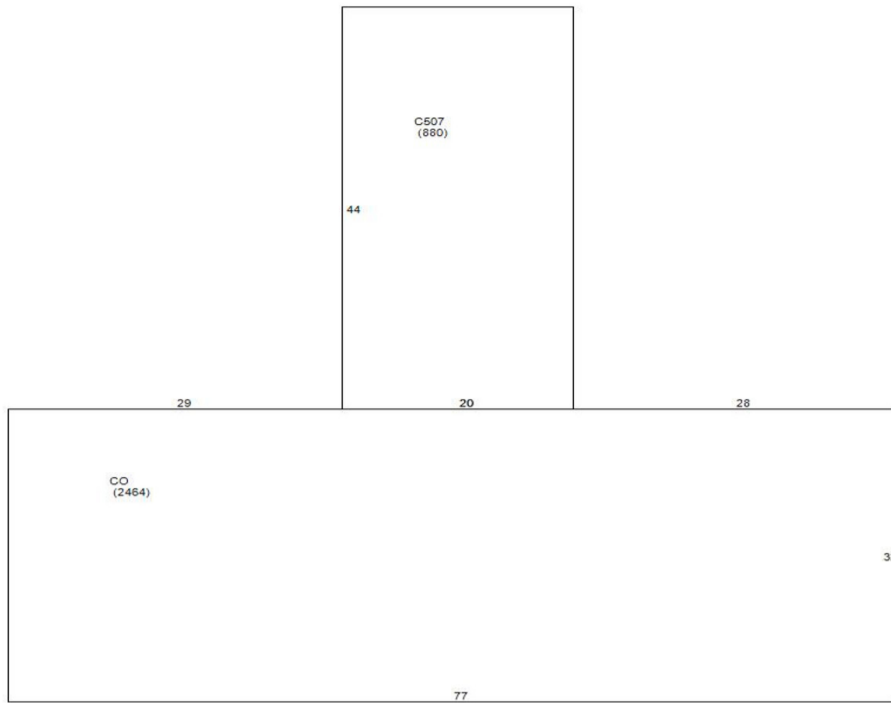

KEY INFORMATION

Tax Year	2022		
Parcel ID	9799589748	Township	7 - CHAPEL HILL
Land Size	0.92	Land Units	AC
Rate Code	22		
District Codes	CH CHSchoolDst., G2 Chapel Hill, G0 County		
Property LUC	Offices, Banks and Medical-Improved		
Neighborhood	L018 - 7FORDHAM		
Legal Description	2 & 3 JON S HARDER N/W INT 15-501 & SAGE RD		
Exempt Type	-		

APPRAISAL DETAILS

Total Land	\$683,800
Ag Credit	-
Land	\$683,800
Building	\$180,200
Yard Items	\$0
Market Total	\$864,000
Total Assessed	\$864,000

RESIDENTIAL

BUILDING (1)

Type	Bank-Branch	Total Value	\$180,200
Finished Sq Ft	2,464 sf	Style	-
Quality	Grade C-05	Condition	Average
Year Built	1980	Exterior Walls	
Full Bath	0	Roof Cover	
Half Bath	0	HVAC	
Bedrooms	-	Garage Type	-

MISC IMPROVEMENTS

IMPROVEMENT TYPE	UNITS/SQ FT	EST YEAR BUILT	APPRAISED VALUE
No items to display			

SALES

SALE DATE	SALE PRICE	DEED BOOK	DEED PAGE	INSTRUMENT TYPE	GRANTOR
03/20/2017	\$836,000	6277	24		NATIONAL RETAIL PROPERTIES LP
06/26/2013	\$990,000	5638	221		INLAND AMERICAN ST PORTFOLIO V
04/17/2008	\$924,000	4504	455		CENTRAL CAROLINA
04/17/2008	\$924,000	4504	455		CENTRAL CAROLINA BANK
01/01/1980	\$0	398	477		PAGE

YARD ITEMS

DESCRIPTION	TOTAL UNITS	YEAR BUILT	LENGTH	WIDTH	HEIGHT
No items to display					

LAND

UNIT / SOIL TYPE	DESCRIPTION	USE CODE	ACRES / LOTS	VALUE
SF	Square Ft	SITE	39990	\$683,800

VALUE HISTORY

YEAR	TOTAL MARKET VALUE
2022	\$864,000
2021	\$864,000
2020	\$996,200
2019	\$996,200
2018	\$996,200
2017	\$996,200
2016	\$936,051
2015	\$936,051
2014	\$936,051
2013	\$936,051
2012	\$936,051

NEIGHBORHOOD MEDIAN SALE PRICE

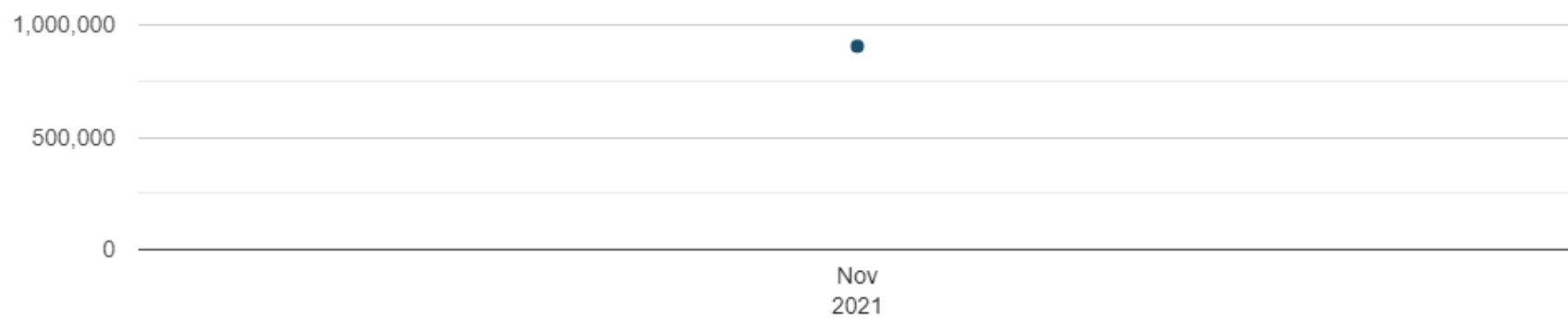

NEIGHBORHOOD - ASSESSED VALUES

Low
\$98,600
Median
\$1,537,100
High
\$62,232,100

NEIGHBORHOOD SALES BY TYPE



NEIGHBORHOOD - SALE PRICES

Biggest Sale
\$905,000
Average Home Price
\$905,000
Lowest Sale
\$905,000

Disclaimer

Orange County Assessor's Office makes every effort to produce the most accurate information possible. **No warranties, expressed or implied, are provided for the data herein, its use or interpretation.**

