

Orange County

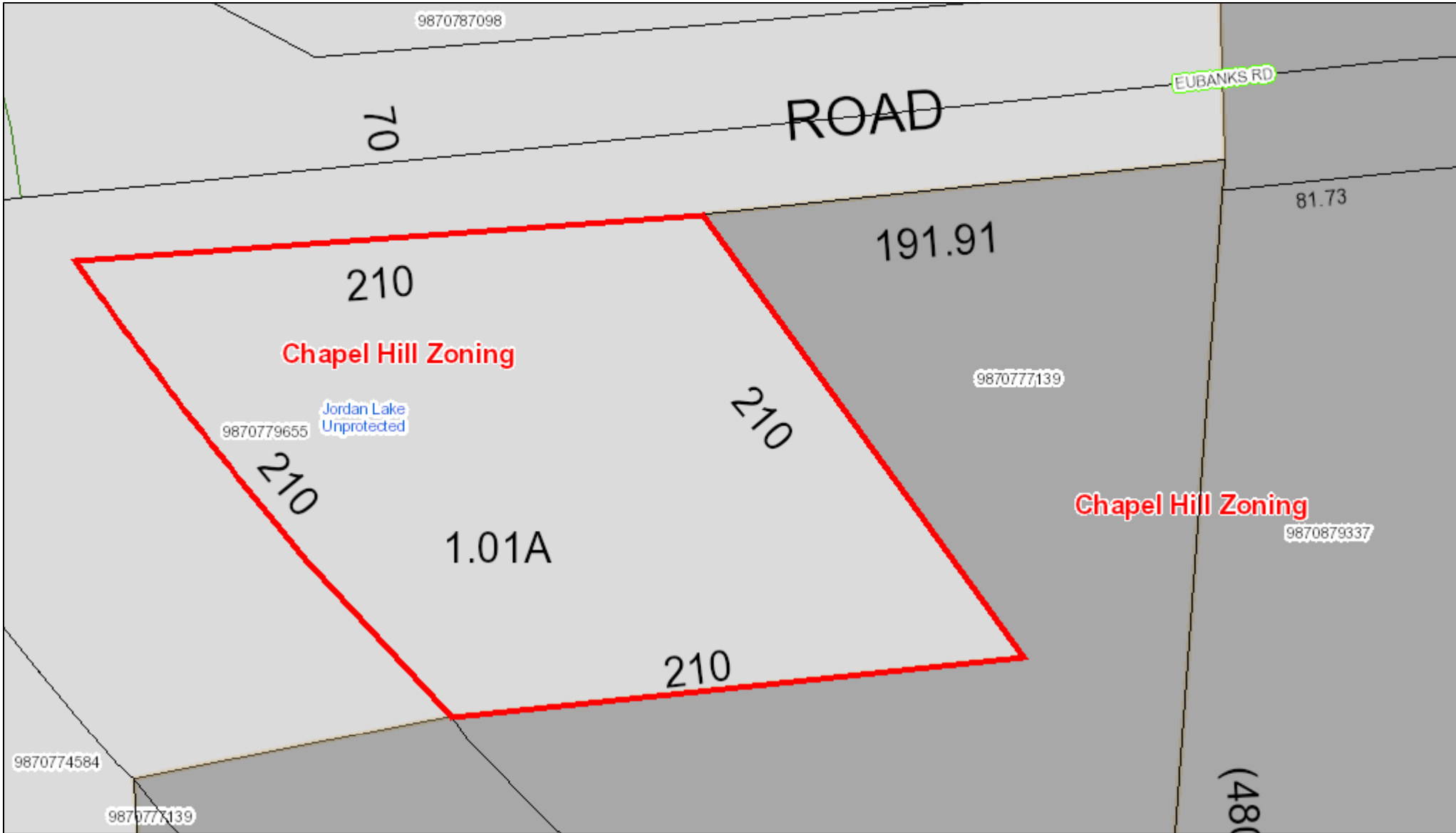

October 19, 2022 This map contains parcels prepared for the inventory of real property within Orange County, and is compiled from recorded deed, plats, and other public records and data. Users of this map are hereby notified that the aforementioned public primary information sources should be consulted for verification of the information contained on this map.

The county and its mapping companies assume no legal responsibility for the information on this map.

PIN: 9870779655

OWNER 1: ALTRIDGE GROUP LLC
 OWNER 2:
 ADDRESS 1: PO BOX 1198
 ADDRESS 2:
 CITY: Carrboro
 STATE, ZIP: NC 27510
 LEGAL DESC: SE INT SR 1727 & RAILROAD

SIZE: 1.01 A
 DEED REF: 4912/190
 RATECODE: 07
 TOWNSHIP: CHAPEL HILL
 BLDG SQFT: 9040
 YEAR BUILT: 1980

BUILDING COUNT: 2
 LAND VALUE: \$858,500
 BLDG_VALUE: \$116,100
 USE VALUE: \$0
 TOTAL VALUE: \$974,600
 DATE SOLD: 03/09/2010
 TAX STAMPS: 1100

