

Filed for registration AT 9:00 o'clock AM on July 29, 1980, and recorded in Plat Book 28, page 66, Chatham County Registry.

Fleet Barker Riddish
Register of Deeds

By *Robert W. Breyford, Deputy*
MAP of PITTSBORO
Scale 1"=200'
R.B. Clegg Sur.

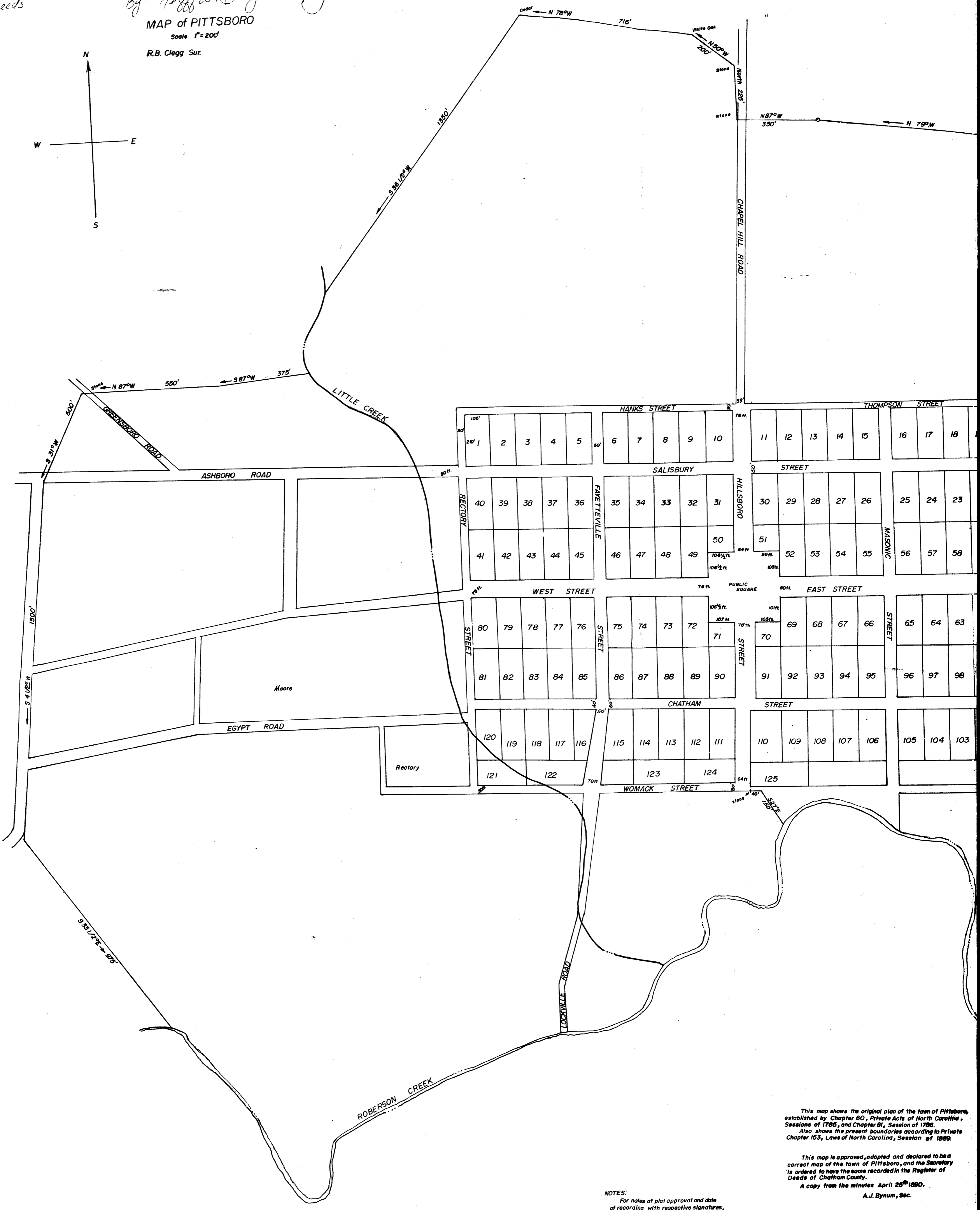
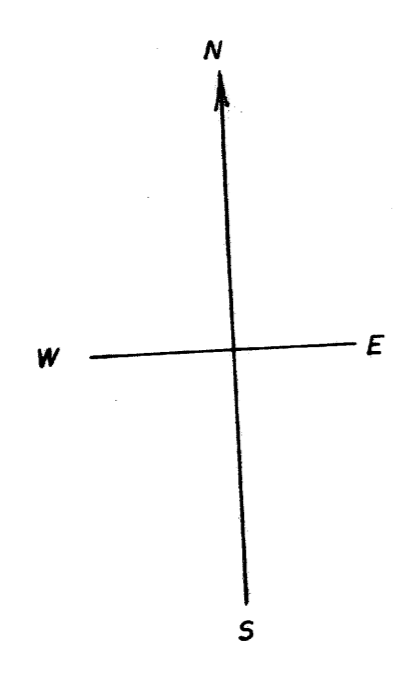

Courses of Streets

Hillsboro	North 3 1/2° East
W. Salisbury	North 85° West
E. Salisbury	South 86 1/2° East
West	North 86 1/2° West
East	South 86° East
Chatham	South 86 1/2° East
Masonic	North 3 1/2° East
Small	North 4° East
Fayetteville	North 3° East
Rectory	North 3° East
Thompson	South 86 1/2° East
South	South 4° West

NOTES:
For notes of plat approval and date of recording with respective signatures, see original plat.
This map traced from original and attempts to accurately depict the same.

This map shows the original plan of the town of Pittsboro, established by Chapter 80, Private Acts of North Carolina, Sessions of 1789, and Chapter 81, Session of 1788. Also shows the present boundaries according to Private Chapter 153, Laws of North Carolina, Session of 1889.

This map is approved, adapted and declared to be a correct map of the town of Pittsboro, and the Secretary is ordered to have the same recorded in the Register of Deeds of Chatham County.
A copy from the minutes April 25th 1890.
A.J. Bynum, Sec.

North Carolina
Chatham County
This is to certify that A.J. Bynum as secretary of the board of Commissioners of the town of Pittsboro personally appeared before me this day and acknowledged the due execution of the foregoing certificate. Let the Plat be recorded. April 28, 1890
S.M. Holt, Cfo.

SECTION 1

