

MCS Attached.  
Property Record Card

Durham County, NC  
Assessor of Property

Vacant Lot

Location Address  
15 SAINT ANDREWS CT

Owner Name

Owner Address

FULLER HOMES LLC

233 OAK LANE  
PALMYRA, PA  
17078

TO ↑  
Mauia Terhak

ASPER

12/2016 Bids Permit  
\$239,580 SGR

GENERAL PROPERTY INFORMATION

Parcel Ref No: 134630  
PIN: 0810-16-93-3811  
Account No: 8624110  
Tax District: CNTY-DRHM/CITY-DRHM  
Land Use Code: 311  
Land Use Desc: VAC RES/ LOT-SML TRACT  
Subdiv Code: 0801  
Subdiv Desc: ST ANDREWS CMN SEC 2  
Neighborhood: 080RG

Legal Description: ST ANDREWS CMN/SEC:02/LT# 04  
Deed Book & Page: 8080 / 138  
Plat Book & Page: 000115 / 000001  
Last Sale Date: Dec-02-2016  
Last Sale Price: \$75,000 ✓  
Property Tax Appraisal: \$48,440 \*

\* The appraised value is the estimated value as of the last general reappraisal, effective January 1, 2016

RS-10 Zone

Year Built: 0  
Built Use / Style:  
Current Use:  
\*Percent Complete: 0%  
Heated Area (S/F): 0  
\*\* Bathroom(s): 0 Full Bath(s) 0 Half Bath(s)  
\*\* Bedroom(s): 0  
Fireplace (Y/N): N  
Basement (Y/N): N  
Attached Garage (Y/N): N  
Multiple Improvements: 0

Land Market Value: \$48,440  
Land Present Use Value: \$48,440  
Land Total Assessed Value: \$48,440  
Building Value: \$-  
Map Acres: 0.384

Appraised Improvement Values  
\$-  
Appraised Value as of January 1, 2016

\* Note - As of January 1

\*\* Note - Bedroom(s), shown for description only

Data Disclaimer: All data shown here is from other primary data sources and is public information. Users of the data are hereby notified that the aforementioned public information sources should be consulted for verification of the information contained on this website. While efforts have been made to use the most current and accurate data, Durham County, NC and data providers assume no legal responsibility for the use of the data contained herein.

Please direct any questions or comments about the data displayed here to tax\_assessor@dconc.gov (mailto:tax\_assessor@dconc.gov)

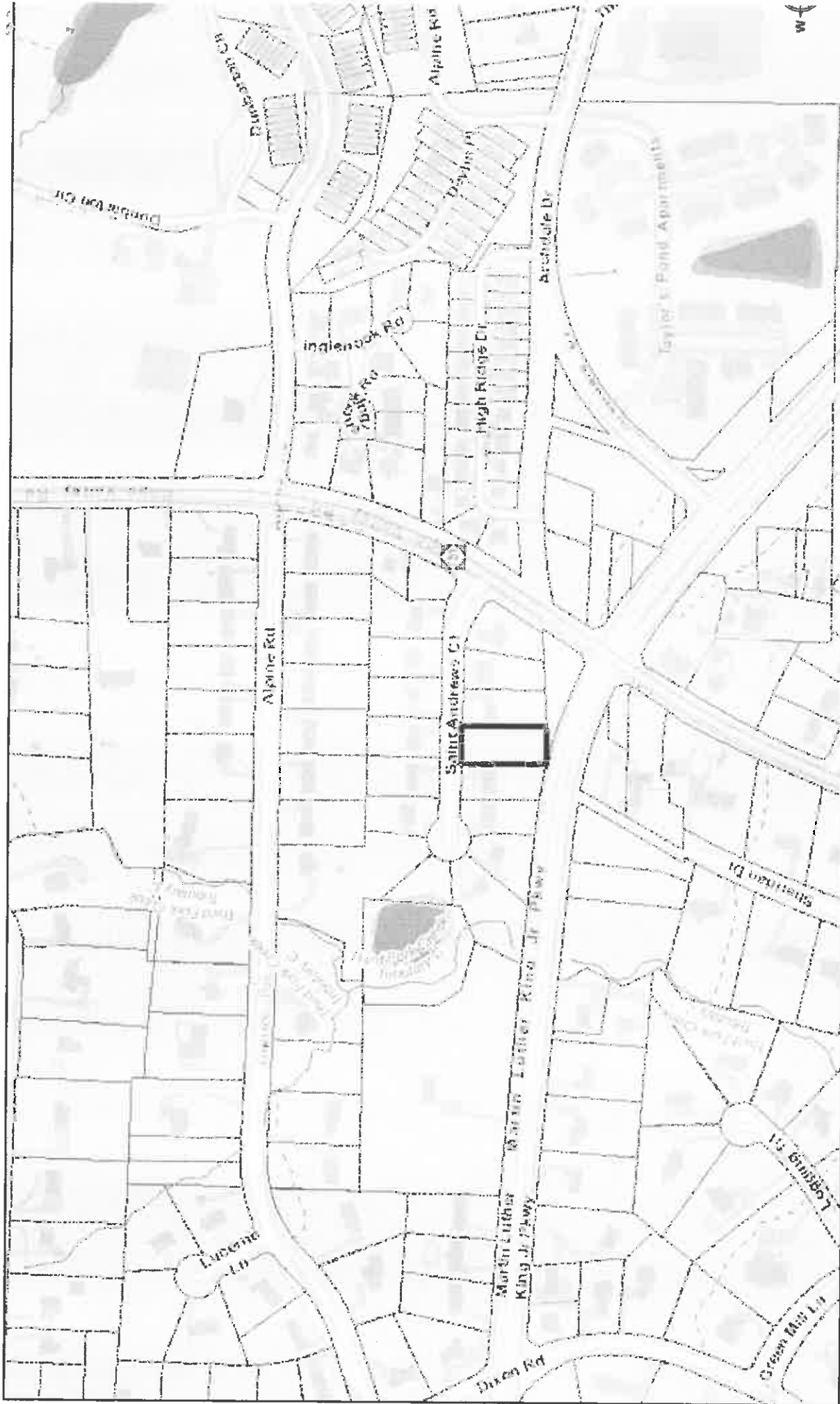

December 19, 2016

1:4,514

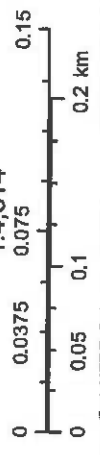

Sources: Esri, HERE, DeLorme, USGS, Intermap, INCREMENT P, Japan, METI, Esri China (Hong Kong), Esri Korea, Esri (Thailand), INGOC, © OpenStreetMap contributors, and the GIS User Community

Information depicted herein is for reference purposes only and is compiled from the best available sources. The City of Durham/Durham County assumes no responsibility for errors arising from use or misuse.



**15 St Andrews Court**  
 Durham, NC 27707

**Lot #: 15**  
**SubArea: 106/A**

**Road Frontage**  
**Property Leased No**  
**Lease Expires**

**Subdivision:** St Andrews Commons  
**Seller Name:** Maria Tershak

**Neighborhood:**  
**SP:** \$75,000  
**Est Closing Dt:** 12/2/2016

**School Information**

<b>ElemSch1</b> Durham - Hope Valley	<b>ElemSch2</b>
<b>MidSch1</b> Durham - Githens	<b>MidSch2</b>
<b>HighSch1</b> Durham - Jordan	<b>HighSch2</b>

**Directions** From I40West take exit towards NC-54. Turn left onto Hwy NC55 and continue on NC55. Turn left onto Martin Luther King Parkway. Turn right onto Hope Valley Road, NC 751. Take the 1st left onto St. Andrews Ct. 15 Saint Andrews Ct. is on the left.

**Remarks** Build you dream home in an already established neighborhood. Extremely convenient to Duke and Downtown Durham. Flat lot with mature trees. A real must see!

**General Information**

<b>Approximate Acres</b> 0.384	<b>Wooded Acres</b>	<b>Cleared Acres</b>	<b>Price per Acre</b>
<b>Perk Test</b> No	<b>Perk Test Date</b>	<b># of Beds Yielded</b>	<b>Water/Sewer Fee</b>
<b>Deed Restrictions</b> No		<b>Lot Dimensions</b>	
<b>Restrictive Covenant Rmks</b>			

**Financing & Taxes**

<b>Tax Value</b> \$48,440.00	<b>Tax Rate</b> 1.30100	<b>Tax Map/Blk/Prd/Lot</b>
<b>Zoning</b>	<b>Total HOA Dues:</b> /	<b>PIN #</b> 134630
<b>Legal Description</b> ST ANDREWS CMN/SEC:02/LT#04		<b>Inside City</b> Yes
<b>Financial Comments</b> Please provide proof of funds with offer.		

**Features**

<b>Property Type</b> Vacant	<b>Topography</b> Level
<b>Location</b>	<b>Road Description</b> Street Paved
<b>Sales Options</b> No Divide	<b>Restrictions</b> No Mobile Homes, Residential Covenants
<b>Utilities</b> Cable Available, Electricity Available, Gas Available, Telephone Available	<b>Sewer/Septic</b> Public Sewer
<b>Documents Available</b> Subdivision Plan, Survey	<b>Improvements</b> Curb/Gutter, Partially Fenced
<b>Road Frontage Description</b> Has Frontage	
<b>Vegetation</b> Hardwoods	
<b>Water Supply</b> City On Site	
<b>Transportation</b> Airport 11-15 M	

**Showing Instructions**

<b>List Agent - License ID</b> 238227	<b>Showing Instructions</b> Vacant
<b>List Agent - Agent Name and Phone</b> Jennifer Patterson - PrfPh: 919-824-7981	<b>Appointment Phone</b> 919-595-8989
<b>List Agent - Firm License</b> C17886	<b>Possession</b> At Time Of Closing
<b>Listing Office - Office Name and Phone</b> Fonville Morisey/Chapel Hill Sales Office - OFC: 919-942-4822	<b>CDOM</b> 3
	<b>DOM</b> 3
	<b>Prospect Exempt</b>
<b>Co-Agent - Agent Name and Phone</b>	

**Commission to Buyer Agent** 5 %  
**Commission to Sub Agent** 5 %  
**Variable Rate** No

**Waterfront**

**Waterfront Access**  
**Water Body Name**

**Waterfront Type**  
**Approx Ft of Wtr Frontage**

**Comparable Information**

**Selling Agent - License ID** 183966  
**Selling Agent - Agent Name and Phone** Kara Pittman - PrfPh: 919-260-0488  
**Selling Office - Firm License** C9798  
**Selling Office - Office Name and Phone** Terra Nova Global Properties - OFC: 919-929-2005

**Terms of Sale** CASH  
**Sold Price** \$75,000  
**Closing Date** 12/2/2016

**Pending Date:** 10/16/2016

**Selling Info:**

**Financial Concessions (CC):** 0

**Other Concessions:**

**Special Circumstances:** No Special Circumstances

**Agent Only Remarks**

# Gallery Brochure

**15 St Andrews Court**

**Durham**

**,27707**

**\$75,000**

**LAND / Vacant**

**MLS #** 2094362  
**Status** CLOSED  
**County** Durham  
**SubArea** 106 - Southwest Durham/A  
**Subdivision** St Andrews Commons  
**Neighborhood**  
**Inside City** Yes  
**Road Frontage**  
**Approximate Acres** 0.384  
**Approx Lot SqFt**  
**Cleared Acres**  
**Wooded Acres**  
**Lot Dimensions**  
**Lot Number** 15

**Location**  
**Elementary School 1** Durham - Hope Valley  
**Middle School 1** Durham - Githens  
**High School 1** Durham - Jordan  
**Perk Test** No  
**Perk Test Date**  
**Water/Sewer Fee**  
**# of Beds Yielded**  
**PIN #** 134630  
**Tax Map/Blk/Prcl/Lot**  
**Zoning**  
**Topography** Level  
**Improvements** Curb/Gutter, Partially



**Remarks** Build you dream home in an already established neighborhood. Extremely convenient to Duke and Downtown Durham. Flat lot with mature trees. A real must see!

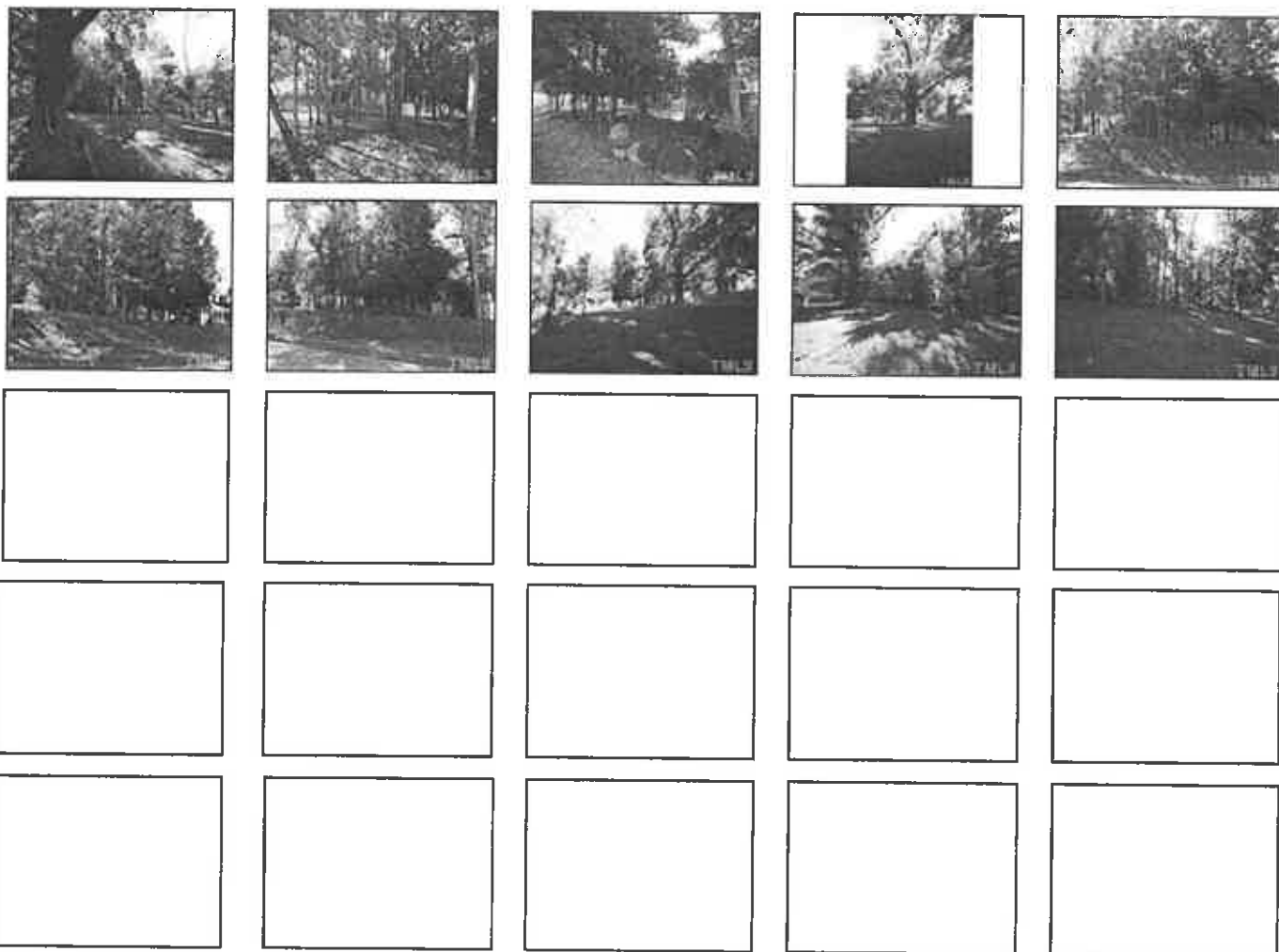

Robert Sprouse  
 PrfPh: 919-493-0395  
 robert@pickett-sprouse.com  
 www.pickett-sprouse.com

