

Orange County North Carolina

198684

**MAILING ADDRESS**

MORRIS LEWIS S JR, MORRIS MARGARET M  
303 LANCASTER DR  
CHAPEL HILL NC 27517

Total Assessed Value

**\$238,200**

**KEY INFORMATION**

Tax Year	<b>2021</b>		
Parcel ID	<b>9789917702</b>	Township	<b>7 - CHAPEL HILL</b>
Land Size	<b>0.54</b>	Land Units	<b>AC</b>
Rate Code	<b>22</b>		
District Codes	<b>G2 Chapel Hill, G0 County, CH CHSchoolDst.</b>		
Property LUC	<b>Residential- Improved</b>		
Neighborhood	<b>7176 - 7EFRANKLIN2</b>		
Legal Description	<b>56 HILLVIEW P5/121</b>		
Exempt Type	<b>-</b>		

**APPRAISAL DETAILS**

Total Land	<b>\$136,500</b>
Ag Credit	<b>-</b>
Land	<b>\$136,500</b>
Building	<b>\$101,700</b>
Yard Items	<b>\$0</b>
Market Total	<b>\$238,200</b>
Total Assessed	<b>\$238,200</b>

**RESIDENTIAL**

<b>BUILDING (1)</b>					
Type	<b>TTF Fam</b>	Total Value	<b>\$101,700</b>	Finished Sq Ft	<b>1,664 sf</b>
Style	<b>-</b>	Quality	<b>Grade C-15</b>	Condition	<b>Average</b>
Year Built	<b>1947</b>	Exterior Walls	<b>Frame</b>	Full Bath	<b>2</b>
Roof Cover	<b>Shingle</b>	Half Bath	<b>0</b>	HVAC	<b>Flr/WI Furn</b>
Bedrooms	<b>4</b>	Garage Type	<b>-</b>		

**MISC IMPROVEMENTS**

<b>IMPROVEMENT TYPE</b>	<b>UNITS/SQ FT</b>	<b>EST YEAR BUILT</b>	<b>APPRAISED VALUE</b>
No items to display			

**SALES**

SALE DATE	SALE PRICE	DEED BOOK	DEED PAGE	INSTRUMENT TYPE	GRANTOR
03/22/1995	\$96,000	1335	384		TATE
03/22/1995	\$96,000	1335	384		TATE WILLIAM F JR
07/06/1994	\$0	1265	525		TATE
05/31/1983	\$31,500	420	8		MITCHELL
10/01/1976	\$0	266	1237		-

## YARD ITEMS

DESCRIPTION	TOTAL UNITS	YEAR BUILT	LENGTH	WIDTH	HEIGHT
No items to display					

## LAND

UNIT / SOIL TYPE	DESCRIPTION	USE CODE	ACRES / LOTS	VALUE
LOT	Lot	SITE	1	\$136,500

## VALUE HISTORY

YEAR	TOTAL MARKET VALUE
2020	\$223,800
2019	\$223,800
2018	\$223,800
2017	\$223,800
2016	\$242,570
2015	\$242,570
2014	\$242,570
2013	\$242,570
2012	\$242,570
2011	\$242,570



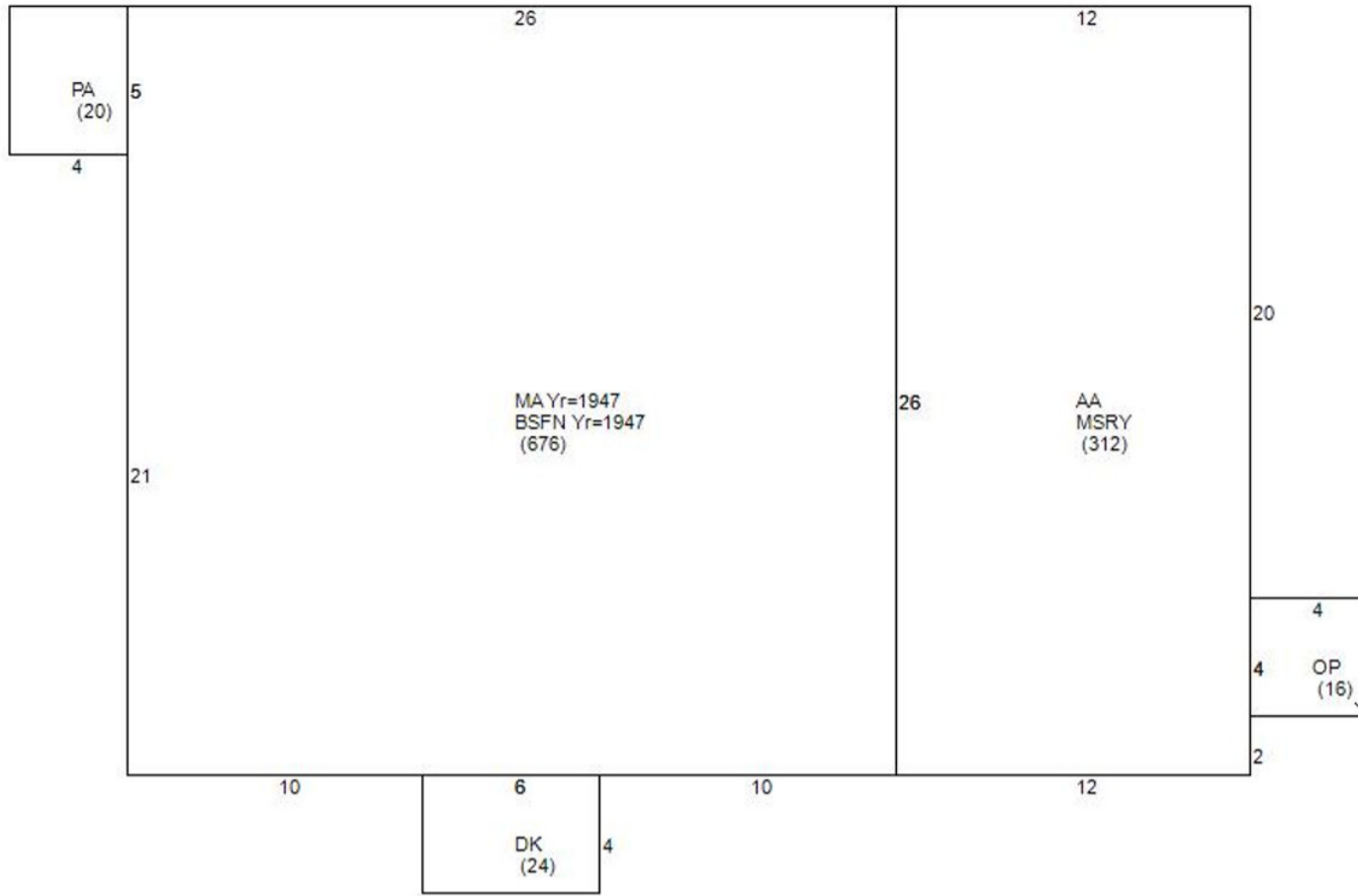

**Disclaimer**

Orange County Assessor's Office makes every effort to produce the most accurate information possible. **No warranties, expressed or implied, are provided for the data herein, its use or interpretation.**