

Durham County, NC
Assessor of Property

Property Record Card

Owner Name

P&G CONSTRUCTION COMPANY INC

to ↑
Lannie England d.w.f.

Owner Address

1216 HWY 15
CREEDMOOR, NC
27522

Location Address

1205 N ROXBORO ST

Vacant lot.

NO MCLs

*BlDG. Permit 10-16
138,996 SFR.*

GENERAL PROPERTY INFORMATION

Parcel Ref No: 110031
PIN: 0832-17-10-5365
Account No: 8588865
Tax District: CNTY-DRHM/CITY-DRHM
Land Use Code: 311
Land Use Desc: VAC RES/ LOT-SML TRACT
Subdiv Code: 0000
Subdiv Desc: N/A - NO SUBDIVISION
Neighborhood: 070RI

Legal Description: PROP-OBRIANT HERBERT C
Deed Book & Page: 7269 / 85
Plat Book & Page: 000013 / 000119
Last Sale Date: May-20-2013
Last Sale Price: \$25,000 ✓
Property Tax Appraisal: \$45,112 *



110031 01/29/2015

* The appraised value is the estimated value as of the last general reappraisal, effective January 1, 2016

RU-S(2)3M.

Year Built: 0
Built Use / Style:
Current Use:
*Percent Complete: 0%
Heated Area (S/F): 0
** Bathroom(s): 0 Full Bath(s) 0 Half Bath(s)
** Bedroom(s): 0
Fireplace (Y/N): N
Basement (Y/N): N
Attached Garage (Y/N): N
Multiple Improvements: 0

Land Market Value: \$45,112
Land Present Use Value: \$45,112
Land Total Assessed Value: \$45,112
Building Value: \$-
Map Acres: 0.203

Appraised Improvement Values
\$-
Appraised Value as of January 1, 2016

* Note - As of January 1

** Note - Bedroom(s), shown for description only

Data Disclaimer: All data shown here is from other primary data sources and is public information. Users of the data are hereby notified that the aforementioned public information sources should be consulted for verification of the information contained on this website. While efforts have been made to use the most current and accurate data, Durham County, NC and data providers assume no legal responsibility for the use of the data contained herein.

Please direct any questions or comments about the data displayed here to tax_assessor@dconnc.gov (mailto:tax_assessor@dconnc.gov)

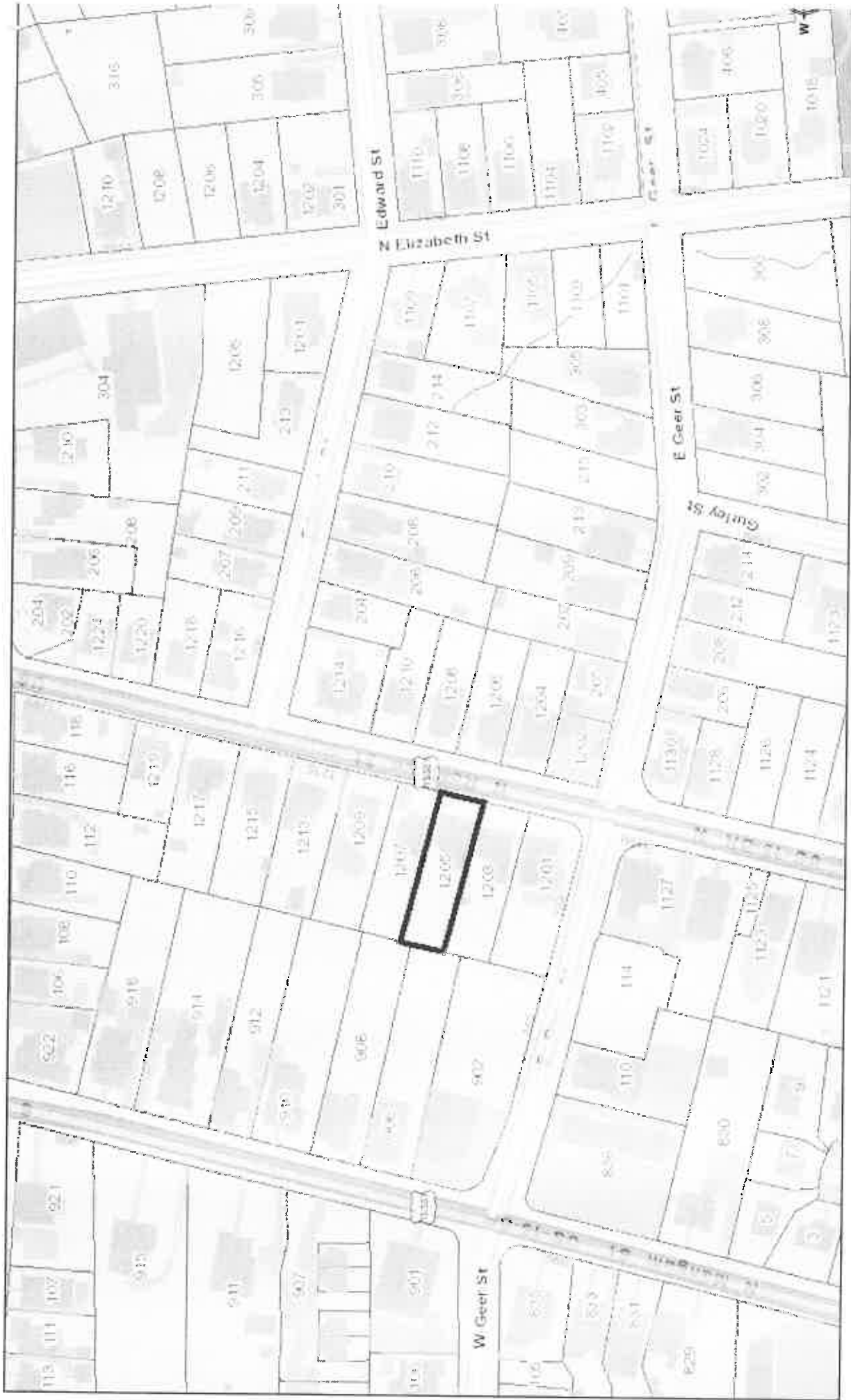

October 24, 2016



Source: Esri, HERE, DeLorme, USGS, InMap, INCREMENT P, Japen, METI, Esri China (Hong Kong), Esri Korea, Esri (Thailand), NGCC, © OpenStreetMap contributors, and the GIS User Community