

Orange County North Carolina

312243
120 US 70 E

MAILING ADDRESS
ASHWORTH FAMILY TRUST ETAL,
ASHWORTH MURRELL H
5207 PINE WAY
DURHAM NC 27712

Total Assessed Value
\$235,800

KEY INFORMATION

Tax Year	2021		
Parcel ID	9875003028	Township	4 - HILLSBOROUGH
Land Size	0.16	Land Units	AC
Rate Code	23		
District Codes	G3 Hillsborough, G0 County		
Property LUC	Commercial, Retail, Shopping Centers, Restaurants,		
Neighborhood	H001 - 4WSTONEOLDM		
Legal Description	2 FRED CATES P14/155		
Exempt Type	-		

APPRAISAL DETAILS

Total Land	\$41,300
Ag Credit	-
Land	\$41,300
Building	\$191,700
Yard Items	\$2,800
Market Total	\$235,800
Total Assessed	\$235,800

RESIDENTIAL

BUILDING (1)					
Type	Retail Store	Total Value	\$191,700	Finished Sq Ft	2,541 sf
Style	-	Quality	Grade C	Condition	Average
Year Built	1962	Exterior Walls		Full Bath	0
Roof Cover		Half Bath	0	HVAC	
Bedrooms	-	Garage Type	-		

MISC IMPROVEMENTS

IMPROVEMENT TYPE	UNITS/SQ FT	EST YEAR BUILT	APPRAISED VALUE
PAVING	3300	1990	\$2,800

SALES

SALE DATE	SALE PRICE	DEED BOOK	DEED PAGE	INSTRUMENT TYPE	GRANTOR
04/07/2009	\$0	4706	321		ASHWORTH
02/01/2006	\$50,000	3962	515		ASHWORTH
09/17/1993	\$0	1157	467		ASHWORTH
01/28/1986	\$0	-	-		ASHWORTH

YARD ITEMS

DESCRIPTION	TOTAL UNITS	YEAR BUILT	LENGTH	WIDTH	HEIGHT
No items to display					

LAND

UNIT / SOIL TYPE	DESCRIPTION	USE CODE	ACRES / LOTS	VALUE
SF	Square Ft	PRIMARY	6890	\$41,300

VALUE HISTORY

YEAR	TOTAL MARKET VALUE
2020	\$208,400
2019	\$208,400
2018	\$208,400
2017	\$208,400
2016	\$111,053
2015	\$111,053
2014	\$111,053
2013	\$111,053
2012	\$111,053
2011	\$111,053



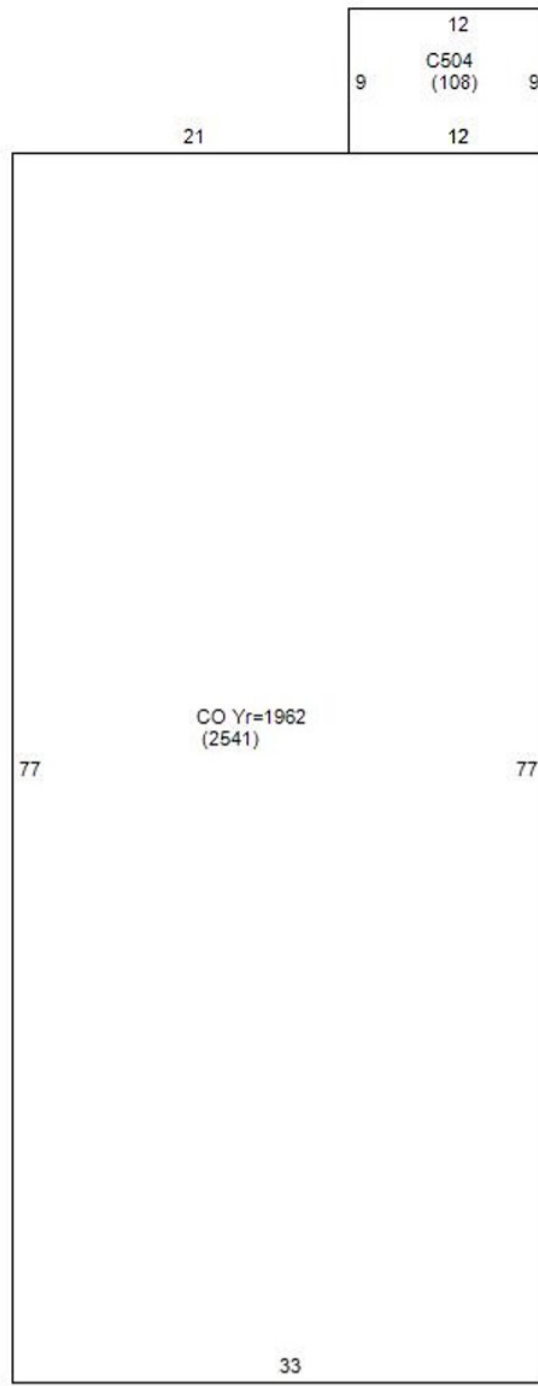

Disclaimer

Orange County Assessor's Office makes every effort to produce the most accurate information possible. **No warranties, expressed or implied, are provided for the data herein, its use or interpretation.**