

Orange County North Carolina

22129

MAILING ADDRESS GWYN OWEN JR
901 WILLOW DR STE 2
CHAPEL HILL NC 27514

Total Assessed Value
\$2,445,300

KEY INFORMATION

Tax Year	2021		
Parcel ID	9788371250	Township	7 - CHAPEL HILL
Land Size	0.32	Land Units	AC
Rate Code	32		
District Codes	DR DwnTwn.Rev, G0 County, CH CHSchoolDst., G2 Chapel Hill		
Property LUC	Commercial, Retail, Shopping Centers, Restaurants,		
Neighborhood	CH02 - 7WFRANKLIN		
Legal Description	W. FRANKLIN STREET		
Exempt Type	-		

APPRAISAL DETAILS

Total Land	\$1,946,000
Ag Credit	-
Land	\$1,946,000
Building	\$495,000
Yard Items	\$4,300
Market Total	\$2,445,300
Total Assessed	\$2,445,300

RESIDENTIAL

BUILDING (1)					
Type	Retail Store	Total Value	\$495,000	Finished Sq Ft	6,585 sf
Style	-	Quality	Grade B-10	Condition	Average
Year Built	1937	Exterior Walls		Full Bath	0
Roof Cover		Half Bath	0	HVAC	
Bedrooms	-	Garage Type	-		

MISC IMPROVEMENTS

IMPROVEMENT TYPE	UNITS/SQ FT	EST YEAR BUILT	APPRAISED VALUE
PAVING A 4.2	1	-	\$4,300

SALES

SALE DATE	SALE PRICE	DEED BOOK	DEED PAGE	INSTRUMENT TYPE	GRANTOR
07/10/2021	-	6731	1810		-
07/01/2021	-	6731	1807		-
09/15/1986	\$0	602	281		-

YARD ITEMS

DESCRIPTION	TOTAL UNITS	YEAR BUILT	LENGTH	WIDTH	HEIGHT
No items to display					

LAND

UNIT / SOIL TYPE	DESCRIPTION	USE CODE	ACRES / LOTS	VALUE
SF	Square Ft	PRIMARY	13900	\$1,946,000

VALUE HISTORY

YEAR	TOTAL MARKET VALUE
2020	\$2,342,600
2019	\$2,342,600
2018	\$2,342,600
2017	\$2,342,600
2016	\$1,571,645
2015	\$1,571,645
2014	\$1,571,645
2013	\$1,571,645
2012	\$1,571,645
2011	\$1,571,645

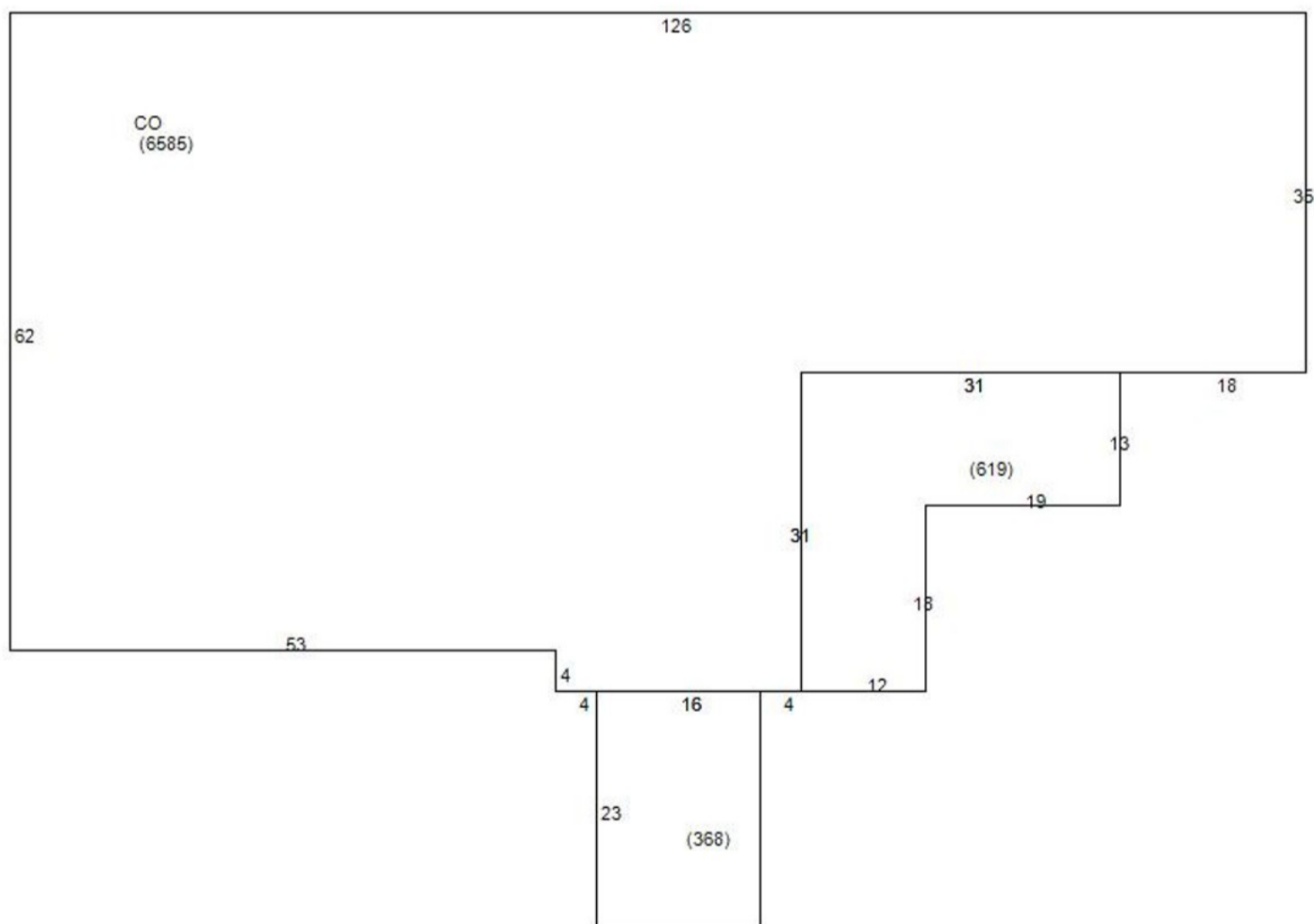

Disclaimer

Orange County Assessor's Office makes every effort to produce the most accurate information possible. **No warranties, expressed or implied, are provided for the data herein, its use or interpretation.**